

This form is intended to fulfill the requirements of Chapter A-E 7.08 (3)(a) thru (i) U.S. Public Land Survey Monument Location Record, Wisconsin Administrative Code. Use the reverse side of form for continuation.

U.S. PUBLIC LAND SURVEY MONUMENT LOCATION RECORD

Recorders Data

USPLS CORNER: NW SECTION SECTION: 5 TOWNSHIP: 37 NORTH RANGE: 9 EAST

NAME OF WATERWAY FOR M.C. CORNER: N/A SECTION LINE: N/A

(CITY)(VILLAGE)(TOWN) OF: PINE LAKE COUNTY OF: ONEIDA

Description of monument found or placed and all other evidence used as the basis for monument location; including monuments and related measurements required if the corner location was reestablished by lost corner proportionate methods. Also indicate name of original surveyor, original survey date and the corner monument, bearing trees, witness or other reference monuments established; including measured bearing and distance ties, from available records.

Found old 2" dia. by 60" iron pipe with 4" square steel plate Ripco stamped cap, painted yellow and only 4" into ground, near NE corner of existing deer blind, which did not fit record BTs found; however, I did find a plain pipe core hole with rust staining in the ground, under the floor covering in the SE corner of deer blind, which fit record BT ties, so I set a standard 2" dia. by 30" long aluminum pipe monument with stamped Oneida County cap flush with grade in the found pipe core hole, obviously left by the older Ripco capped iron pipe monument before it had been disturbed. In July 1859, Hiram C. Fellows/GLO set a wood post as the original corner and marked OBTs: a 12" Bw N46°W 38 links, a 12" Cedar N56°E 9 links, a 12" Cedar S75°E 11 links and a 14" Cedar S57°W 10 links, all now obliterated. In September 1941, V.M. Maine per his Book 1941 Page 112, notes he identified corner from stump of one OBT, a 12" Hem S22°E 24 links with an iron marked slab beside it (? no SE Hem OBT was noted by Fellows in 1859 per above notes) and also the stool? of a 7" Maple S68°W 11 links; and he noted new BTs: an 8" Py N62°W 16.5 links, an 8" Black Oak N50°E 27 links and a 7" Py S28°W 28 and 3/10ths links, all of which are now obliterated; I am not certain if such record notes by Maine truly apply to this corner? In February 1955, Norman Loftus/RLS 259 notes on Page 105 of Ripco Book 1 that he found a square and scribed wood marker post with a 1.5" dia. iron pipe at this corner; that he found no previous BTs and that he blazed trees around the corner. In June 1980, during a BLM Resurvey, Michael J. Avery notes the 2" iron pipe at this corner with 4" square steel Ripco stamped cap 24" above grade and noted older BTs with healed face blazes: a 6" Sb N54°E 15 links, now a low rotted stump with stub trunk fallen to NE with plain face blaze, scribing and Ripco location tag nailed thereto, and an 8" Sb S22°W 29 links, found OK with shut but plain blaze scars, Ripco tag and 60d spike in lower right face. I also found a dead 4" Sb with lower scribed blaze onto the East side of a live 8" Sb S30°W 13.0', but not of record. This recovery completed August 31, 1999; there were no direct witnesses.

Plan view map of monument location with bearing and distance ties to a minimum of four(4) described witness or reference monuments of concrete, natural stone, iron, live bearing trees or equivalent material. If applicable, also show a minimum of two(2) bearing and distance ties to any other monument found and not accepted; including the bearing and distance from the accepted monument.

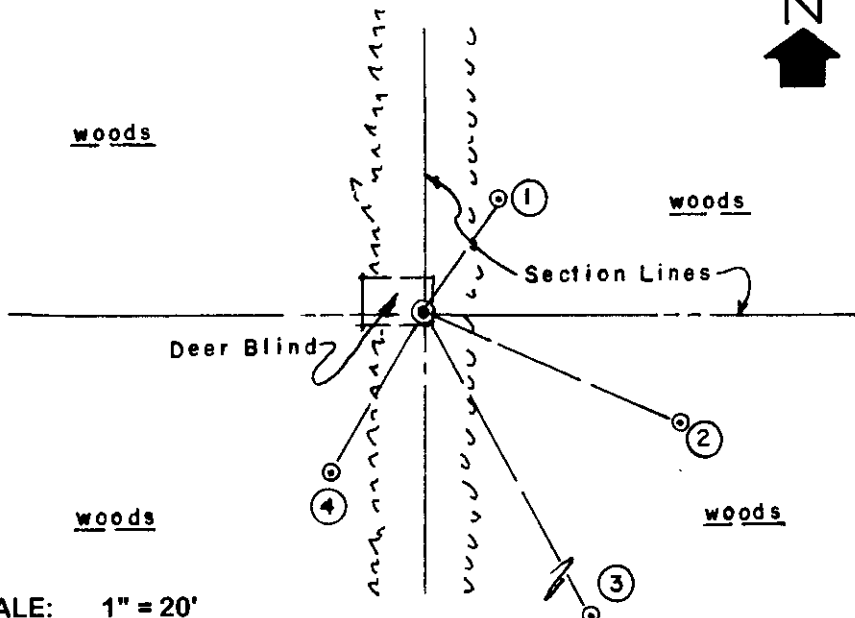

WITNESS MONUMENT TIES:

- ① New BT 8" Sb with upper & lower blazes and standard BT sign N33°E 13.80'.
- ② New BT 6" Sb S67°E 28.56'.
- ③ New BT 6" Sb S30°E 39.22'.
- ④ Old BT 10" Sb with upper & lower blazes shut but plain and 60d spike in lower right face S29°W 18.90'.

I set a standard white poly 'T' marker post and left old 2" iron pipe with Ripco cap flat on grade next to the old NE BT stump and painted all BT blazes blaze orange. Corner falls near center of old N/S logging road.

SCALE: 1" = 20'

Unless otherwise indicated, all bearing tree ties are to a .25" dia. by 2.5" long PK nail with a 1.25" dia. steel washer driven into unblazed right face and a .25" dia. by 2.5" long PK nail with a 2" dia. steel washer stamped BT is also driven into unblazed face of bearing tree at DBH; the basis for measured bearings is by compass to nearest degree and all tie distances are measured horizontal by steel tape corrected to nearest 1/100th feet at standard temperature of 68° F.

RLS SEAL:

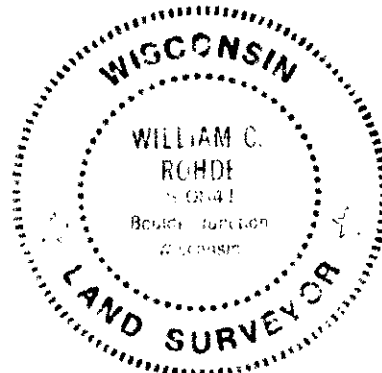

LAND SURVEYOR CERTIFICATE:

I, William C. Rohde, hereby certify that I am duly licensed as a Professional Land Surveyor in the State of Wisconsin; that this USPLS monument location was determined by me and/or under my direct supervision and control; and that this U.S. Public Land Survey Monument Location Record is true and correct to the best of my knowledge and belief.

Signed *William C. Rohde*
William C. Rohde RLS 841

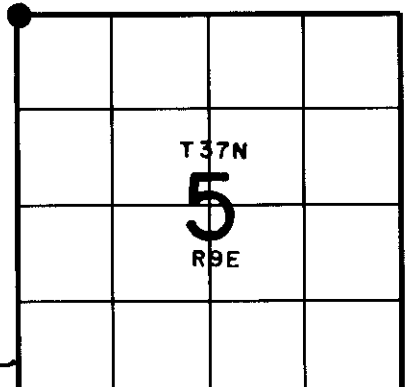

SECTION LOCATION MAP

INDEX NO. A 5

3809310000