

CERTIFIED LAND CORNER RESTORATION

Index No. A-14

State of Wisconsin }
County of Oneida } ss.

I Philip T. Hansen, do hereby certify that on the 23rd day of September, 1976, I found evidence of the W 1/16 corner of Sec. 3 & 34 Township 37 & 38, North, Range 9 East, Fourth Principal Meridian, as described hereon; and that from this evidence I established a new monument and accessories as described hereon to perpetuate the original location of this corner.

Resident witnesses:

Jim Claflin

Herb Wagoner

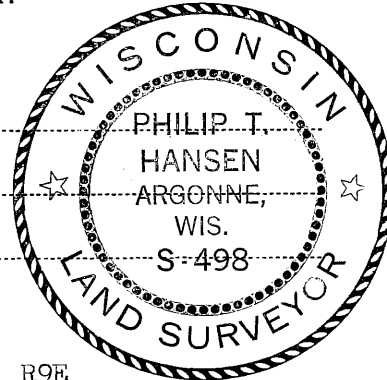

FORM 965 H. C. MILLER CO., MILWAUKEE

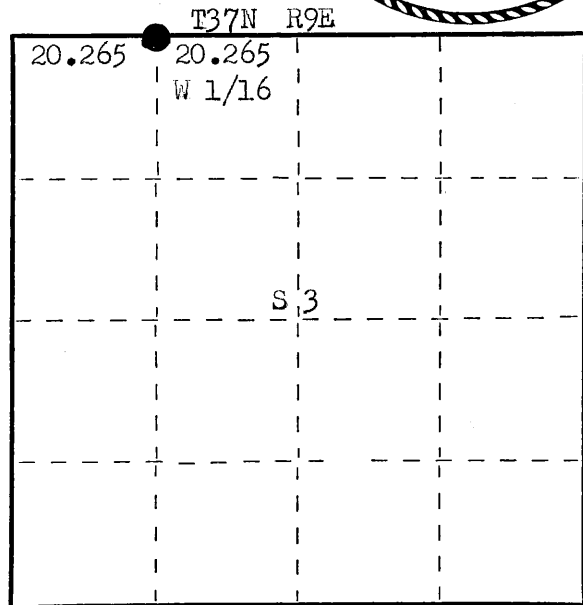

○ = Corner monument restored.

History of original corner establishment:

Original Corner established by D.H. Vaughan, County Surveyor, in 1893, marked BT - Tamarack 7" S 45¹/₂° E 20-3/4 links.
Corner re-established by N. Loftus, Ripco Surveyor, in 1958. Set new iron pipe and marked NBTs - Tamarack 5" N 29° E 24 links and Black Spruce 5" S 35° E 56¹/₄ links.

Description of corner evidence found:

Recovered 1" OD iron pipe with 2" square brass cap. Cap stamped:
Recovered Black Spruce 5" (8") S 35° E 56.2 links, scribing not legible.
Tamarack 5" N 29° E 24.0 links - only stump remains.

T38N R9E
W 1/16 S 34
S 3
T37N R9E
RIPCO

Description of monument and accessories I established to perpetuate the original location of this corner.
As monument was recovered in good condition and was firm in ground, it was left in place.
Monument projects 12" above ground.
NBT - Tamarack 8" N 70° E 19.5 links, scribed 1/16 BT.

Dated at Rhineland, Wis., this 4th day of November, 1976

Signature Philip T. Hansen Title Registered Land Surveyor Registration No. S-498
(County Surveyor, Registered Land Surveyor, or other duly authorized official)

Office of Register of Deeds, County of Oneida, I hereby certify that the within instrument was filed in this office for record on the 2nd day of December, 1976 at 9:30 o'clock a M.

Doris Terage Kuehn
(Register of Deeds)

By..... Deputy

3809340030