

CERTIFIED LAND CORNER RESTORATION

Index No. **Y-17**

State of Wisconsin

County of Oneida } ss.

I Philip T. Hansen do hereby certify that on the 25th day of August, 1977, I found evidence of the S 1/16 corner of Section 34, & 35 Township 38 North, Range 9 East, Fourth Principal Meridian, as described hereon; and that from this evidence I established a new monument and accessories as described hereon to perpetuate the original location of this corner.

Resident witnesses:
Jim Claflin
Herb Hagoner

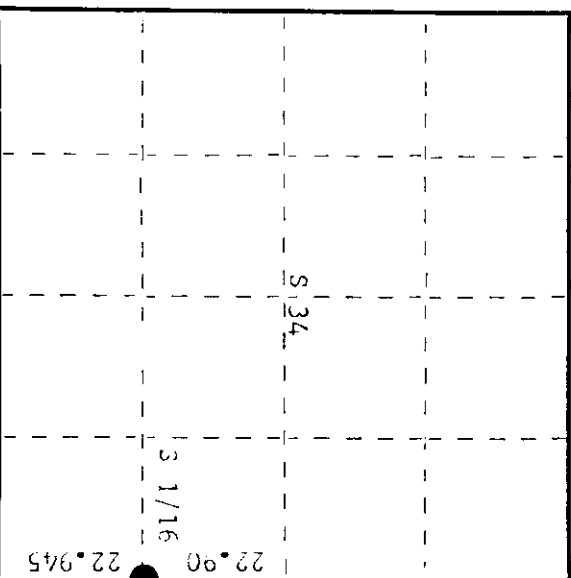
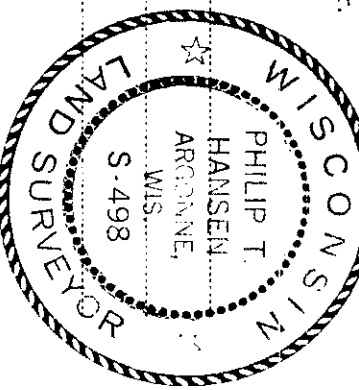

○ = Corner monument restored.

History of original corner establishment:

Corner established by F.R. Wincentsen. Recovered by N. Loftus, Ripco Surveyor, in 1960. Ran random line N 70° 21' E and at 22.945 chains fell 4-3/4 links east of S 1/16 corner. Set new iron pipe.

Description of corner evidence found:

Recovered 3/4" iron pipe with 2" square brass cap projecting 12" above ground. Monument was in good condition. Cap stamped: Also recovered old cedar post laying beside it. Also a 1 1/2" iron pipe driven in ground beside Ripco's monument. Recovered CRTs - Black Spruce 100 yards, 70.3 links, scribing partially legible. Oak saw pipe, 63.0 links, scribing grown over.

Description of monument and accessories I established to perpetuate the original location of this corner. Monument left in place as recovered. Prescribed top blaze on Oak post 1/16. No additional accessories established.

Dated at Rhineland, Wis., this 9th day of September, 1977.

Signature *Philip T. Hansen* Title Registered Land Surveyor Registration No. S-498
County Surveyor, Registered Land Surveyor, or other duly authorized official

Office of Register of Deeds, County of Oneida
Instrument was filed in this office for record on the 15th day of September, 1977
at 2:00 o'clock P.M. hereby certify that the within

David George Keehn
(Register of Deeds)

By Deputy