

State of Wisconsin

County of Oneida } ss.

I Philip T. Hansen, do hereby certify that on the 12th day of August, 1977, I found evidence of the C 1/4 corner of Section 34 Township 38 North, Range 9 East, Fourth Principal Meridian, as described hereon; and that from this evidence I established a new monument and accessories as described hereon to perpetuate the original location of this corner.

Resident witnesses: Jim Claflin Herb Wagoner

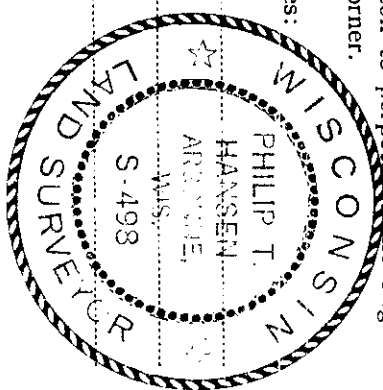

T39P R9F

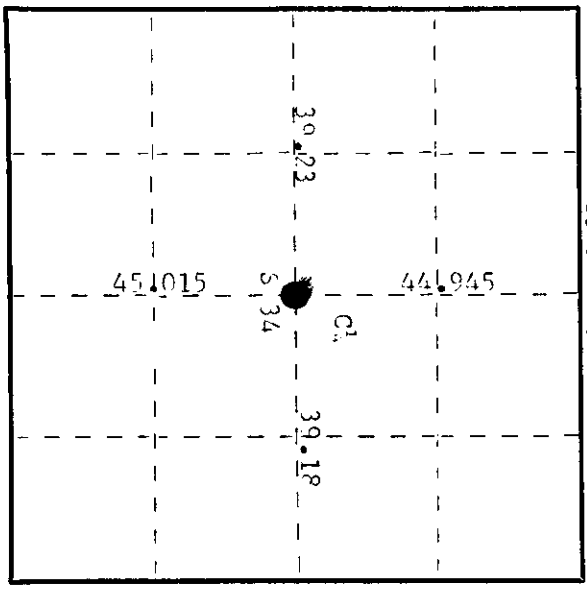

O = Corner monument restored.

History of original corner establishment:

Corner established by N. Loftus, Pisco surveyor, in 1960. Ran E-W and N-S 1/4 line to establish the C 1/4 corner at intersection. Set iron pipe and marked NBTs - White Pine 7" S24°W, 35' links and White Spruce 7" N85°W, 35' links.

Description of corner evidence found:

Recovered 2" iron pipe with 3" square brass cap, projecting 30" above ground. Cap stamped: Recovered CRTs - White Pine 7" (10") S24°W, 35' links. White Spruce 7" N85°W, 35' links, now stump only. T39P R9F Cl S34 PTCC

Description of monument and accessories I established to perpetuate the original location of this corner.

As monument was securely in ground, it was left as recovered. Marked PPTS - Red Pine 12" N80°E, 34.0 links, scribed Cl PT. White Pine 9" N48°E, 63.5 links, scribed Cl PT.

Dated at Oneida, Wis., this 26th day of August, 1977

Signature: Philip T. Hansen, Title: Registered Land Surveyor, Registration No. S-408 (County Surveyor, Registered Land Surveyor, or other duly authorized official)

Office of Register of Deeds, County of Oneida. I hereby certify that the within instrument was filed in this office for record on the 13th day of September, 1977 at 4:00 o'clock P.M.

Signature: James H. Hays, Register of Deeds

By: Deputy