

CERTIFIED LAND CORNER RESTORATION

Index No. **W-17**

State of Wisconsin

County of Oneida

ss.

I, Philip T. Hansen, do hereby certify that on the 24th day of August, 1977, I found evidence of the N 1/16 corner of Section 34 - 35

Township 38 North, Range 4 East, Fourth Principal Meridian,

I established a new monument and accessories as described hereon to perpetuate the original location of this corner.

Resident witnesses:

Jim Claffin

Herb Margaret

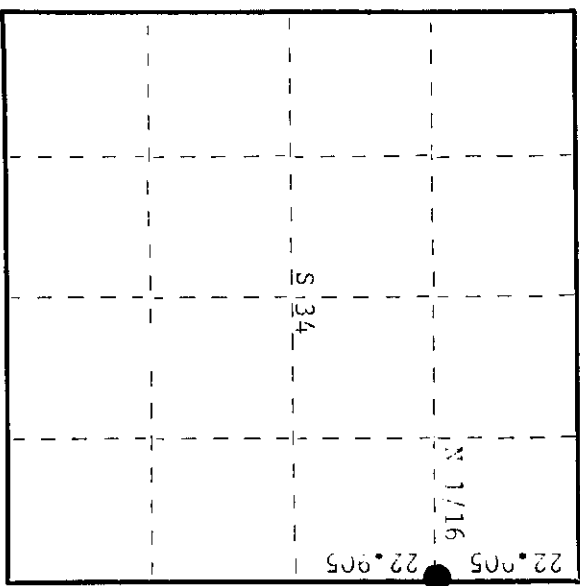
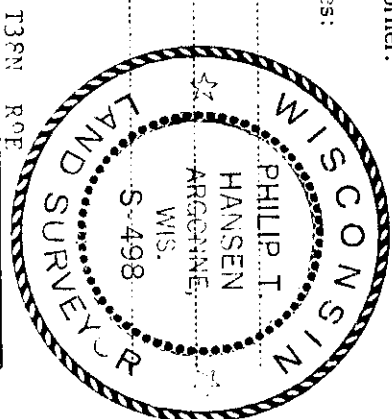

○ = Corner monument restored.

3809343000

History of original corner establishment:

This corner established by R. Dardow. Corner recovered by N. Loftus, Ripco Surveyor, in 1960. Ran random line N 70° 26' 30" E from recovered E 1/4 corner set by Vincentsen. Recovered pin set in west wheel track of old road. Set a reference post 20 links west and marked NBTs - Black Spruce 3" N52° 52 links; Black Spruce 3" N67° E, 35.5 links.

Description of corner evidence found:

Recovered Ripco's 1" iron pipe with 2" brass cap stamped as witness corner projecting 36" above ground, 20 links west of wheel track. Unable to recover iron pin in west wheel track of old abandoned road.

Recovered CBTs - Black Spruce 3" N52° 52 links, scribbled N 1/16 S34 BT. Black Spruce 3" N67° E, 35.5 links, scribbling grown over.

Description of monument and accessories I established to perpetuate the original location of this corner.

Drove 1" x 12" iron pipe for true corner in old abandoned road from calls of recovered BTs. Cap on witness corner stamped:

N 1/16  
S34 | S35  
PIFCC  
20 lks East

Dated at Rhineland, Wis., this 8th day of September, 1977.

Signature: *Philip T. Hansen* Title: Registered Land Surveyor Registration No. S-498  
(County Surveyor, Registered Land Surveyor, or other duly authorized official)

Office of Register of Deeds, County of Oneida  
Instrument was filed in this office for record on the 24th day of August, 1977, at 2:50 o'clock P.M.

*Doris M. Hays*  
(Register of Deeds)

By: \_\_\_\_\_ Deputy