

CERTIFIED LAND CORNER RESTORATION

Index No. W-16

State of Wisconsin

County of Oneida } ss.

I, Phillip T. Hansen, do hereby certify that on the 19th day of August, 1977, I found evidence of the NE 1/16 corner of Section 34 Township 38, North, Range 9 East, Fourth Principal Meridian, as described hereon; and that from this evidence I established a new monument and accessories as described hereon to perpetuate the original location of this corner.

Resident witnesses:

Jim Clafflin

Herb Wagoner

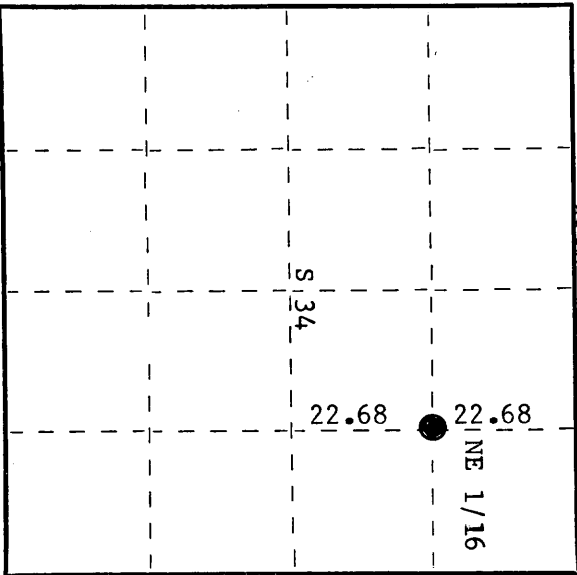
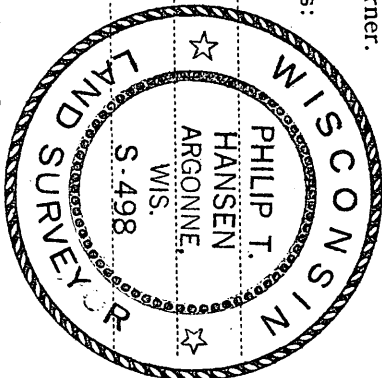

○ = Corner monument restored.

History of original corner establishment:

Corner established by N. Loftus, Ripco Surveyor, in 1960. Ran random line S 8° 20' W from previously established E 1/16 corner 45.36 chains to previously established EC 1/16 corner. Set NE 1/16 at 22.68 chains intermediate. Set post and marked BTs - Maple 3" S19°E, 42 1/4 links Maple 3" N46°W, 7 links

Description of corner evidence found:

Recovered 4" square wood post, but no iron pipe.
Recovered OBTS - Maple 3" S19°E, 42.25 links, blown down.
Maple 3" (6") N46°W, 7.0 links, scribing not legible.

Description of monument and accessories I established to perpetuate the original location of this corner.

Replaced wood post with 1 1/2" iron pipe with 2" brass cap, stamped:
Monument projects 24" above ground.
Marked NBT - Maple 4" S54°W, 38.0 links, scribed 1/16 BT.

T38N R9E
NE 1/16 S 34
CPI-1977

Dated at Rhineland, Wis., this 29th day of August, 1977

Signature Phillip T. Hansen Title Registered Land Surveyor Registration No. S-498
(County Surveyor, Registered Land Surveyor, or other duly authorized official)

Office of Register of Deeds, County of Oneida
Instrument was filed in this office for record on the 13th day of September, 1977
at 11:00 o'clock A. M.

Louis Veragee Kuehn
(Register of Deeds)

By _____ Deputy