

CERTIFIED LAND CORNER RESTORATION

Index No. **W-14**

State of Wisconsin } ss.

County of Oneida

I Phillip T. Hansen, do hereby certify that on the 24th day of August, 1977, I found evidence of the NW 1/16 corner of Section 34, Township 38 North, Range 9 East, Fourth Principal Meridian.

I established a new monument and accessories as described hereon to perpetuate the original location of this corner.

Resident witnesses:

Jim Claflin

Herb Wagoner

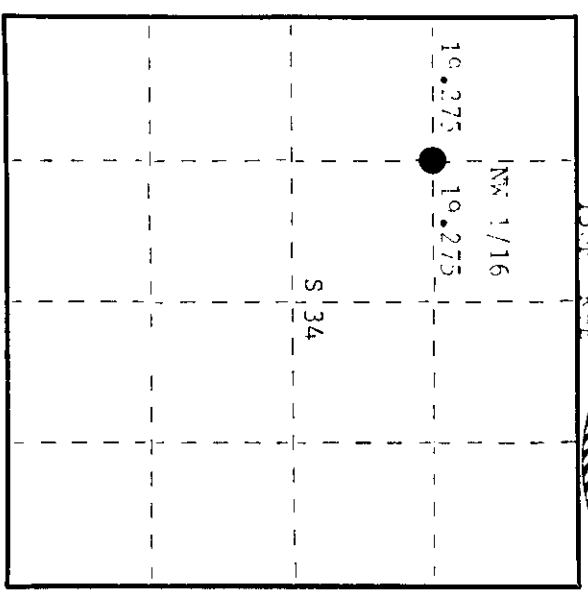
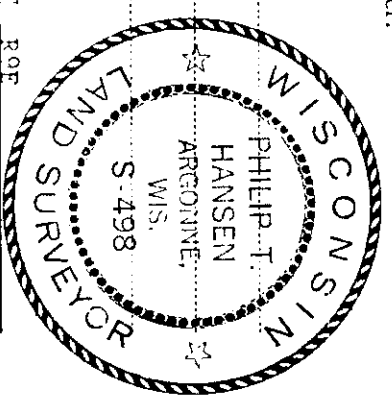

History of original corner establishment:

Corner established by N. Loftus, RIFCO Surveyor, in 1960. From previously established NC 1/16 ran a random line S 88° 59' W 39.55 chains to close out 30 links south of N 1/16 corner.

Set NW 1/16 corner at 19.275 chains equidistant 19.5 links north. Set iron pipe and marked NPTs - Red line 80 N41° 54 links. Black Spruce 60 S70° F, 44 links.

Description of corner evidence found:

Recovered 1" Iron pipe with 2" brass cap in excellent condition, projecting 30" above ground.

Recovered CRTs - Red line 80 N41° 54 links (54.3 links), scribed NW 1/16 S34 BT. Black Spruce 60 S70° F, 44.5 links, scribed S34 BT (now dead).

Description of monument and accessories I established to perpetuate the original location of this corner.

Monument left in place as recovered. Cap stamped: Marked NPT - Marble 100 S25° E, 59.0 links, scribed 1/16 BT.



Dated at Rhinelander, Wis., this 8th day of September, 1977.

Signature: *Phillip T. Hansen* Title: Registered Land Surveyor Registration No. S-498
 County Surveyor, Registered Land Surveyor, or other duly authorized official

Office of Register of Deeds, County of Oneida
 Instrument was filed in this office for record on the 15th day of September, 1977 at 2:00 o'clock P.M.

James H. Hagg
 (Register of Deeds)

By: Deputy