

CERTIFIED LAND CORNER RESTORATION

Index No. **A-19**

State of Wisconsin }
 County of Ozaukee } ss.

I, Philip T. Hansen, do hereby certify that on the 11th day of October, 1956, I found evidence of the Quarter corner of Section 35 Township 37 N. 38, North, Range 2 East, Fourth Principal Meridian, as described hereon; and that from this evidence I established a new monument and accessories as described hereon to perpetuate the original location of this corner.

Resident witnesses:

Jim D. Miller

Herb [unclear]

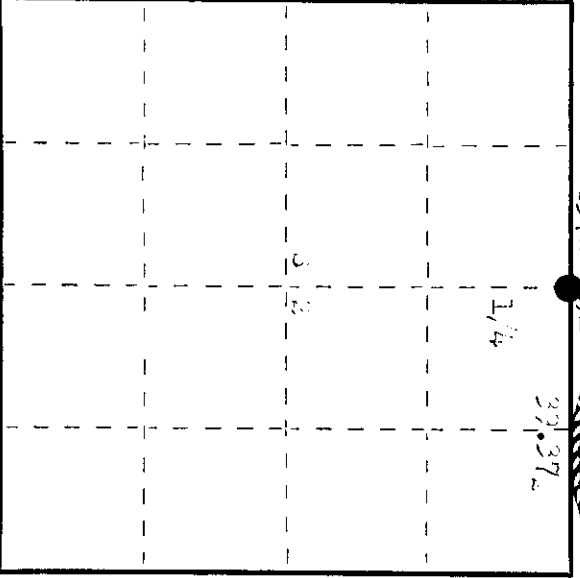
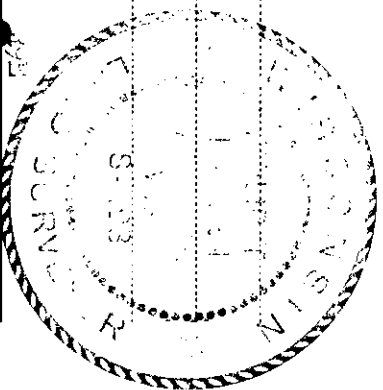

○ = Corner monument restored.

History of original corner establishment:

Corner established by J. Loftus, City Surveyor, in 1950. A 4" x 4" iron pipe 84" x 1/2" iron band corner set, 20" x 1" x 2" 70.8" chains to stone out of line south of sec. cor. 4, 3, 24, 25. Set corner by proportion 27.37% chains equidistant. Marked with Jack Pine 4" x 7" x 15", links and red pine 2 86" x 78 links.

Description of corner evidence found:

Recovered 2 1/2" iron pipe with 4" square brass cap standing recovered 27.37% - Jack Pine 10" x 7" x 15" (12.0 links) 15.5 links (15.2 links). Red Pine 14" x 30" x 78.0 links. 138.0 links 138.0 links

Description of monument and accessories I established to perpetuate the original location of this corner.

As monument was recovered in good condition, it was left in place. Monument project's 50" above ground. 27.37% - with 10" x 7" x 15" x 12.1 links, section 1/4 T. Distance measured by number of links.

Dated at Waukegan, Wis., this 5th day of October, 1956.

Signature: Philip T. Hansen Title: Registered Land Surveyor or other duly authorized official Registration No. 1233

Office of Register of Deeds, County of Ozaukee. I hereby certify that the within instrument was filed in this office for record on the 11th day of October, 1956 at 9:30 o'clock A.M.

Louise Savage Trehan
 (Register of Deeds)

By: _____ Deputy

3809350020