

CERTIFIED LAND CORNER RESTORATION

Index No. T-22

State of Wisconsin }
County of Oneida } ss.

I Philip T. Hansen, do hereby certify that on the 19th day of December, 1977, I found evidence of the WC 1/16 corner of Section 25 Township 38, North, Range 10 East, Fourth Principal Meridian, as described hereon; and that from this evidence I established a new monument and accessories as described hereon to perpetuate the original location of this corner.

Resident witnesses:

Jim Claflin

Herb Wagoner

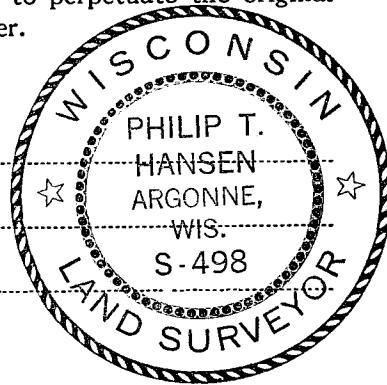

FORM 985 H. C. MILLER CO., MILWAUKEE

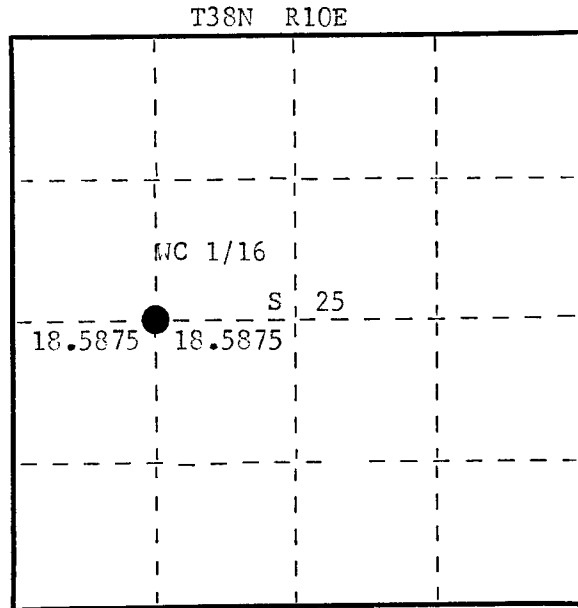

○ = Corner monument restored.

History of original corner establishment:

Corner established by Coddard and crew, Ripco Surveyors, in 1960. Ran random line 268° 50' magnitude bearing from E 1/4 corner to close out 27 links south of W 1/4. Established C 1/4 corner at 37.02 chains east of E 1/4 corner. Set CW 1/16 at 18.5875 chains, intermediate at S 87° 07' 30" W of C 1/4. Marked NBTs - Jack Pine 4" S 14° E, 38½ links
Jack Pine 4" S 33° W, 52½ links.
Found Vaughan's old WC 1/16 corner out of line and distance.

Description of corner evidence found:

Recovered 3/4" iron pipe with 2" brass cap. It sets just north of logging road and has been hit by snowplowing equipment.
Recovered OBT - Jack Pine 4" (6") S14°E, 38.5 links, (our bearing S 34° E) 39.0 links, scribed S25 CW 1/16 BT.
Recovered OBT - Jack Pine 4" (5") S33°W, 52.5 links (our bearing S15°W, 46.0 links, scribed S25 CW 1/16 BT.
Believe Ripco has bearings to BTs turned around.
True corner stamped:

W 1/16
C ——— C
S25
RIFCO

Description of monument and accessories I established to perpetuate the original location of this corner.

Reset pipe flush with ground.
Set a 1" iron pipe with 2" brass cap 25 links north for a witness corner.
Monument projects 24" above ground w cap stamped:
Marked NBT - Jack Pine S37°W, 54.7 links, scribed 1/16 BT.

S498
T38N R10E
WC 1/16 S +²⁵ W.C.
S 25 lks
CPI-1977

Dated at Rhineland, Wis., this 20th day of December, 1977

Signature Philip T. Hansen Title Registered Land Surveyor Registration No. S-498
(County Surveyor, Registered Land Surveyor, or other duly authorized official)

Office of Register of Deeds, County of Oneida, I hereby certify that the within instrument was filed in this office for record on the 3rd day of January, 1978 at 3:00 o'clock P M.

Dani Verage Kuehn
(Register of Deeds)

By Joseph M. Boomer Deputy

3810 25 2030