

State of Wisconsin

County of Creda } ss.

I Philip T. Hansen, do hereby certify that on the 30th day of September, 1977, I found evidence of the E 1/16 corner of Section 36 E 33

Township 35, North, Range 10 East, Fourth Principal Meridian,

as described hereon; and that from this evidence I established a new monument and accessories as described hereon to perpetuate the original location of this corner.

Resident witnesses:

Jim Claffin

Herb Hagoner

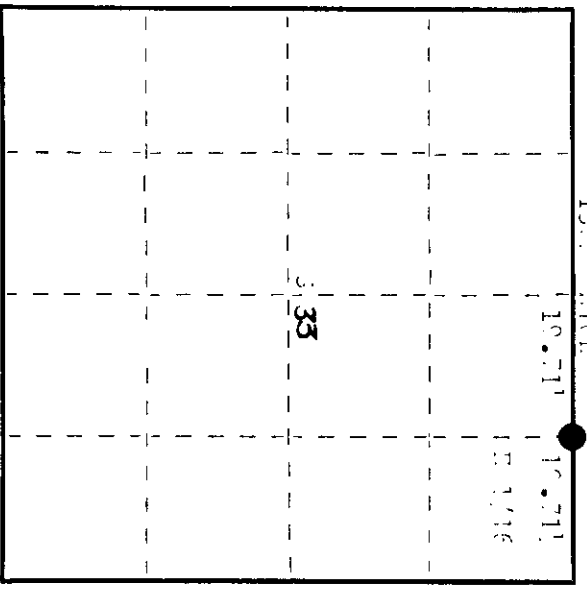
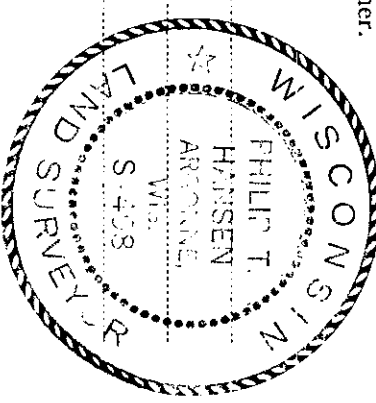

○ = Corner monument restored.

History of original corner establishment:

Corner established by W. Loftus, Rice Surveyor, in 1956. Tan meridian line S 89° 30' E from N 1/4 corner, 36.43 chains to close out 1.62 chains north of section corner. Set E 1/16 at 91 links south of 19.711 chains.

Marked WPTs - Red Parale (N 57° 0' E, 36 links) Red Parale (N 32° 0' E, 7 links)

Description of corner evidence found:

Recovered 19' iron pipe with a 2" square brass cap in excellent condition, projecting 20" above ground. Cap stamped:

Monument set on the N.E. edge of a small clearing. Recovered monument over. Section 36 E 33, Township 35 N, Range 10 E, 4th Principal Meridian, Arconne, Wis. S. 438. Set 19.711 chains from N.E. corner of section.

Description of monument and accessories I established to perpetuate the original location of this corner.

Monument left as recovered. No additional accessories established.

Dated at Elmwood, Wis., this 4th day of October, 1977.

Signature Philip T. Hansen Title Registered Land Surveyor Registration No. 2-133 (County Surveyor, Registered Land Surveyor, or other duly authorized official)

Office of Register of Deeds, County of Creda. I hereby certify that the within instrument was filed in this office for record on the 19th day of November, 1977 at 2:10 o'clock P. M.

Doris Savage Kuehn (Register of Deeds)

By Joseph M. Barnes Deputy