

CERTIFIED LAND CORNER RESTORATION

Index No. **Y-10**

State of Wisconsin

County of Oneida } ss.

I Phillip T. Hansen, do hereby certify that on the 29th day of January, 1978, I found evidence of the W 1/16 corner of Section 28 & 33 Township 38, North, Range 10 East, Fourth Principal Meridian, as described hereon; and that from this evidence I established a new monument and accessories as described hereon to perpetuate the original location of this corner.

Resident witnesses:

Jim Clafflin

Herb Wagoner

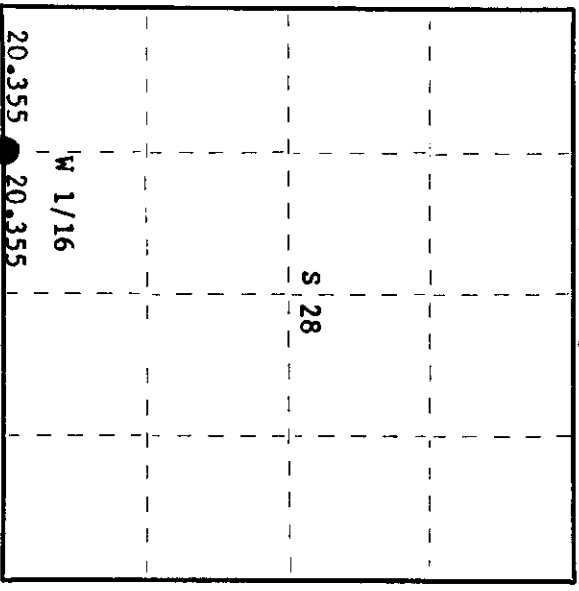
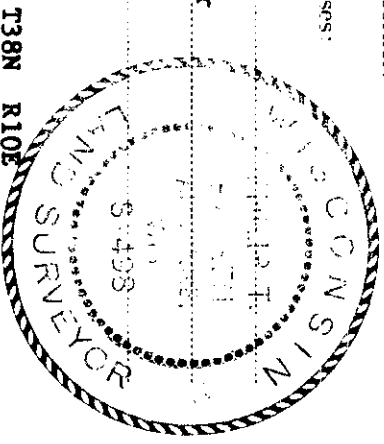

History of original corner establishment:

Corner established by N. Loftus, Ripco surveyor, in 1956. Ran random line S86° E from recovered Section Corner 29, 28, 33, 32, 40.21 chains to close out 61 links south of 1/4 corner between Sections 28 & 33. Set W 1/16 corner at 20.35½ chains intermediate at corrected bearing S86° 51' E. Marked NBT's - Black Spruce 3" S22°W 50 links Black Spruce 2½" S70°E, 38½ links

Description of corner evidence found:

Recovered 1½" iron pipe with 2" square brass cap in excellent condition projecting 12" above ground. Cap stamped:
Recovered OBT's - Black Spruce 3" S22°W, 50 links, now dead, W 1/16 scribed 1/16 S33 BT.
Black Spruce 2½" S70°E, 38.25 links, now dead, S33 scribed 1/16 S33 BT. Ripco R1PCO

Description of monument and accessories I established to perpetuate the original location of this corner.

Monument left in place as recovered.
Marked NBT's - Black Spruce 3" N40°W, 14.6 links
Black Spruce 4" S82°E, 45.5 links
both scribed BT.

Dated at Rhineland, Wis. this 1st day of February, 1978

Signature: Phillip T. Hansen Title: Registered Land Surveyor Registration No. S-498
(County Surveyor, Registered Land Surveyor, or other duly authorized official)

Office of Register of Deeds, County of Oneida
Instrument was filed in this office for record on the 6th day of February, 1978
at 9:30 o'clock AM.

Dorrie LePage Kuehn
(Register of Deeds)

By: Deputy

3810280030