

CERTIFIED LAND CORNER RESTORATION

Index No. 05-11

State of Wisconsin }
County of Oneida } ss.

I, Phillip T. Hansen, do hereby certify that on the 29th day of January, 19 78, I found evidence of the SC 1/16 corner of Section 28 Township 38, North, Range 10 East, Fourth Principal Meridian, as described hereon; and that from this evidence I established a new monument and accessories as described hereon to perpetuate the original location of this corner.

Resident witnesses:

Jim Clafflin

Herb Wagoner

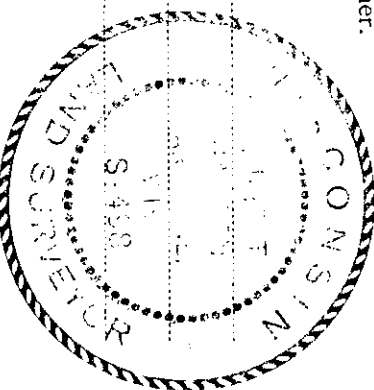

T38N R10E

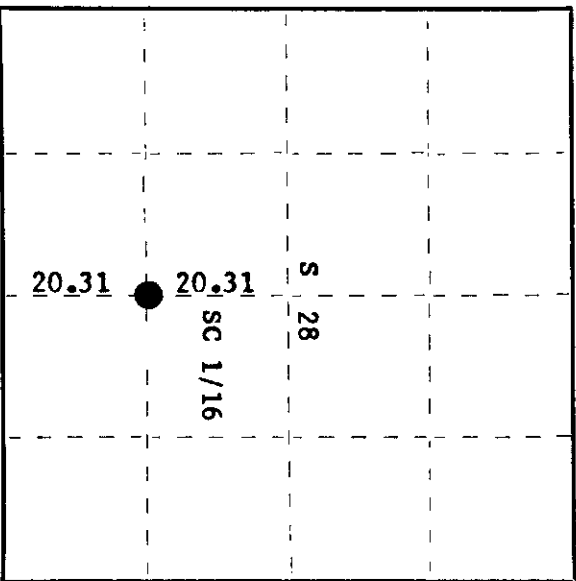

○ = Corner monument restored.

History of original corner establishment:

Corner established by N. Loftus, Ripco Surveyor, in 1958. From Vaughan's S 1/4 corner ran random line 358° magnitude at 40.62 chains. Hit Vaughan's C 1/4 corner in place and old BT's. Set iron pipe and marked NBT's - Maple 9" N56°E, 30 1/2 links and old BT's. Set iron pipe and marked NBT's - Maple 9" N56°E, 30 1/2 links Red Maple 4" N57°W, 28 links

Description of corner evidence found:

Recovered 3/4" iron pipe with 2" square brass cap in excellent condition. Cap stamped: Recovered OBT's - Sugar 9" N56°E, 30.5 links (31.0 lks), now dead, scribed SC 1/16 BT. Red Maple 4" (6") N57°W, 28.0 links, scribing grown over.

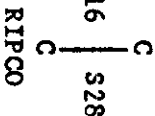

Description of monument and accessories I established to perpetuate the original location of this corner.

Monument was left in place as recovered. Marked NBT's - Maple 12" N71°E, 49.3 links, scribed 1/16 BT. Monument projects 20" above ground.

Dated at Rhineland, Wis., this 1st day of February, 19 78

Signature: Phillip T. Hansen Title Registered Land Surveyor Registration No. S-498
(County Surveyor, Registered Land Surveyor, or other duly authorized official)

Office of Register of Deeds, County of Oneida I hereby certify that the within instrument was filed in this office for record on the 6th day of February, 19 78 at 9:30 o'clock A. M.

Dona Savage Kuehn
(Register of Deeds)

By: _____ Deputy