

CERTIFIED LAND CORNER RESTORATION

Index No. **V-8**

State of Wisconsin

County of Oneida } ss.

I, Phillip T. Hansen, do hereby certify that on the 28th day of February, 1978, I found evidence of the E 1/16 corner of Section 29 & 32 Township 38, North, Range 10 East, Fourth Principal Meridian, as described hereon; and that from this evidence I established a new monument and accessories as described hereon to perpetuate the original location of this corner.

Resident witnesses:

Jim Claflin

Herb Wagoner

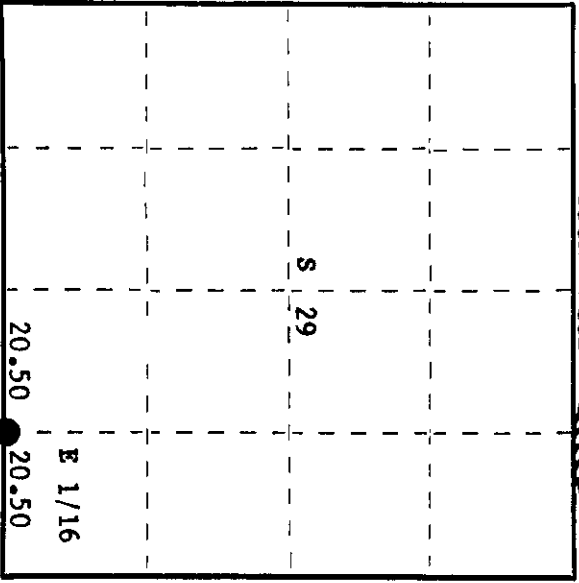
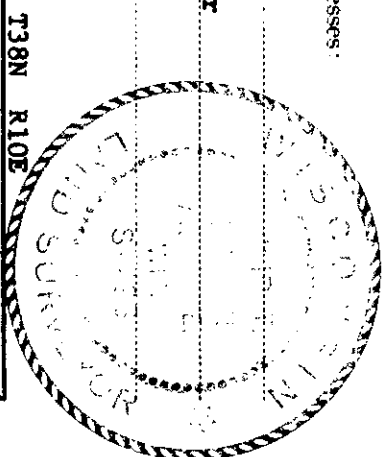

○ = Corner monument restored.

History of original corner establishment:

Corner established by N. Loftus, Ripco Surveyor, in 1957. Ran random line east from section corner 29, 30, 31 & 32, S 0° 50' E, 82.41 chains to close out 1.51 chains south of section corner 28, 29 & 32, 33. Set 1/4 corner by proportionate measure 41.41 chains, at corrected bearing N89° 47' E. Set E 1/16 corner at 61.91 chains intermediate. Marked NBT's - black spruce 4" S10°E, 37 links black spruce 4" N3°E, 51 links

Description of corner evidence found:

Recovered 1" iron pipe with 2½" square brass cap in good condition, projecting 12" above ground, cap stamped:

Recovered OBT's - black spruce 4" (5") S10°E, 37 links, scribed 1/16 S32 BT.
black spruce 4" N3°E, 51.0 links (51.8 lks), scribed 1/16 S29 BT.

E 1/16 S29
S32
RIPCO

Description of monument and accessories I established to perpetuate the original location of this corner. Monument left in place as recovered. No additional accessories established.

Dated at Rhineclander, Wis., this 6th day of March, 1978

Signature Phillip T. Hansen Title Registered Land Surveyor Registration No. S-498
(County Surveyor, Registered Land Surveyor, or other duly authorized official)

Office of Register of Deeds, County of Oneida, I hereby certify that the within instrument was filed in this office for record on the 13th day of March, 1978 at 2:30 o'clock P. M.

Doris George Fuchsa
(Register of Deeds)

By: _____ Deputy