

CERTIFIED LAND CORNER RESTORATION

Index No. 2-2

State of Wisconsin

County of Oneida } ss.

I Phillip T. Hansen, do hereby certify that on the 7th day of September, 1979, I found evidence of the W 1/16 corner of Sections 31 and 6 Township 38 E. 37, North, Range R10 East, Fourth Principal Meridian, as described hereon; and that from this evidence I established a new monument and accessories as described hereon to perpetuate the original location of this corner.

Resident witnesses:

Jim Clafflin

Herb Wagoner

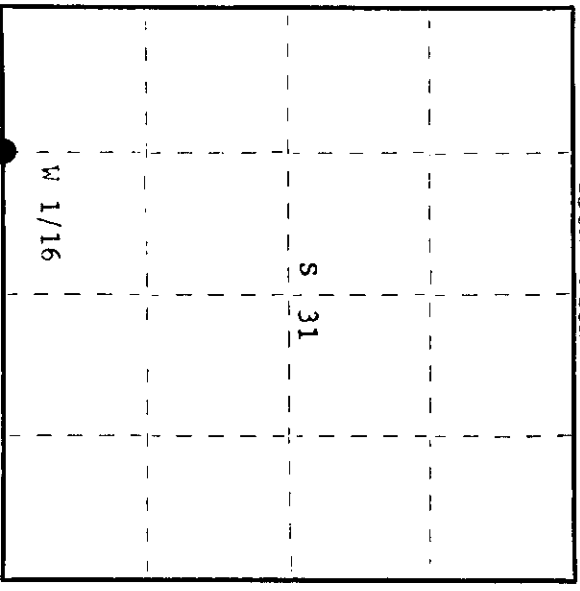
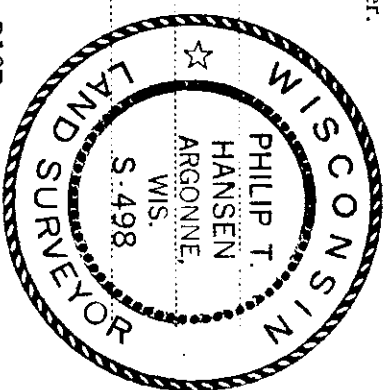

○ = Corner monument restored.

History of original corner establishment:
Corner established by Ripco survey crew.

Description of corner evidence found:

- Recovered Ripco's 3/4" iron pipe with 2" diameter brass cap in good condition.
- Monument projects 8", stamped:
- Corner sets 2 chains west of Sovinski's new north-south road.
- Recovered ORT's -
 - Black Spruce 5" N10°E 4.5 links, scribed W 1/16 BT. T38N R10E
 - Black Spruce 6" S21°E 11.5 links, scribed S6 W 1/16 BT. S31 W 1/16

Description of monument and accessories I established to perpetuate the original location of this corner.
Monument left in place as recovered.
No additional accessories established.

Dated at Rhineland, Wis., this 10th day of September, 1979

Signature Phillip T. Hansen Title Registered Land Surveyor Registration No. S-498
(County Surveyor, Registered Land Surveyor, or other duly authorized official)

Office of Register of Deeds, County of Oneida I hereby certify that the within instrument was filed in this office for record on the 17th day of September, 1979 at 105 o'clock P. M.

Lorin Nease Kuehn
(Register of Deeds)

By..... Deputy