

CERTIFIED LAND CORNER RESTORATION

Index No. 2-6

State of Wisconsin

County of Oneida } ss.

I, Phillip T. Hansen, do hereby certify that on the 24th day of April, 1980, I found evidence of the W 1/16 corner of Sections 32 and 5 Township 37 & 38, North, Range 10 East, Fourth Principal Meridian, as described hereon; and that from this evidence I established a new monument and accessories as described hereon to perpetuate the original location of this corner.

Resident witnesses:

Jim Clafflin  
Herb Wagoner

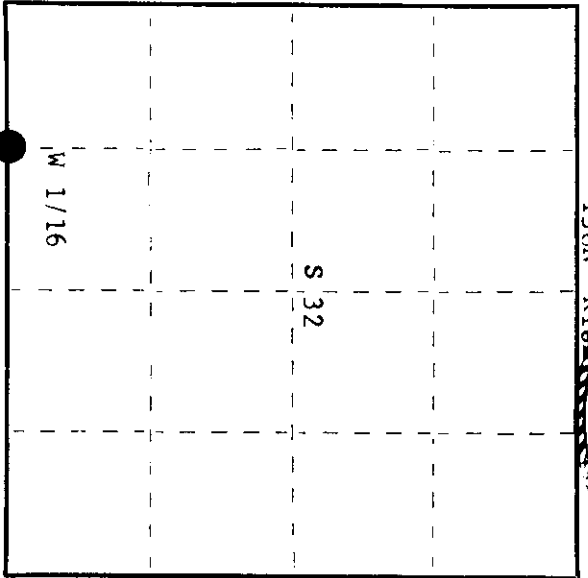
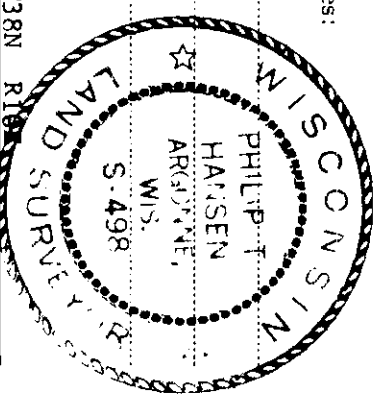

○ = Corner monument restored.

History of original corner establishment:

Corner searched for but none found by N. Loftus, Ripco surveyor. Corner established by Ripco surveyor by running west, bearing  $270^\circ$  from previously established S 1/4 corner 41.21 chains to close out 2.235 chains, south at section corner. Corrected bearing and distance is  $N 86^\circ 54' W$ , 41.27 chains. Set W 1/16 at 20.63-1/2 chains intermediate. Marked NBT's - Balsam 8"  $N42^\circ E$  6 links. B. Spruce 5"  $S56^\circ W$  20 links.

Description of corner evidence found:

Recovered Ripco's 3/4" iron pipe with 2" square brass cap in good condition.  
Monument projects 18" above ground, cap stamped:  
Recovered OBT's - Balsam 8"  $N55^\circ E$  6.0 links (6.5 links), now a dead stub.  
B. Spruce 5"  $S56^\circ W$  20.0 links (no trace of this BT).

38-10  
S 32  
W 1/16  
S 5  
37-10  
Ripco

Description of monument and accessories I established to perpetuate the original location of this corner.

Left monument in place as recovered.  
Marked NBT's - Maple 6"  $S83^\circ E$  8.0 links.  
Maple 6"  $N48^\circ W$  75.8 links  
both scribed 1/16 BT.

Dated at Rhineland, Wis., this 30th day of June, 1980

Signature Phillip T. Hansen Title Registered Land Surveyor Registration No. S-498  
(County Surveyor, Registered Land Surveyor, or other duly authorized official)  
Office of Register of Deeds, County of Oneida 21st day of July, 1980.  
at 3:35 o'clock P. M. I hereby certify that the within instrument was filed in this office for record on the 21st day of July, 1980.

Dana George Tucker  
(Register of Deeds)

By: \_\_\_\_\_ Deputy