

CERTIFIED LAND CORNER RESTORATION

Index No. **X-6**

State of Wisconsin

County of Oneida } ss.

I Phillip T. Hansen, do hereby certify that on the 12th day of May, 1977, I found evidence of the WC 1/16 corner of Section 32

Township 38, North, Range 10 East, Fourth Principal Meridian,

as described hereon; and that from this evidence I established a new monument and accessories as described hereon to perpetuate the original location of this corner.

Resident witnesses:

Jim Clarlin

Herb Wagoner

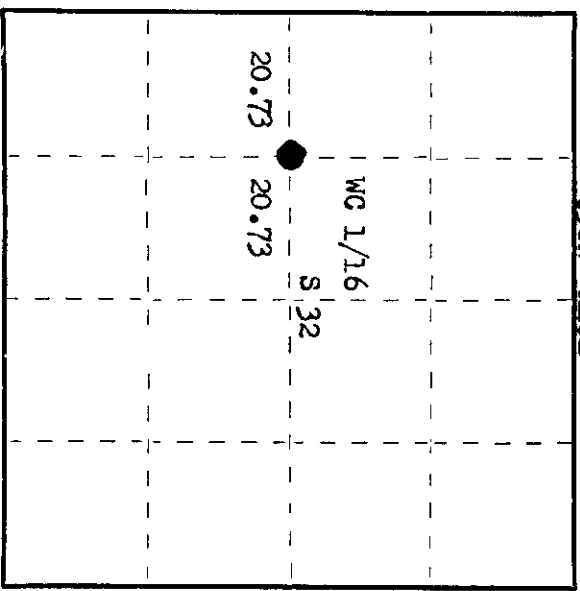
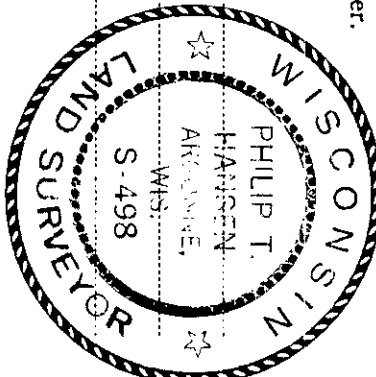

○ = Corner monument restored.

History of original corner establishment:

Original Corner established by B.F. Dorr. Corner re-established by N. Loftus, Ripco Surveyor. Ran random line west, bearing 268° 17', corrected bearing from E 1/4 corner through Dorr's C 1/4 41.46 chains to W 1/4. Set WC 1/16 at 20.73 chains, intermediate. Marked NBTs - Balsam 4" S63°E 17 links and Black Spruce 3" N46°E 34½ links.

Description of corner evidence found:

Recovered 1" OD iron pipe with 2" brass cap, stamped: Monument projects 16" above ground. Monument recovered in excellent condition and securely in ground. Recovered NBTs - Black Spruce 3" (6") N45°E 17.0 links. Balsam 4" (7") S63°E 34.5 links, scribing not legible.

T38N R10E
W 1/16
S32
RIPCO

Description of monument and accessories I established to perpetuate the original location of this corner.

As the monument was recovered in excellent condition and securely in ground, it was left in place. Marked NBT - White Birch 10" N44°E 68.0 links, scribed 1/16 BT.

Dated at Rhinelander, Wis., this 26th day of May, 1977.

Signature: Phillip T. Hansen Title: Registered Land Surveyor Registration No. S-498
(County Surveyor, Registered Land Surveyor, or other duly authorized official)

Office of Register of Deeds, County of Oneida, I hereby certify that the within instrument was filed in this office for record on the 3d day of June, 1977 at 10:30 o'clock AM.

Dorcas W. W. Kuehn
(Register of Deeds)

By _____ Deputy

3510322030