

CERTIFIED LAND CORNER RESTORATION

Index No. Y-11

State of Wisconsin } ss.

County of Oneida

I Phillip T. Hansen, do hereby

certify that on the 2nd day

of May, 1978, I found

evidence of the SC 1/16

corner of Section 33

Township 38, North, Range

10 East, Fourth Principal Meridian,

as described hereon; and that from this evidence

I established a new monument and accessories

as described hereon to perpetuate the original

location of this corner.

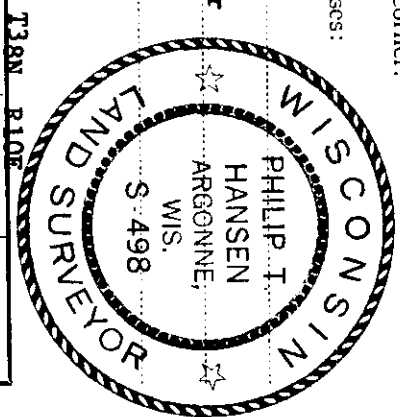

Resident witnesses:

Jlm Claflin

Herb Wagoner

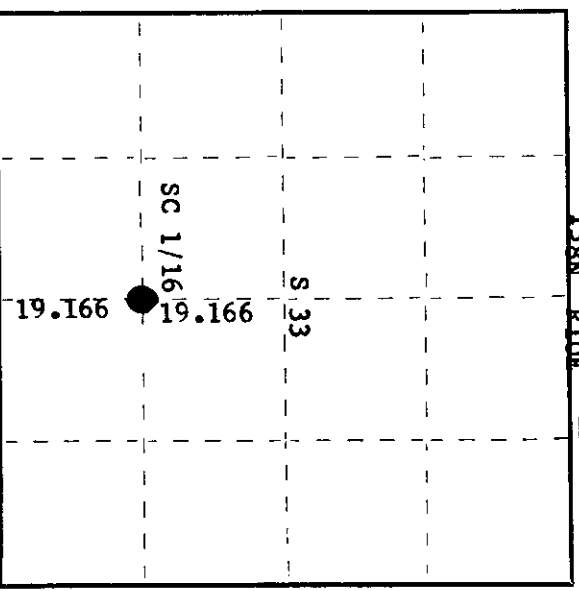

○ = Corner monument restored.

History of original corner establishment:

Corner established by N. Loftus, Ripco surveyor, in 1956. Ran from S 1/4 to previously established C 1/4 corner S 0° 02' W 38.355 chains. Established SC 1/16 corner at 19.166 chains intermediate.

Marked BT's -

Maple 4" S57°W, 13-3/4 links

Maple 2 1/2" N65°E, 38 1/2 links

Description of corner evidence found:

Recovered 1" iron pipe with 3" brass cap, stamped: Projects 24" above ground.

Recovered OBT's - Maple 4" (7") S57°W, 13.75 links (13.1 links) scribing grown over

Maple 2 1/2" (5") N65°E, 38.5 links scribing grown over

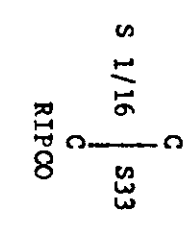

Description of monument and accessories I established to perpetuate the original location of this corner. No additional accessories established.

Dated at Rhinelander, Wis., this 18th day of May, 1978

Signature Phillip T. Hansen Title Registered Land Surveyor Registration No. S-498
(County Surveyor, Registered Land Surveyor, or other duly authorized official)

Office of Register of Deeds, County of Oneida. I hereby certify that the within instrument was filed in this office for record on the 22nd day of May, 1978 at 10 o'clock P. M.

Doree Verage Fisher
(Register of Deeds)

By: _____ Deputy