

U.S. PUBLIC LAND SURVEY MONUMENT RECORD

Index No. E 23

State of Wisconsin }
 County of Oneida } ss.
 I John H. Fisher, do hereby
 certify that on the 7 day
 of January 19 85, I found
 evidence of the quarter
 corner of Section 1 & 12
 Township 38 North, Range
 11 East, Fourth Principal Meridian,
 as described hereon; and that from this evidence
 I established a new monument and accessories
 as described hereon to perpetuate the original
 location of this corner.

Resident witnesses:

None

History of original corner establishment: Original survey in 1859 by Alfred Willard. Dependent
 Resurvey in 1941 by Hugh B. Crawford. At 43.58 chains set a concrete monument
 24 inches long, 6 inches diameter, 18 inches in the ground with an iron post
 23 inches long 1 inch diameter embedded in center with a brass tablet stamped:
 From which the following bear:

1/4	S 1	Balsam	9"	N26-1/2°	73 lks
	S 12	White Pine	5"	S30°	175 lks
	1941				

Description of corner evidence found:
 E.I.W. brass tablet on 2 inch diameter iron pipe in place.

Description of monument and accessories I established to perpetuate the original location of this corner.
 Corner in good condition: Blazed and scribed the following new bearing trees:
 Set nail in:

White Pine	9"	S80°W	12.1 feet
Balsam	8"	N28°W	12.0 feet
White Pine	1 1/2"	S 3°E	20.0 feet
White Spruce	8"	S36°W	24.5 feet
Set steel sign post		East	1.4 feet

Dated at Oneida, Wis., this 21st day of March, 19 85

Signature: John H. Fisher Title: Registered Land Surveyor Registration No. 3-636
 (County Surveyor, Registered Land Surveyor, or other duly authorized official)

Office of Register of Deeds, County of Oneida
 Instrument was filed in this office for record on the 23rd day of April, 19 85
 at 3:30 o'clock P.M.

Donis Venage Fuchs
 (Register of Deeds)

By: Deputy

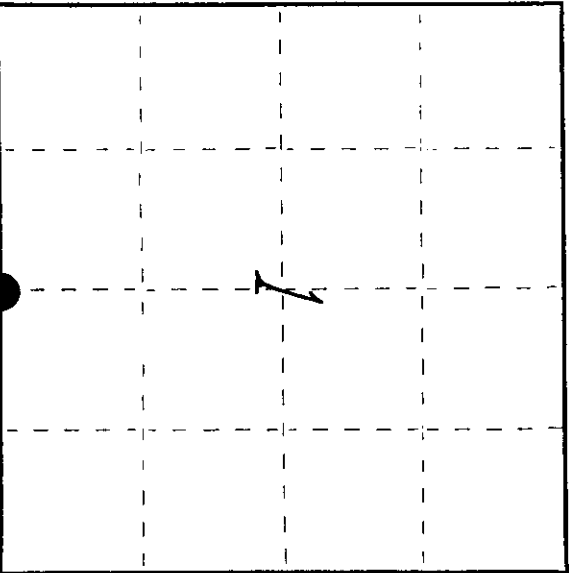

○ = Corner monument restored.

3811010020

(e) Describe any material discrepancy between the location of the corner as restored or reestablished and the location of that corner as previously restored or reestablished by distance and direction. Show the discrepancy on the plan view drawing under (d), above. Show the distances between the corner as previously restored or reestablished and (1) the corner as restored or reestablished, and (2) to at least 2 of the witness monuments shown on the drawing in (d), above.

See drawing below

(f) Was the corner restored through acceptance of (1) an obliterated evidence location, or, (2) a found perpetuated location?

Found perpetuated location

(g) Was the corner reestablished through lost corner proportionate methods? If so, show the method, including the directions and distances to other public land survey corners used as evidence or used for proportioning in determining the corner location?

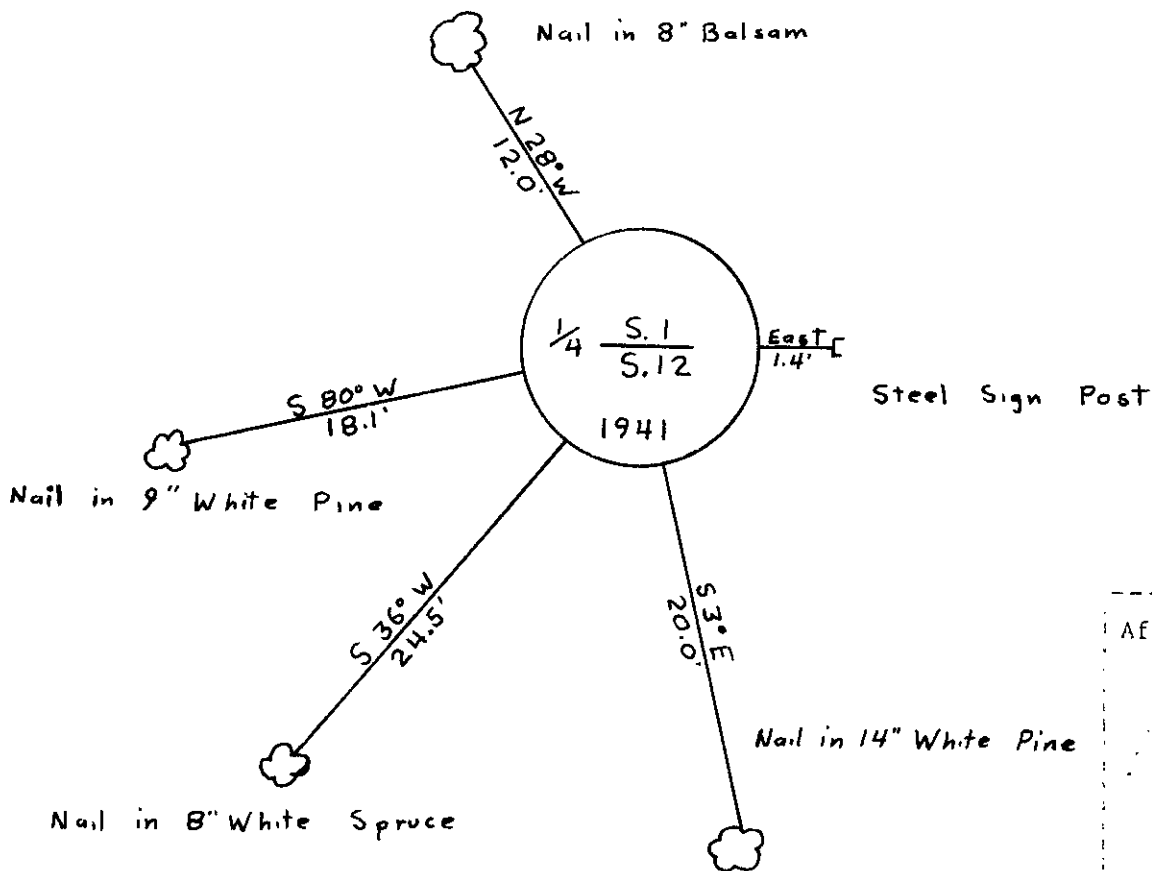

Affix Land Surveyor Seal

(i) I, John H. Fisher
 (type or print name) certify that the corner location shown on this record was determined by me or under my direction and control and that this U.S. Public Land Survey Monument Record is correct and complete to the best of my knowledge and belief.

John H. Fisher
 Signature

3/21/85
 Date