

REGISTER'S OFFICE }  
 Oneida County, Wis. }  
 Received for Record the 12<sup>th</sup> day of  
January A. D. 1976 at  
2:00 o'clock P. M. and recorded in  
 Vol. Doris Verage Kuehn on page  
 Registrar

# CERTIFIED BOUNDARY LINE ESTABLISHMENT

Being the East Line SE 1/4 SE 1/4 Section 2, Township 38 North, Range 11 East, 4th P.M.  
 County of Oneida, State of Wisconsin

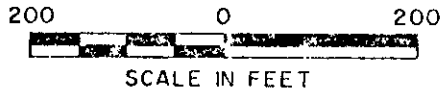

### SURVEY NOTES

This survey of the east line SE 1/4 SE 1/4 of section 2, township 38 north, range 11 east, fourth principal meridian, was made by the U.S. Department of Agriculture, Forest Service.

The purpose of this survey is to locate and mark the east line SE 1/4 SE 1/4 and to locate an existing building in relation to this line.

The U.S. Government acquired title to the SE 1/4 SE 1/4 of section 2 in 1931.

### LEGEND

- 1941 GLO Dependent Resurvey Monument
  - 2 inch I.D. by 5 foot long galvanized iron pipe capped with 3 inch brass tablet stamped to identify corner.
  - Line post
  - Building
- U.S.A. U.S. Government Land

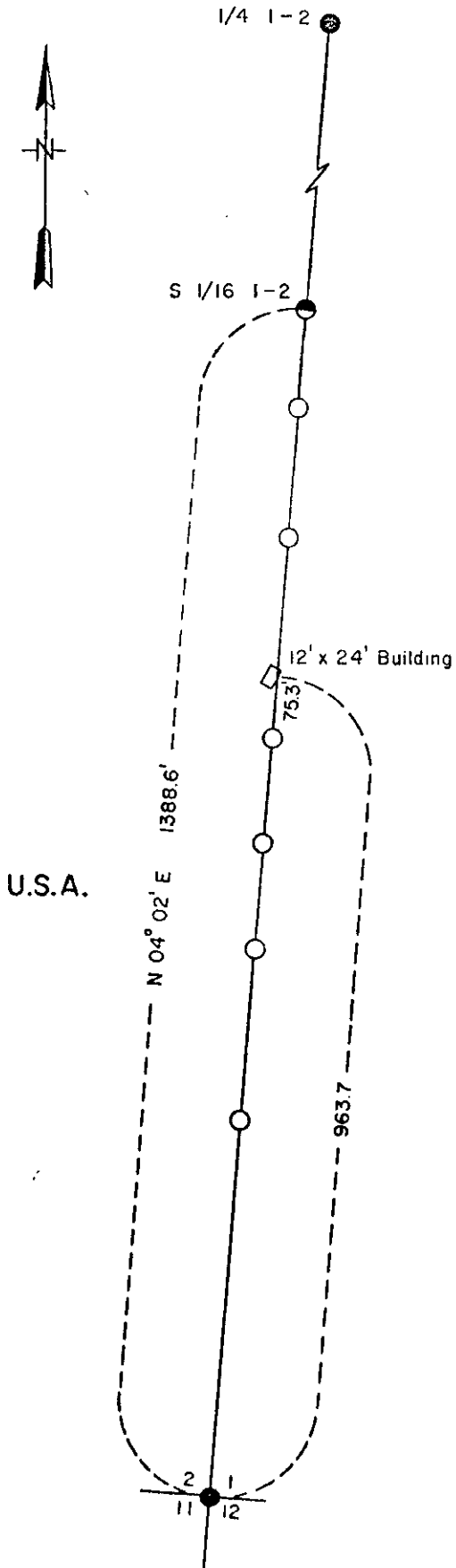

3811022000  
 3811021000  
 3811020000