

REGISTER'S OFFICE }
 Oneida County, Wis. }
 Received for Record the 12th day of
January A. D. 1916 at
2:00 o'clock P. M. and recorded in
 Vol. Doris Verage Kuehn on page
 Register

CERTIFIED BOUNDARY LINE ESTABLISHMENT

Being the East Line SE 1/4 SE 1/4 Section 2, Township 38 North, Range 11 East, 4th P.M.
 County of Oneida, State of Wisconsin

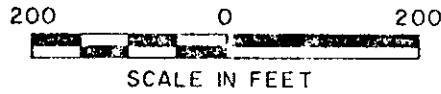

SURVEY NOTES

This survey of the east line SE 1/4 SE 1/4 of section 2, township 38 north, range 11 east, fourth principal meridian, was made by the U.S. Department of Agriculture, Forest Service.

The purpose of this survey is to locate and mark the east line SE 1/4 SE 1/4 and to locate an existing building in relation to this line.

The U.S. Government acquired title to the SE 1/4 SE 1/4 of section 2 in 1931.

LEGEND

- 1941 GLO Dependent Resurvey Monument
 - 2 inch I.D. by 5 foot long galvanized iron pipe capped with 3 inch brass tablet stamped to identify corner.
 - Line post
 - Building
- U.S.A. U.S. Government Land

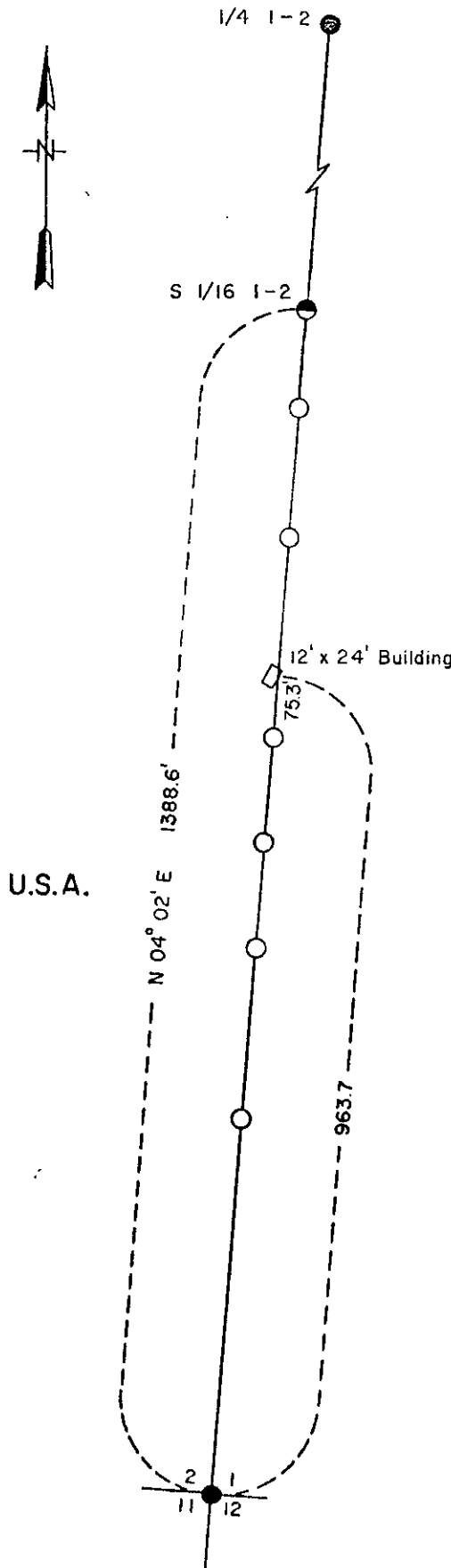

3811022000
 3811021000
 3811020000

C-21

U.S. PUBLIC LAND SURVEY MONUMENT RECORD

Index No. C 21

State of Wisconsin } ss.
County of Oneida

I, John H. Fisher, do hereby certify that on the 13 day of June, 1984, I found evidence of the quarter corner of Section 1 & 2 Township 38 North, Range 11 East, Fourth Principal Meridian, as described hereon; and that from this evidence I established a new monument and accessories as described hereon to perpetuate the original location of this corner.

Resident witnesses:

None

History of original corner establishment: Original survey in 1859 by Alfred Willard. Dependent Resurvey in 1941 by Hugh B. Crawford. At 42.06 chains set a concrete monument 24 inches long, 6 inches diameter, 20 inches in the ground with an iron post 23 inches long, 1 inch diameter embedded in center with a brass tablet stamped.
From which the following bear:

1/4	White Pine	7"	N47-1/2°E	71 lks
S 2 S 1	White Pine	10"	N 7-1/4°W	61 lks
1941				

Description of corner evidence found:
B.L.M. Monument as described and in place and the following bearing trees.

White Pine	20"	N 9°W	40.5 feet
Spruce	8"	N43°E	35.5 feet
Wood sign post		N45°E	1.7 feet

Description of monument and accessories I established to perpetuate the original location of this corner. Corner in good condition. Blazed and scribed the following new bearing trees.
Set nails in:

Spruce	6"	N13°E	16.3 feet
Spruce	5"	S42°E	5.1 feet

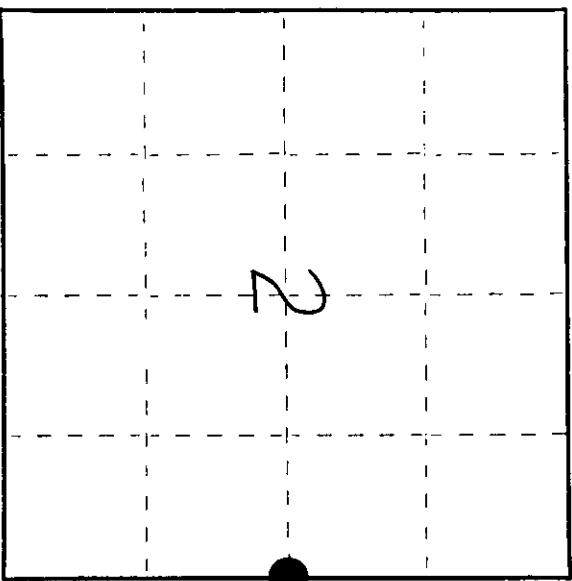

O = Corner monument restored.

Dated at Minocqua, Wis., this 21st day of March, 1985.

Signature: John H. Fisher, Title: Registered Land Surveyor, Registration No. S-836
(County Surveyor, Registered Land Surveyor, or other duly authorized official)

Office of Register of Deeds, County of Oneida, I hereby certify that the within instrument was filed in this office for record on the 23rd day of June, 1985 at 3:30 o'clock P.M.

By: Doris W. Kuehn, (Register of Deeds)

By: Deputy

(e) Describe any material discrepancy between the location of the corner as restored or reestablished and the location of that corner as previously restored or reestablished by distance and direction. Show the discrepancy on the plan view drawing under (d), above. Show the distances between the corner as previously restored or reestablished and (1) the corner as restored or reestablished, and (2) to at least 2 of the witness monuments shown on the drawing in (d), above.

See drawing below

(f) Was the corner restored through acceptance of (1) an obliterated evidence location, or, (2) a found perpetuated location?

Found perpetuated location

(g&h) Was the corner reestablished through lost corner proportionate methods? If so, show the method, including the directions and distances to other public land survey corners used as evidence or used for proportioning in determining the corner location?

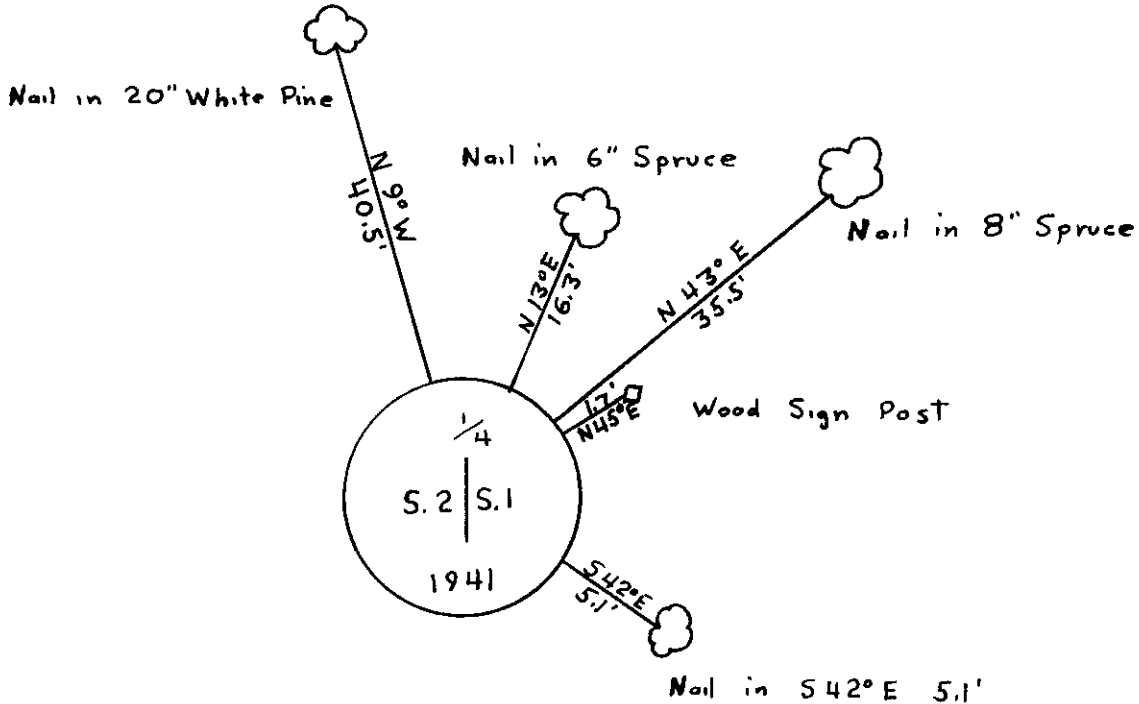

Affix Land Surveyor Seal

(1) I, John H. Fisher
 (type or print name) certify that the corner location shown on this record was determined by me or under my direction and control and that this U.S. Public Land Survey Monument Record is correct and complete to the best of my knowledge and belief.

John H. Fisher
 Signature

3/21/85
 Date