



Stock No. 26273

U.S. PUBLIC LAND SURVEY MONUMENT RECORD

Index No. N-23

State of Wisconsin

County of Oneida } ss.

I JAMES R. GROTHMAN, do hereby certify that on the 13th day of October, 1986, I found evidence of the One Quarter & Meander corner of Sections 13 and 24 Township 38 North, Range 11 East, Fourth Principal Meridian, as described hereon; and that from this evidence I established a new monument and accessories as described hereon to perpetuate the original location of this corner.

Resident witnesses:

NONE

History of original corner establishment: Original survey in 1859 by William E. Daugherty. Dependent resurvey in 1941 by Hugh B. Crawford. At 4.25 chains set a concrete monument 24 inches long, 6 inch diameter, 20 inches in the ground with an iron post 23 inches long, 1 inch diameter, embedded in the center with brass cap marked: S13 1/4 S24 MC From which the following bear:

| | | | | |
|------|------------|-----|-----------|---------|
| 1941 | White Pine | 8" | S36-1/4°W | 223 lks |
| 1941 | White Pine | 28" | N75-1/2°W | 383 lks |

Description of corner evidence found:

G.L.O. monument as described and in place. The following bearing trees:

| | | | |
|------------|-----|-----------|-------------|
| White Pine | 10" | S43-1/2°W | 147.58 feet |
| White Pine | 31" | N75°W | 254.56 feet |

Description of monument and accessories I established to perpetuate the original location of this corner.

Corner in good condition. Blazed, scribed, painted and posted all found bearing trees and the following new bearing trees:

| | | | |
|-----------------|-----|-----------|-------------|
| Balsam | 7" | S17°W | 43.62 feet |
| White Pine | 14" | N71°W | 111.70 feet |
| Steel sign post | | Northeast | 1.00 foot± |

Dated at Portage Wis., this 5 day of December, 1986

Signature: James R. Grothman, Title: Land Surveyor, Registration No. 1321

Office of Register of Deeds, County of Oneida, I hereby certify that the within instrument was filed in this office for record on the 19th day of December, 1986 at 10:00 o'clock M.

(Register of Deeds)

○ = Corner monument restored.

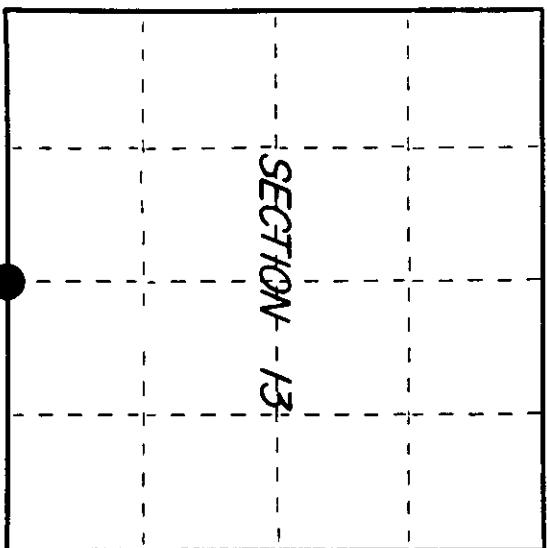

3811130020

(e) Describe any material discrepancy between the location of the corner as restored or reestablished and the location of that corner as previously restored or reestablished by distance and direction. Show the discrepancy on the plan view drawing under (d), above. Show the distances between the corner as previously restored or reestablished and (1) the corner as restored or reestablished, and (2) to at least 2 of the witness monuments shown on the drawing in (d), above.

See drawing below

(f) Was the corner restored through acceptance of (1) an obliterated evidence location, or, (2) a found perpetuated location?

Corner was restored through acceptance of a found perpetuated location.

(g&h) Was the corner reestablished through lost corner proportionate methods? If so, show the method, including the directions and distances to other public land survey corners used as evidence or used for proportioning in determining the corner location?

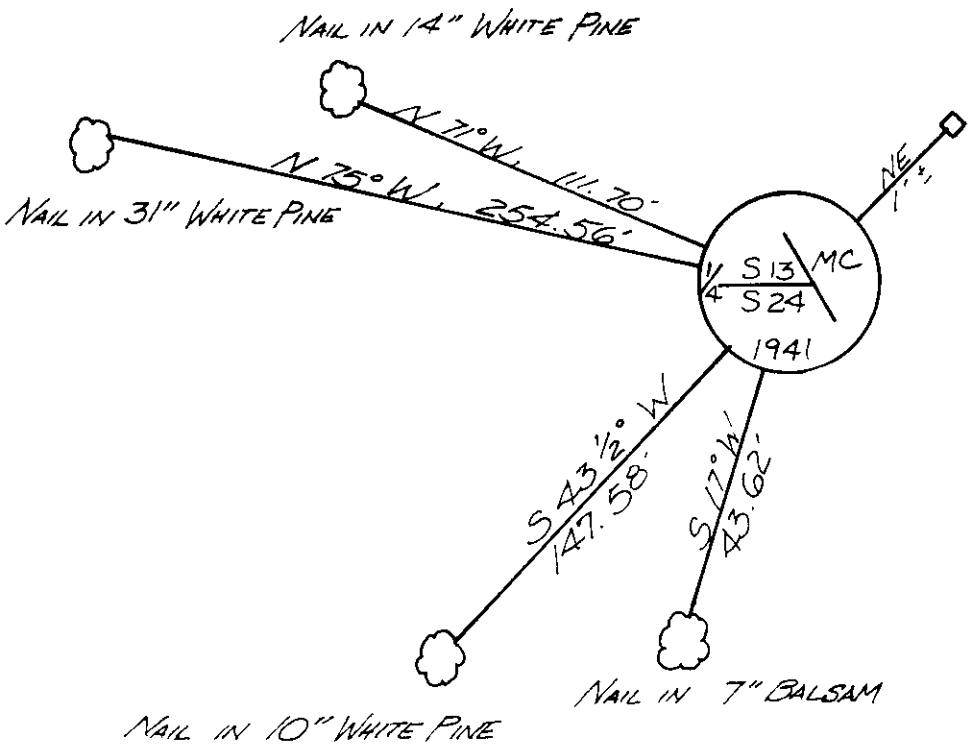

STEEL SIGN POST

REGISTER OF DEEDS OFFICE
ONEIDA COUNTY, WIS.
FILED
APR 8 1991
At _____ O'Clock _____ M
THOMAS H. LEIGHTON
REGISTER OF DEEDS

Affix Land Surveyor Seal

(i) I, JAMES R. GROTHMAN, Registered Land Surveyor No. 1321 (type or print name) certify that the corner location shown on this record was determined by me or under my direction and control and that this U.S. Public Land Survey Monument Record is correct and complete to the best of my knowledge and belief.

James R. Grothman 12/5/86
Signature Date

Certificate ready for filing: Frank Aubrey 1/6/87
District Ranger Date