



Stock No. 26273

U.S. PUBLIC LAND SURVEY MONUMENT RECORD

Index No. L-M-21-22

State of Wisconsin } ss.
County of Oneida }

I, JAMES R. GROTHMAN, do hereby certify that on the 13th day of October, 1986, I found evidence of the angle point 4 Meander corner of Section 13, Township 38 North, Range 11 East, Fourth Principal Meridian, as described hereon; and that from this evidence I established a new monument and accessories as described hereon to perpetuate the original location of this corner.

Resident witnesses:
None

History of original corner establishment. Original survey in 1859 by William E. Daugherty.

Establishment of recorded original meander line of Elm Lake in Section 13 as a fixed and limiting boundary in 1943 by Hugh B. Crawford. Set a concrete monument 2 feet long, 4 inch diameter, 20 inches in the ground with an iron post 2 feet long, 1 inch diameter embedded in the center with brass cap marked:

T38N
R11E AP 4 From which the following bear: Poplar 7" S86-1/4°E 56.5 lks
S13 513 Poplar 6" N72°45'W 28 lks
1943

Description of corner evidence found:

Found G.L.O. monumented as described in place. The following bearing trees:

Poplar stump N73°W
(Trunk lying down) White Birch 9" N72°E 53.61 feet

Description of monument and accessories I established to perpetuate the original location of this corner.

Corner in good condition. Blazed, scribed, painted, and posted found bearing tree and the following new bearing trees:

White Birch 8" S20°E 26.87 feet
White Birch 8" N85°W 59.72 feet
Steel sign post 1 foot easterly

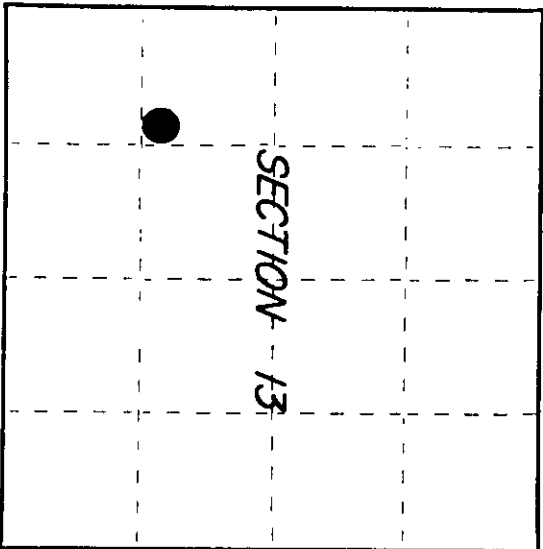

○ = Corner monument restored.

Dated at Paris Wis., this 3 day of October, 1986

Signature [Signature] Title ELS Registration No. 1321
(County Surveyor, Registered Land Surveyor, or other duly authorized official)

Office of Register of Deeds, County of _____ I hereby certify that the within instrument was filed in this office for record on the _____ day of _____, 19____ at _____ o'clock _____ M.

(Register of Deeds)

By _____ Deputy

381113/232

(e) Describe any material discrepancy between the location of the corner as restored or reestablished and the location of that corner as previously restored or reestablished by distance and direction. Show the discrepancy on the plan view drawing under (d), above. Show the distances between the corner as previously restored or reestablished and (1) the corner as restored or reestablished, and (2) to at least 2 of the witness monuments shown on the drawing in (d), above.

See drawing below

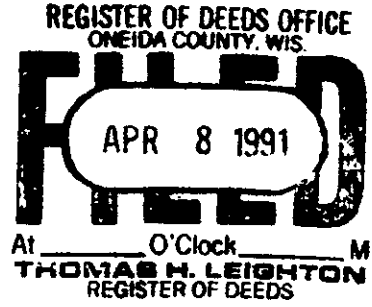

(f) Was the corner restored through acceptance of (1) an obliterated evidence location, or, (2) a found perpetuated location?

Corner was restored through acceptance of a found perpetuated location.

(g&h) Was the corner reestablished through lost corner proportionate methods? If so, show the method, including the directions and distances to other public land survey corners used as evidence or used for proportioning in determining the corner location?

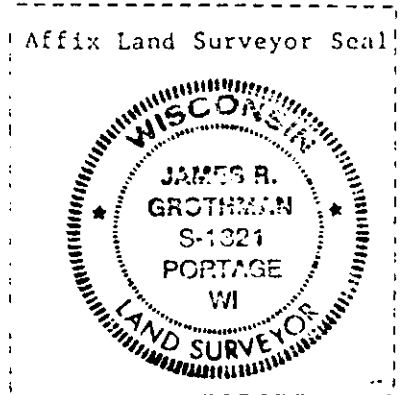
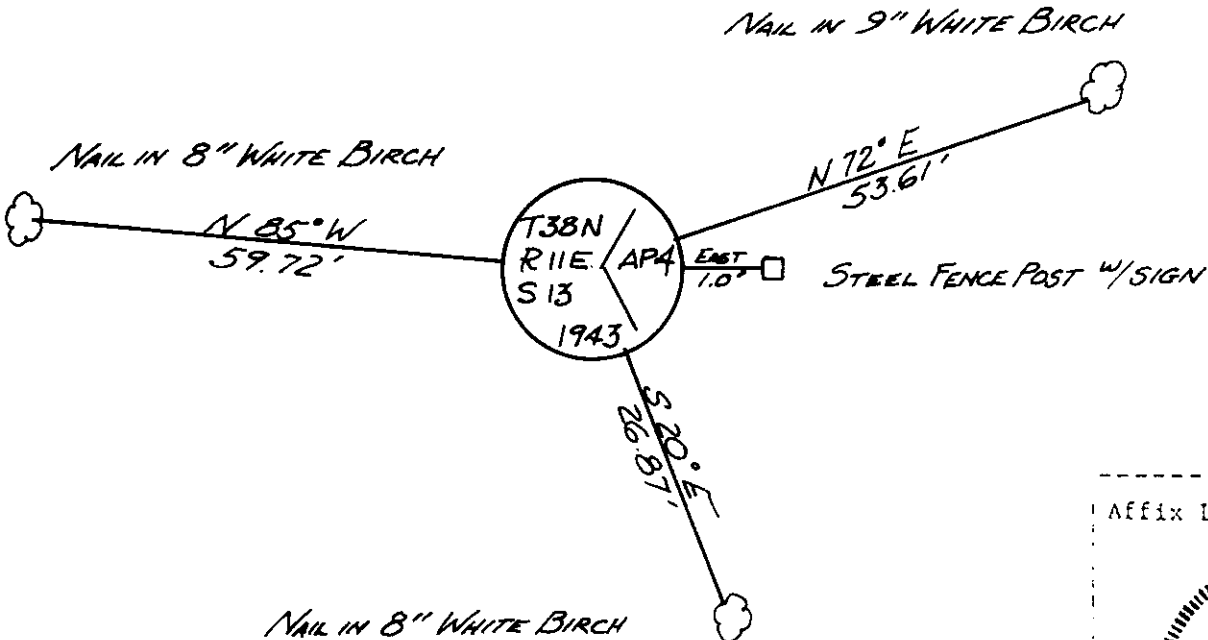

(*) I, JAMES R. GROTHMAN, Registered Land Surveyor No. 1321 (type or print name) certify that the corner location shown on this record was determined by me or under my direction and control and that this U.S. Public Land Survey Monument Record is correct and complete to the best of my knowledge and belief.

James R. Grothman 10/30/86
Signature Date

Certificate ready for filing: D. Frank Haubry 1/6/87
District Ranger Date