



Stock No. 26273

U.S. PUBLIC LAND SURVEY MONUMENT RECORD

Index No. I-M-22-23

State of Wisconsin } ss.
County of Oneida }

I JAMES R. GROTHMAN, do hereby certify that on the 13th day of October, 1986, I found evidence of the Angle Point S. Meander corner of Section 13, Township 38 North, Range 11 East, Fourth Principal Meridian, as described hereon; and that from this evidence I established a new monument and accessories as described hereon to perpetuate the original location of this corner.

Resident witnesses:
None

History of original corner establishment. Original survey in 1859 by William E. Daugherty. Establishment of recorded original meander line of Elm Lake in Section 13 as a fixed and limiting boundary in 1943 by Hugh B. Crawford. Set an iron post 3 feet long, 1 inch diameter, 27 inches in the ground with brass cap marked;

T38N	AP5	From which the following bear:		
R11E	Cedar	5"	S3°45'E	43 lks.
S13W	Tamarack	4"	N81°45'W	28 lks
	1943			

Description of corner evidence found:

G.L.O. monument as described in place.	The following bearing trees:		
Lamarack	6"	N60°E	4.52 feet
Cedar	10"	S7°E	28.30 feet
Tamarack	6"	N87°W	18.67 feet

Description of monument and accessories I established to perpetuate the original location of this corner. Corner in good condition. Blazed, scribed, painted and posted all found bearing trees. Set steel post 1 foot southeasterly.

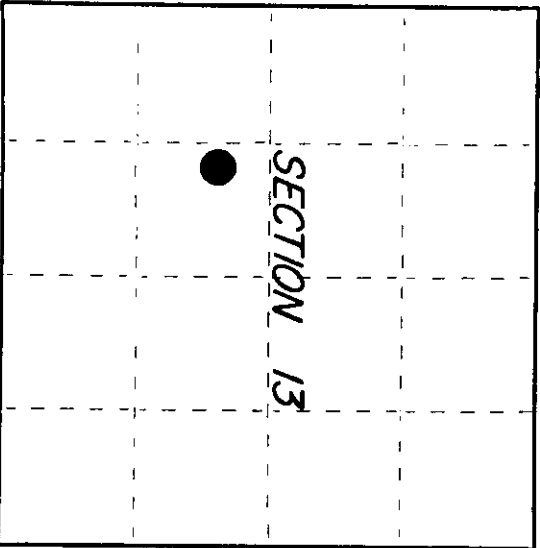

○ = Corner monument restored.

Dated at Portage Wis., this 30 day of October, 1986.
Signature [Signature] Title RLS
(County Surveyor, Registered Land Surveyor, or other duly authorized official)
Office of Register of Deeds, County of Portage Registration No. 1321
Instrument was filed in this office for record on the 30 day of October, 1986 at 11 o'clock M. I hereby certify that the within

(Register of Deeds)

By [Signature] Deputy

381131627

(e) Describe any material discrepancy between the location of the corner as restored or reestablished and the location of that corner as previously restored or reestablished by distance and direction. Show the discrepancy on the plan view drawing under (d), above. Show the distances between the corner as previously restored or reestablished and (1) the corner as restored or reestablished, and (2) to at least 2 of the witness monuments shown on the drawing in (d), above.

See drawing below

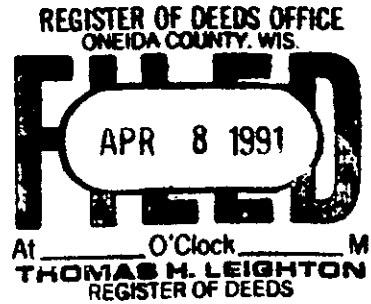

(f) Was the corner restored through acceptance of (1) an obliterated evidence location, or, (2) a found perpetuated location?

Corner was restored through acceptance of a found perpetuated location.

(g&h) Was the corner reestablished through lost corner proportionate methods? If so, show the method, including the directions and distances to other public land survey corners used as evidence or used for proportioning in determining the corner location?

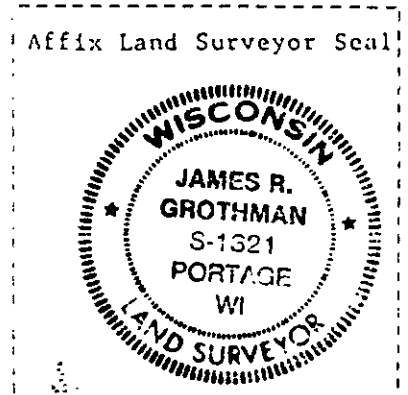
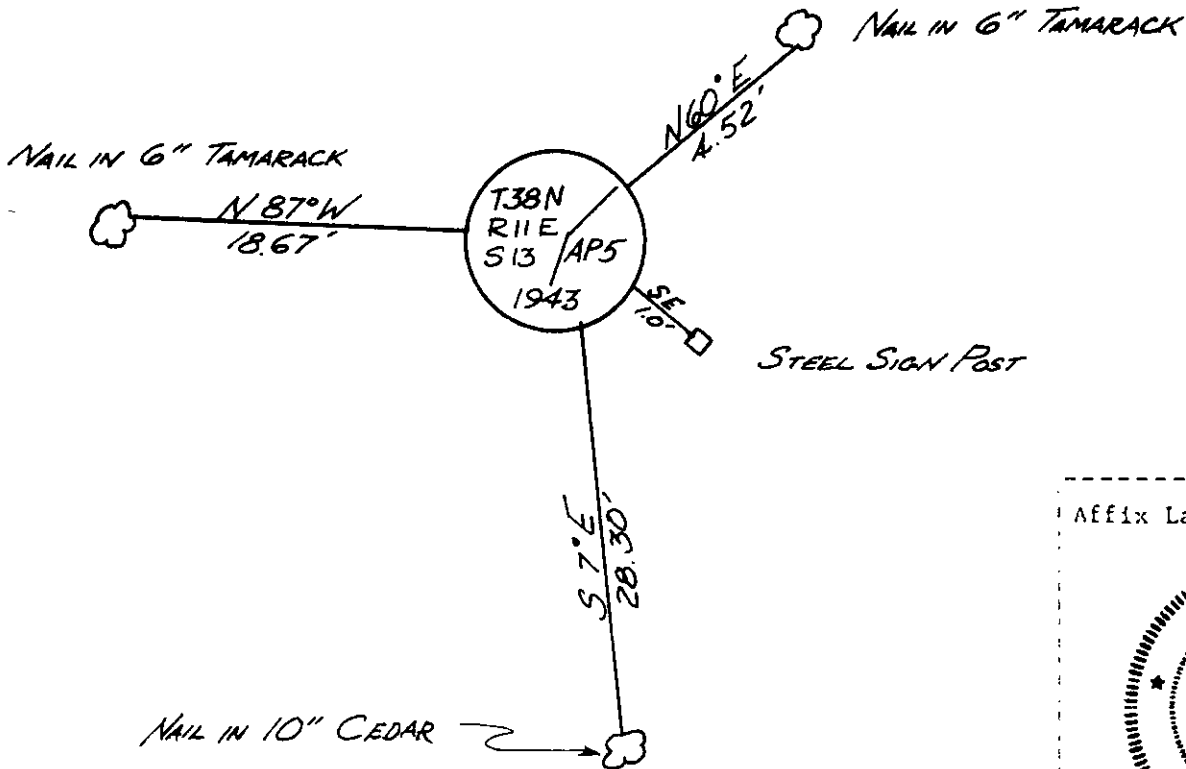

(i) I, JAMES R. GROTHMAN, Registered Land Surveyor No. 1321 (type or print name; certify that the corner location shown on this record was determined by me or under my direction and control and that this U.S. Public Land Survey Monument Record is correct and complete to the best of my knowledge and belief.

James R. Grothman 10/30/86
 Signature Date

Certificate ready for filing: *N. Frank Haubry* 1/6/87
 District Ranger Date