

At _____ M
THOMAS H. LEIGHTON
REGISTER OF DEEDS

Recorders Data

This form is intended to fulfill the requirements of Chapter A-E7.08 (3)(a) thru (i) U.S. Public Land Survey Monument Location Record, Wisconsin Administrative Code. Use the reverse side of form for continuation.

U.S. PUBLIC LAND SURVEY MONUMENT LOCATION RECORD

USPLS CORNER: WEST WIT MC SECTION: 22 TOWNSHIP: 38 NORTH RANGE: 11 EAST
 NAME OF WATERWAY FOR M.C. CORNER : THE THOROUGHFARE SECTION LINE: NORTH
 (CITY)(VILLAGE)(TOWN) OF: THREE LAKES COUNTY OF: ONEIDA

Description of monument found or placed and all other evidence used as the basis for monument location; including monuments and measurements required if the corner location was reestablished by lost corner proportionate methods. Also indicate name of the original surveyor, original survey date and the corner monument, bearing trees, witness or other reference monuments established, including measured bearing and distance ties, from available survey records.

Found an old 1.5" dia. iron pipe with uncapped top tipped 45°+ West, undoubtedly due to wave and ice action over many years, about 2.5' West of brushy lakeshore bearing S40°E on the East edge of lake frontage lot at 910 Staehling Road; upon replumbing and pulling the 44" long old iron pipe, probing revealed the rust scaled original plumb iron pipe soil cavity, into which I drove a standard 2" dia. by 30" long aluminum pipe monument with stamped Oneida County cap 3" up.

In September 1859, William E. Daugherty noted no wood MC post set or OBTs per original survey notes, as only a marsh had been traversed along the section line.

In November 1949, F.R. Wincentsen/RLS 155 notes this MC as an iron pipe by symbol similarity on Plat of Survey filed as B-1332 in Oneida County survey records.

In July 1979, Jim Will/RLS 1410 notes this corner as a 1.25" dia. iron pipe in place per Plat of Survey filed as B-563 in Oneida County survey records and also notes this corner as a 1.25" dia. iron pipe found in place per following maps filed in Oneida County records: Volume 3 of Certified Survey Maps Page 745 dated August 1979 and Volume 4 of Certified Survey Maps Page 1136 dated April 1985. In September 1990, Todd Loftus/RLS 1523 also notes this corner as an iron pipe per Plat of Survey filed as C-767 in Oneida County survey records.

This recovery completed July 21, 2003; there were no direct witnesses.

Plan view map of monument location with bearing and distance ties to a minimum of four(4) described witness or reference monuments of concrete, natural stone, iron, live bearing trees or equivalent material. If applicable, also show a minimum of two(2) bearing and distance ties to any other monument found and not accepted; including the bearing and distance from the accepted monument.

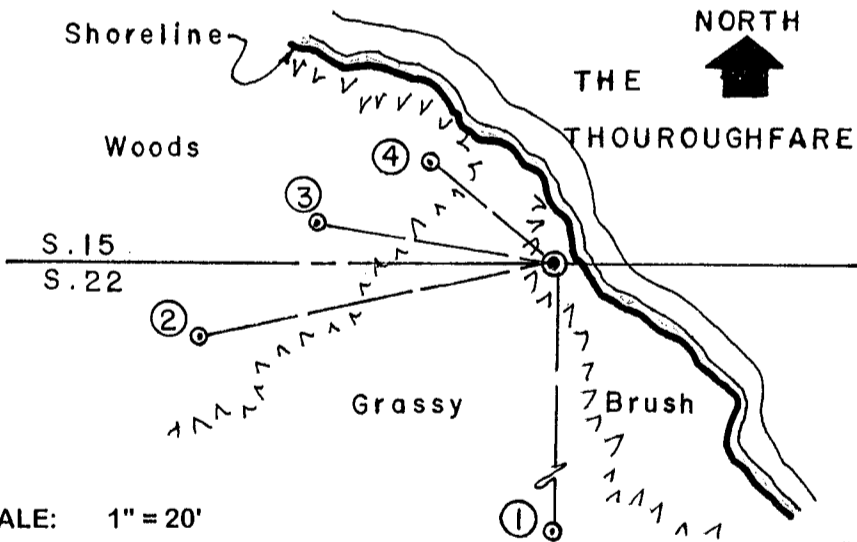

WITNESS MONUMENT TIES:

- ① New 9" Sb BT South 30.70'.
- ② New 12" Pr BT S78°W 37.49'.
- ③ New 10" Hemlock BT N80°W 25.04'.
- ④ New 8" Hemlock BT N50°W 16.56'.

Standard white poly 'T' corner marker post set 8" East of new monument.

No older BTs noted nearby.

Also found a 3/4" dia. iron rod, of no apparent record, tipped 30°+ West at N20°W 1.5' from corner monument set.

SCALE: 1" = 20'

Unless otherwise indicated, all bearing tree ties are to a .25" dia. by 2.5" long PK nail with a 1.25" dia. steel washer driven into unblazed right face and a .25" dia. by 2.5" long PK nail with a 2" dia. steel washer stamped BT is also driven into unblazed face of bearing tree at DBH; the basis for measured bearings is by compass to nearest degree and all tie distances are measured horizontal by steel tape corrected to nearest 1/100th feet at standard temperature of 68° F.

RLS SEAL:

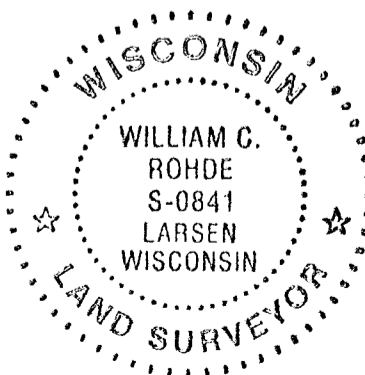

LAND SURVEYOR CERTIFICATE:

I, William C. Rohde, hereby certify that I am duly licensed as a Professional Land Surveyor in the State of Wisconsin; that this USPLS monument location was determined by me and/or under my direct supervision and control; and that this U.S. Public Land Survey Monument Location Record is true and correct to the best of my knowledge and belief.

Signed: *William C. Rohde*
 William C. Rohde RLS 841

Date Signed: August 29, 2003

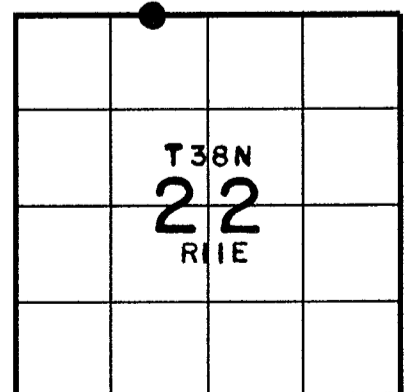

SECTION LOCATION MAP
 INDEX NO. N-14/15

3811150026