

This form is intended to fulfill the requirements of Chapter A-E7.08 (3)(a) thru (i) U.S. Public Land Survey Monument Location Record, Wisconsin Administrative Code. Use the reverse side of form for continuation.

U.S. PUBLIC LAND SURVEY MONUMENT LOCATION RECORD

Recorders Data

USPLS CORNER: WEST WIT MC SECTION: 21 TOWNSHIP: 38 NORTH RANGE: 11 EAST
 NAME OF WATERWAY FOR M.C. CORNER : BIG LAKE SECTION LINE: NORTH
 (CITY)(VILLAGE)(TOWN) OF: THREE LAKES COUNTY OF: ONEIDA

Description of monument found or placed and all other evidence used as the basis for monument location; including monuments and measurements required if the corner location was reestablished by lost corner proportionate methods. Also indicate name of the original surveyor, original survey date and the corner monument, bearing trees, witness or other reference monuments established, including measured bearing and distance ties, from available survey records.

In September 1859, William E. Daugherty/GLO did not set a wood post as MC at this location per his record field notes, as the lake has been impounded since by a dam on the Eagle River in Section 5.

Found an older 3/4" dia. iron pipe with uncapped top 9" above lake level and tipped 15° +/- North against the existing lake bank; I carefully pulled the 24" long iron pipe from the sandy lake bed and replaced it with an older 3/4" dia. by 48" long iron pipe, found flat nearby, with uncapped top 7" above lake level and 6" +/- South of existing East/West lake bank. Also found a highly probable soil cavity for an iron pipe by probing, which fell N45°E about 7 feet from the iron pipe found at record Wit MC location, as noted on Plat of Survey by Robert Bandow/RLS 104 in September 1960 and filed as C-576 in Oneida County survey records. I further verified the soil cavity location by distance measurement along the lakeshore of 106 feet from an older tipped iron pipe found East per the Plat of Survey by Bandow.

As the existing lake bank evidenced berming from previous lake wave and ice action, I set a standard 2" dia. by 30" long aluminum pipe monument with stamped Oneida County cap 3" up as a reference monument 7.50' North onto upland lake bank from the iron pipe at the Wit MC in lake, and measured ties to both monuments as indicated below. I also set a 5/8" dia. by 24" long rebar in the soil cavity found at N45°E 7.10' from the record Wit MC location in lake and set a standard white poly 'T' marker post 6" North of the aluminum reference monument set.

This recovery completed August 12, 2003 and directly witnessed by adjoining owner of improved lake lot NE.

Plan view map of monument location with bearing and distance ties to a minimum of four(4) described witness or reference monuments of concrete, natural stone, iron, live bearing trees or equivalent material. If applicable, also show a minimum of two(2) bearing and distance ties to any other monument found and not accepted; including the bearing and distance from the accepted monument.

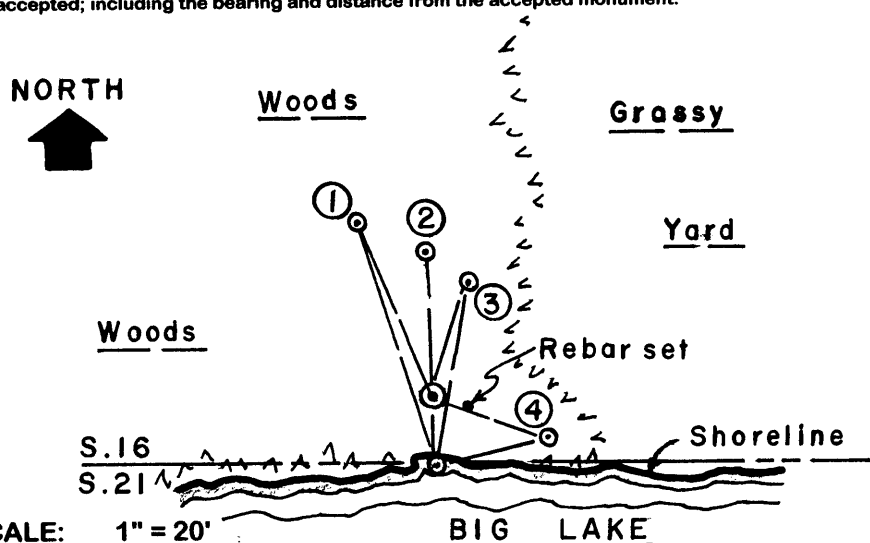

WITNESS MONUMENT TIES:

- ① New 7.5" Mr BT N17°W 26.82' from Wit MC in lake and N21°W 19.65' from reference monument set.
- ② New 6" Bw BT N02°W 22.46' from Wit MC in lake and N02°W 14.92' from reference monument set.
- ③ New 8" Spruce BT N10°E 19.32' from Wit MC in lake and N17°E 12.05' from reference monument set.
- ④ New 8" Spruce BT N76°E 12.32' from Wit MC in lake and S71°E 12.56' from reference monument set.

Note:
 Rebar set as noted above is 7.10' from Wit MC iron pipe in lake and 3.85' from aluminum reference monument set.

SCALE: 1" = 20'

Unless otherwise indicated, all bearing tree ties are to a .25" dia. by 2.5" long PK nail with a 1.25" dia. steel washer driven into unblazed right face and a .25" dia. by 2.5" long PK nail with a 2" dia. steel washer stamped BT is also driven into unblazed face of bearing tree at DBH; the basis for measured bearings is by compass to nearest degree and all tie distances are measured horizontal by steel tape corrected to nearest 1/100th feet at standard temperature of 68° F.

RLS SEAL:

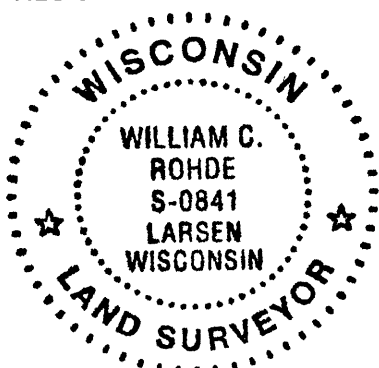

LAND SURVEYOR CERTIFICATE:

I, William C. Rohde, hereby certify that I am duly licensed as a Professional Land Surveyor in the State of Wisconsin; that this USPLS monument location was determined by me and/or under my direct supervision and control; and that this U.S. Public Land Survey Monument Location Record is true and correct to the best of my knowledge and belief.

Signed: *William C. Rohde*
 William C. Rohde RLS 841

Date Signed: December 1, 2003

		T 38N	
		21	
		R 11E	

SECTION LOCATION MAP
 INDEX NO. N 11-12