

This form is intended to fulfill the requirements of Chapter A-E7.08 (3)(a) thru (i) U.S. Public Land Survey Monument Location Record, Wisconsin Administrative Code. Use the reverse side of form for continuation.

**U.S. PUBLIC LAND SURVEY MONUMENT LOCATION RECORD**

USPLS CORNER: SOUTH WITNESS MC SECTION: 16 TOWNSHIP: 38 NORTH RANGE: 11 EAST  
 NAME OF WATERWAY FOR M.C. CORNER : CRYSTAL LAKE SECTION LINE: WEST  
 (CITY)(VILLAGE)(TOWN) OF: THREE LAKES COUNTY OF: ONEIDA

Description of monument found or placed and all other evidence used as the basis for monument location; including monuments and measurements required if the corner location was reestablished by lost corner proportionate methods. Also indicate name of the original surveyor, original survey date and the corner monument, bearing trees, witness or other reference monuments established, including measured bearing and distance ties, from available survey records.

Found and accepted a secure old 3/4" dia. iron pipe as this Witness MC with uncapped top 2" above existing bog surface within a clump of alders at the lake shoreline bearing N35°E; the corner is SW of the NW corner of Lot 33 of Crystal Lake Forest Plat at Fire No. 6473 Maywood Lane. I also found an old 'T' steel fence post 2" SW of iron pipe. I left iron pipe in place and drove a standard 2" dia. by 30" long aluminum pipe monument with stamped Oneida County cap over it to 14" above bog due to rooting, and piled broken pieces of old concrete block as a cairn around the monument to secure.

In August-September 1859, William E. Daugherty/GLO set a wood post as the original corner and noted OBTs: an 8" Bw S15°E 60 links and a 9" Pine S18°W 90 links; all are now obliterated.

In September 1963, Forrest R. Wincentsen/RLS 155 notes an iron pipe at this Witness MC per Pages 218 & 219 of Wincentsens Book 1 in Oneida County survey records. In August 1970, W.J. Woodward/RLS 506 notes an iron pipe at this Witness MC per Plat of Crystal Lake Forest Plat filed in Cabinet 2 Sheet 193 of Oneida County records. In August 1981, James L. Will/RLS 1410 notes a 1" iron pipe at this Witness MC per plat of survey filed as B-1099 in Oneida County survey records. In January 1995, James L. Will/RLS 1410 notes a 1" iron pipe at this Witness MC per plat of survey filed as L-1381 in Oneida County survey records.

This recovery completed August 3, 2004 and witnessed directly by adjoining owner spouse Gloria Coenen.

Plan view map of monument location with bearing and distance ties to a minimum of four(4) described witness or reference monuments of concrete, natural stone, iron, live bearing trees or equivalent material. If applicable, also show a minimum of two(2) bearing and distance ties to any other monument found and not accepted; including the bearing and distance from the accepted monument.

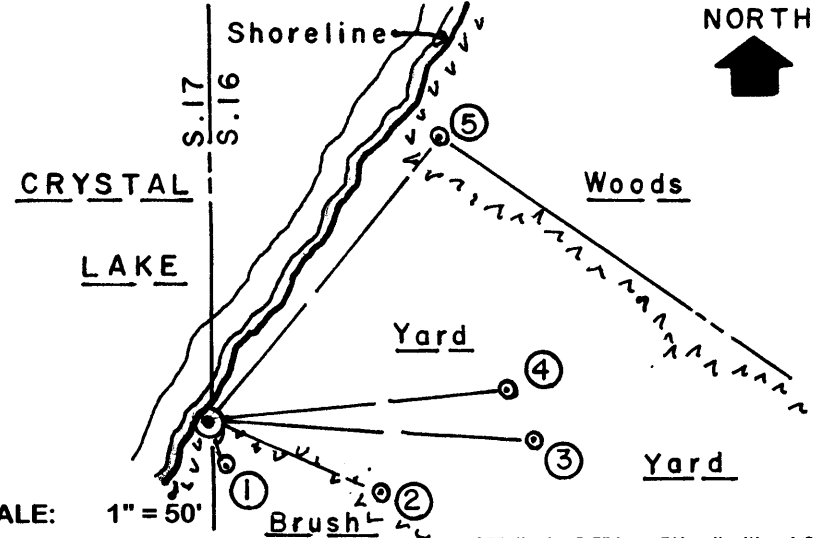

- WITNESS MONUMENT TIES:**
- ① New 4.5" Mr BT S22°E 12.91'.
  - ② New 9" Fir BT S67°E 49.00'.
  - ③ New 13" Mr BT S86°E 84.28' to PK & washer in left face.
  - ④ SW trunk of twin New 16" Mr BT N84°E 77.73'.
  - ⑤ Old 2" dia. iron pipe found flush in woods at NW corner of subject Lot 33 N39°E 96.10'.
- I set a standard white poly 'T' marker post along South side of new monument.

Unless otherwise indicated, all bearing tree ties are to a .25" dia. by 2.5" long PK nail with a 1.25" dia. steel washer driven into unblazed right face and a .25" dia. by 2.5" long PK nail with a 2" dia. steel washer stamped BT is also driven into unblazed face of bearing tree at DBH; the basis for measured bearings is by compass to nearest degree and all tie distances are measured horizontal by steel tape corrected to nearest 1/100th feet at standard temperature of 68° F.

RLS SEAL:



LAND SURVEYOR CERTIFICATE:

I, William C. Rohde, hereby certify that I am duly licensed as a Professional Land Surveyor in the State of Wisconsin; that this USPLS monument location was determined by me and/or under my direct supervision and control; and that this U.S. Public Land Survey Monument Location Record is true and correct to the best of my knowledge and belief.

Signed: *William C. Rohde*  
 William C. Rohde RLS 841

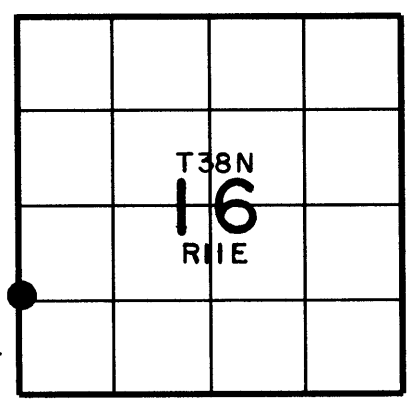

38117100