

CERTIFIED LAND CORNER RESTORATION

State of Wisconsin }
County of Oneida } ss.

I James F. Kasson, do hereby certify that on the 17th day of September, 1980, I found evidence of the west one-quarter corner of Section 17 Township 38 North, Range 11 East, Fourth Principal Meridian, as described hereon; and that from this evidence I established a new monument and accessories as described hereon to perpetuate the original location of this corner:

Description of original monument and accessories and subsequent restorations:

Wood post
Bt 5 1/2" Fir N10W 10 links
8" " N30E 8 links

Description of corner evidence found:

Town Road north-south, very old fence line running East.

Description of monument and accessories I established to perpetuate the location of this corner:

Oneida County monument stamped 1/4 Cor. 18/17.
Bearing trees:
6" Spruce, N57°W, 11.38'
4" Spruce S32°W, 21.0'
5" Spruce S10E, 56.81'

Sec. 17

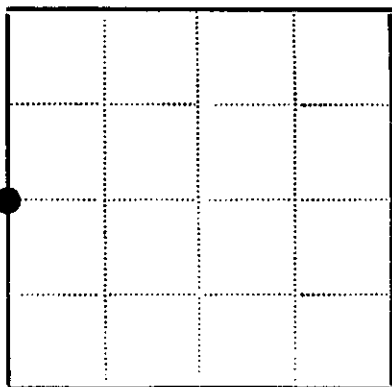

● - Corner monument restored
□ -

Resident witnesses Steve Wykowski

Dated at Rhinelander Wisconsin, this 19th day of Sept 1980.

Signature James F. Kasson Title ZLS 1416
(County Surveyor, Registered Land Surveyor, or other duly authorized official)

Surveyors Registration No.

Office of Reg. of Deeds County of Oneida

I hereby certify that the within instrument was filed in this office for record on the 23 day of June 1986 and was filed in Book No. of County Records.

Signature Doris Verge Title Reg. of Deeds
Cynthia A. Hills, Deputy

Township, Range, Section, Index No., Page No.

7-02

JUN 12 2023

KYLE J. FRANSON
REGISTER OF DEEDS

U.S. PUBLIC LAND SURVEY MONUMENT RECORD

This form is intended and designed to fulfill all requirements of Wisconsin Administrative Code, Chapter A-E 7.08 U.S. Public Land Survey Monument Record (3) (a)(b)(c)(d)(e)(f)(g)(h)(i). An additional sheet may be added if necessary to confirm with said requirements.

(a) Corner Location:

E 1/4 Corner Section 18
Township 38 North
Range 11 East
Town of Three Lakes
County of Oneida

Corner ID: 3811182000

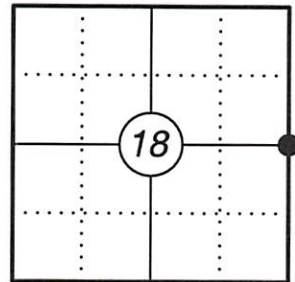

(b) History of Original Corner:

Original Surveyor: William Daugherty Original B.T.'s: 10" Fir N10°W 10 lks
8" Fir N30°E 8 lks
Date of Survey: Aug - Sept 1859

(f)(g)(h) Description of monument found at this corner and if it was accepted, state all evidence (material, testimonial, occupational, plats, records, other monuments) used as a basis for establishing location. If reestablishing through lost corner proportionate methods, indicate all monuments, distances, and directions used to establish. Indicate type of monument and sign post found or set.

See previous U.S. Public Land Survey Monument Record by James Kasson dated Sept 19th, 1980.

1990 - 2019 Kip Soder maps filed as OC Survey Map # B2270 dated 12/05/1990 & A1228 dated 03/10/2003 found Oneida County Monument in place. Kip Soder's CSM# 4727 dated 06/25/2018 & CSM# 4925 dated 12/05/2019 also indicates monument in place.

04/11/2023 I searched for the Oneida County Monument Kasson set and did not find it. I established the corner using the Oneida County published coordinates, and found two of Kasson's bearing tree remains, a stump N59°W 11.6' and a dead bearing tree stub S20°W 20.7' from the published coordinate location. I felt the published coordinate position was the best evidence to reset the corner since the BT's did not have fixed objects to measure from. This position also fits well with the surveys of record. I set an Oneida County Aluminum capped monument for the corner and made four new references as shown below. While setting the monument, I found an iron pipe of unknown origin approximately 2 1/2' below surface S66°E 0.6' from the monument.

(c)(d)(e) Plan view of corner with ties to at least four witnesses. If in disagreement with previously established corner, show the distances between the two corners and also indicate the tie to the disputed corner.

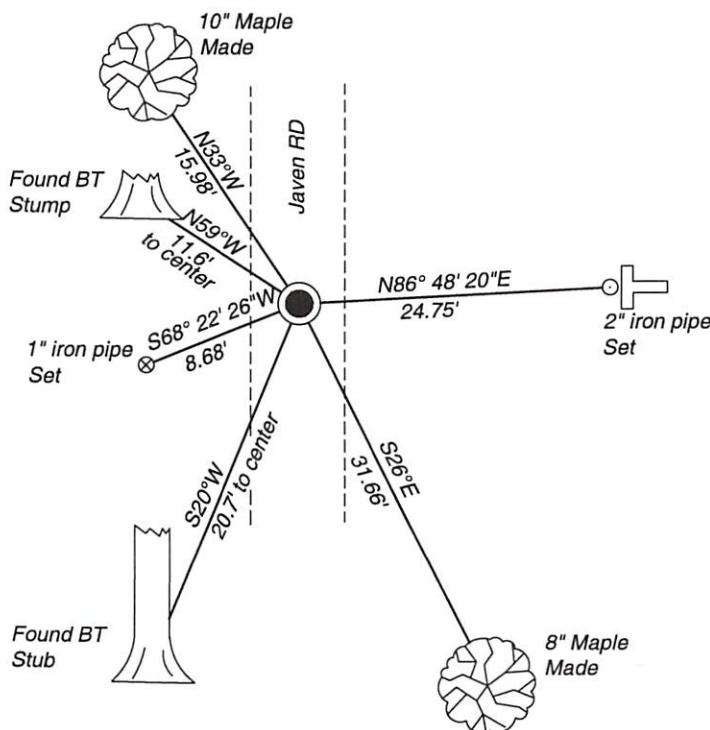

Oneida County Grid or
Magnetic Bearings
Not to scale

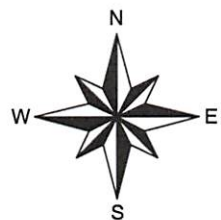

* Vinyl "T" post set near the 2" iron pipe

* Distances to bearing trees are to nail in side.



Certification

I, Gregory S. Maines, Professional Land Surveyor No. 2729, hereby certify that the corner location on this record was referenced by me or under my direction and control and that this U.S. Public Land Survey Monument Record is complete to the best of my knowledge and belief.
REF: 2022200

Index No.: L-5