

CERTIFIED LAND CORNER RESTORATION

Index No. Y-7

State of Wisconsin

County of Oneida } ss.

History of original corner establishment:

I Gerald B. Inman, do hereby certify that on the 26th day of August, 1980, I found evidence of the North 1/4 corner of Section 32 Township 38, North, Range 11 East, Fourth Principal Meridian, as described hereon; and that from this evidence I established a new monument and accessories as described hereon to perpetuate the original location of this corner.

Wood Post set by Alfred Millard on June 30, 1857.  
Bearing trees  
8" Tamarack S15°E 17 links  
6" Tamarack N45°W 6 links

Description of corner evidence found:

None

Resident witnesses:

Robert W. Conner

Neil Peters

Description of monument and accessories I established to perpetuate the original location of this corner.

60" Bernstein Aluminum monument  
Bearing trees

PK nail in 6" Cedar N55°W, 13.9 feet  
PK nail in 5" Cedar S50°W, 14.5 feet  
PK nail in 4" Cedar S41°E, 10.3 feet

Corner location determined by single proportion.

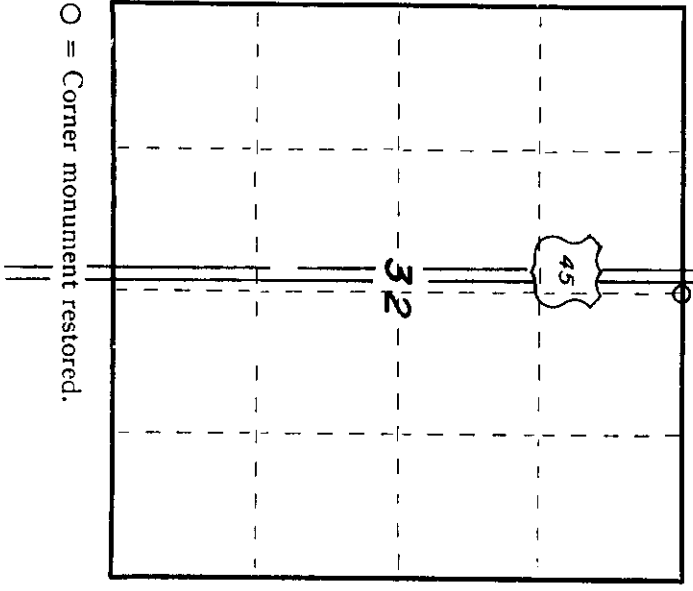

Dated at Minocqua, Wis., this 2nd day of September, 1980.

Signature [Signature] Title Registered Land Surveyor Registration No. S-891  
(County Surveyor, Registered Land Surveyor, or other duly authorized official)

Office of Register of Deeds, County of Oneida  
Instrument was filed in this office for record on the 12 day of June, 1980  
at 8:00 o'clock A. M.

I hereby certify that the within

By Doris Dorag Krumm Register of Deeds  
[Signature] Deputy