

CERTIFIED LAND CORNER RESTORATION

History of original corner establishment:  
Corner established by U.S.G.L.C.

State of Wisconsin } ss.  
County of Oneida }

I Philip T. Hansen, do hereby certify that on the 12th day of December, 1978, I found evidence of the Quarter corner of Sections 34 and 3 Township 38-37, North, Range 11 East, Fourth Principal Meridian, as described hereon; and that from this evidence I established a new monument and accessories as described hereon to perpetuate the original location of this corner.

Resident witnesses:

Glen Barker  
Jim Claffin

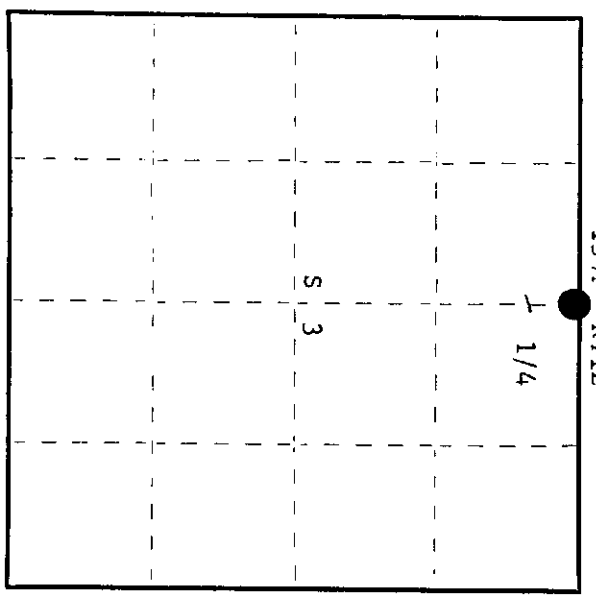
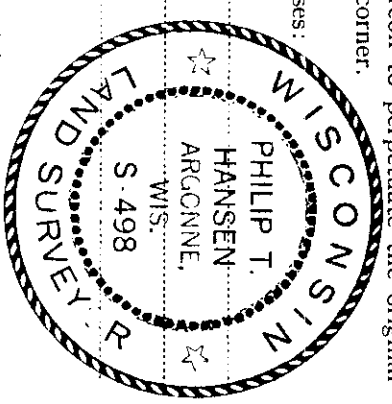

○ = Corner monument restored.

Description of corner evidence found:

Recovered U.S.G.L.C. 2" iron pipe with 2 1/2" brass cap, projecting 8" above ground.

Cap stamped:

There is also a 1 1/2" well point standing beside it.  
No evidence of any old BT's recovered. Area has been logged off.

U.S. Gen Land Office  
1/4 S 34  
S 3

Description of monument and accessories I established to perpetuate the original location of this corner.  
Left monument in place as recovered. Painted the monument and well pipe blue.

- Marked NBT's - Maple 8" S35°W 36.05 links
- Maple 8" S61°E 79.2 links
- Maple 8" N84°W 55.1 links
- W. Birch 10" N13°W 51.1 links
- all scribed 1/4 BT.

Dated at Rhineland, Wis., this 18th day of December, 1978.

Signature: *Philip T. Hansen* Title: Registered Land Surveyor Registration No. S-498  
County Surveyor, Registered Land Surveyor, or other duly authorized official

Office of Register of Deeds, County of Oneida  
Instrument was filed in this office for record on the 17th day of September, 1979  
at 10:50 o'clock M.

Signature: *Doris George Fischer*  
(Register of Deeds)

By: \_\_\_\_\_ Deputy