

CERTIFIED LAND CORNER RESTORATION

Index No. A-21

State of Wisconsin

County of Oneida

ss.

I Philipp T. Hansen, do hereby certify that on the 15th day of January, 1978, I found evidence of the Section corner of Secs. 35, 36, 1 & 2 Township 38 - 37, North, Range 11 East, Fourth Principal Meridian, as described hereon; and that from this evidence I established a new monument and accessories as described hereon to perpetuate the original location of this corner.

Resident witnesses:

Glen Barker

Jim Clafflin

Herb Wagoner

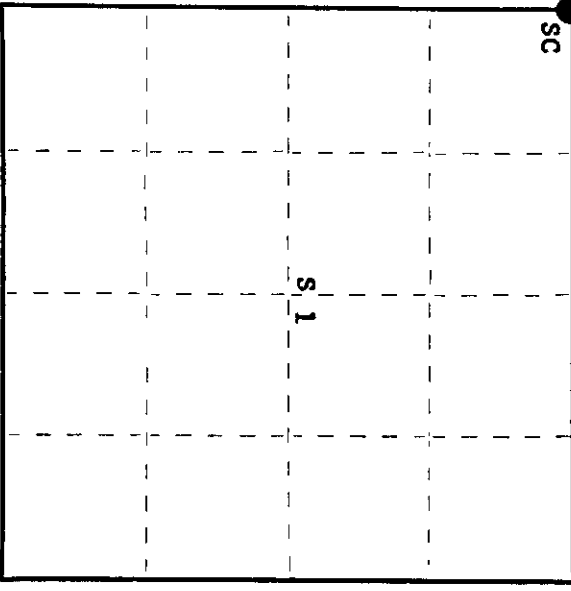
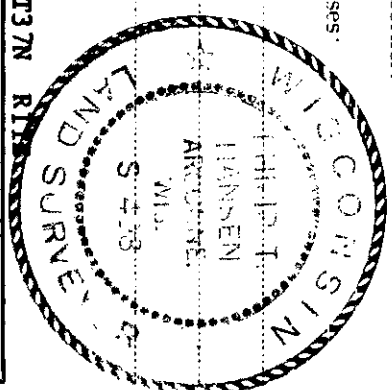

○ = Corner monument restored.

History of original corner establishment:

Original corner established by Hiram C. Fellows, Deputy Surveyor, in 1859 from which Spruce 8" bears N 73° W, 13 links; Spruce 10" bears N 53° E, 13 links; Spruce 10" bears S 71° E, 14 links and Spruce 8" bears S 25° W, 13 links. V.M. Maine, County Surveyor, recovered points of three old stakes and identified original BT in 1935. Set new iron pipe and marked NBT's - Cedar 10" S 60° E, 22 1/2 links; Cedar 10" S 38° W, 50 1/2 links; Cedar 10" N 2° E, 58 1/2 links. H.C. Lawrence, Registered Land Surveyor, made no mention in his notes of recovering this corner.

Description of corner evidence found:

Recovered a USGLO 4" diameter concrete monument with 2 1/2" brass cap projecting 6" above ground. Cap stamped:

Also recovered Maine's 2 1/2" iron pipe with screw on brass cap on the south side of concrete monument. This projects 18" above ground.

Recovered OBT's - Cedar 10" (12") S38° W, 50.5 links (now blown down, scribed T37N R11E S2. T38N R11E S35 + S36 S2 + S1 T37N R11E 1942

Cedar 10" N2° E, 58 1/2 links., scribed S36 BT. Cedar 10" (12") S60° E (S56° E) 22.5 links., scribing grown over. -- Cedar 8" S18° E, 33.5 links., scribing partly visible.

Measurement check to location of GIO monument. Description of monument and accessories I established to perpetuate the original location of this corner.

Left GIO monument and Maine's monument in place as recovered. Marked NBT - Cedar 12" N84° W, 29.7 links, scribed SC-BT.

Dated at Rhineland, Wis., this 23rd day of January, 1978

Signature Philipp T. Hansen Title Registered Land Surveyor Registration No. S-498
(County Surveyor, Registered Land Surveyor, or other duly authorized official)

Office of Registrar of Deeds, County of Oneida, I hereby certify that the within instrument was filed in this office for record on the 6th day of February, 1978 at 9:30 o'clock A. M.

Doris Therese Kuehn
(Registrar of Deeds)

By: _____ Deputy



Stock No. 26273

U.S. PUBLIC LAND SURVEY MONUMENT RECORD

Index No. A-21

State of Wisconsin

County of Oneida } ss.

William B. Cochran... do hereby certify that on the 23rd day of August, 1989, I found evidence of the Northwest Section corner of Section 1, Township 37, North, Range 11, East, Fourth Principal Meridian, as described hereon, and that from this evidence I established a new monument and accessories as described hereon to perpetuate the original location of this corner.

History of original corner establishment: Original Government Survey in 1859 by H.C. Fellows.

Dependent Resurvey in 1941 by Hugh B. Crawford. N88°38'W between Sections 1 and 36, at 42.50 chains the corner position is preserved and marked by an iron pipe which is testimony of the original corner position. In place of iron pipe, set a concrete monument, 3 feet long, 4 inches in diameter, with an iron post in center and stamped; T38N, R11E, S35, S36, S1, S2, T37N, 1941. From which the following bear; Cedar 6" N59°30'E 53 1/2 links Cedar 6" N59°30'E 34 links Cedar 6" S21°30'E 34 links Maple 7" N45°00'W 56 links

Description of corner evidence found: Found monument as described and in place and a 2 1/2 inch diameter galvanized iron pipe next to it. The galvanized pipe was apparently set by another surveyor.

Found the following bearing trees;

Cedar	12"	N59°30'E	35.31 feet (GLO BT)
Cedar	16"	S59°00'E	15.85 feet (Local BT)
Cedar	12"	S20°00'E	22.51 feet (GLO BT)
Cedar	15"	N85°00'W	20.50 feet (Local BT)
Maple	14"	N45°00'W	36.96 feet (GLO BT)

Description of monument and accessories I established to perpetuate the original location of this corner.

Painted and attached bearing tree signs to all bearing trees.

Set a steel sign post South and alongside the monument.

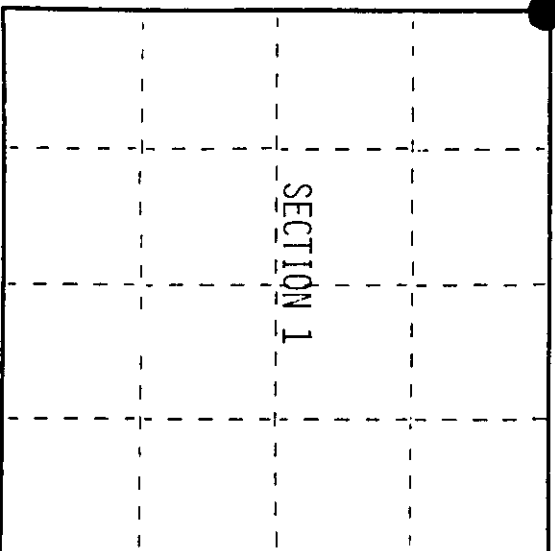

Corner monument restored.

Dated at Hiles, Wis., this 30th day of January, 19 90

Signature: William B. Cochran, Title: Land Surveyor, (County Surveyor, Registered Land Surveyor, or other duly authorized official) Registration No. 5-1107

Office of Register of Deeds, County of Oneida, I hereby certify that the within instrument was filed in this office for record on the 30th day of January, 19 90 at 10:00 o'clock, P.M.

(Register of Deeds)

By: Deputy

201135000

Stock No. 26273

U.S. PUBLIC LAND SURVEY MONUMENT RECORD

Index No. Z-21

State of Wisconsin } ss.
County of Oneida

I, William B. Cochran, do hereby certify that on the 23rd day of August, 1989, I found evidence of the Southwest Section corner of Section 36 Township 11 East, Range 38 North, Range 11 East, Fourth Principal Meridian, as described hereon, and that from this evidence I established a new monument and accessories as described hereon to perpetuate the original location of this corner.

Resident witnesses:

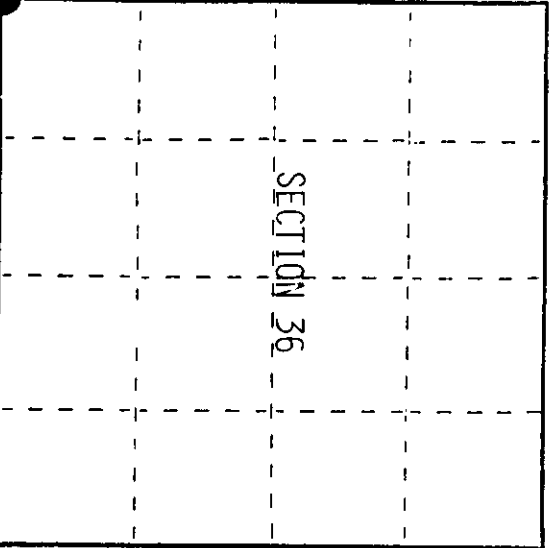

= Corner monument restored.

History of original corner establishment: Original Government Survey in 1859 by H.C. Fellows. Dependent Resurvey in 1941 by Hugh B. Crawford. N88°38'W between Sections 36 and 1, at 42.50 chains, the corner position is preserved and marked by an iron pipe which is testimony of the original corner position. In place of iron pipe, set a concrete monument, 3 feet long, 4 inches in diameter, with an iron post in center, and stamped; T38N, R11E, S35, S36, S1, S2, T37N, 1941. From which the following bear;

Table with 4 columns: Description, Bearing, Distance, and Monument. Rows include Cedar 6", Cedar 6", Cedar 6", and Cedar 6" with various bearings and distances.

Description of corner evidence found: Found monument as described and in place. A 2 1/2 inch diameter galvanized iron pipe is next to it. The galvanized pipe was apparently set by a local surveyor.

Found the following bearing trees;

Table with 4 columns: Tree Type, Bearing, Distance, and Monument. Rows include Cedar 12", Cedar 16", Cedar 12", Cedar 15", and Maple 14" with various bearings and distances.

Description of monument and accessories I established to perpetuate the original location of this corner.

Painted and attached bearing tree signs to all bearing trees.

Set a steel sign post South and alongside the monument.

Dated at Hills, Wis., this 30th day of January, 1990.

Signature of William B. Cochran, Title Land Surveyor, (County Surveyor, Registered Land Surveyor, or other duly authorized official) Registration No. S-1107

Office of Register of Deeds, County of Oneida, I hereby certify that the within instrument was filed in this office for record on the 19th day of August, 1989, at 10:00 o'clock A.M.

(Register of Deeds)

By: Deputy

