

6	5	4	3	2	1
7	8	9	10	11	12
13	14	15	16	17	18
19	20	21	22	23	24
25	26	27	28	29	30
31	32	33	34	35	36

RECEIVED & FILED
 Price County Surveyor's Office
 Date 2009.07.23
 By [Signature]
 PCS File No. N3822 E0300

CERTIFIED LAND CORNER RESTORATION
 DISTRICT CLERK'S OFFICE
 ONEIDA COUNTY
 FILED

STATE OF WISCONSIN }
 COUNTY OF Price } ss.

MAR - 9 2016

I, Randy R. Erickson, do hereby certify that on the 15 day of Sept., 2008,
 AT O'CLOCK M
KYLE J. FRANSON
 REGISTERED CLERK

I found evidence of the East Quarter corner of Section 24,
 Township 39 North, Range 03 East, Fourth Principal Meridian, as described
 hereon; and that from this evidence I established a new monument and accessories as described
 hereon to perpetuate the original location of this corner.

Description of Original monument and accessories and subsequent restorations:

1864 Alex Anderson set a wood post and marked Bearing Trees:
 Hemlock 9" N 32° W 22 links Hemlock 6" N 50° E 10 links
 1936 U.S. General Land Office dependent resurvey recovered remains of
 original Bearing trees, Set an iron post, 3 feet long, 27" in ground, 1"
 diameter, with a brass cap stamped to identify the corner. Original BTs:
 Hemlock 7" N 69 3/4° E 10 links Hemlock stub 12" N 39° W 22 links
 Marked new Bearing Trees:
 Cedar 5" N 13 1/2° E 78 links Cedar 5" N 60 1/4° W 17 links

Description of corner evidence found:

Found 1936 iron post in place. Found both 1936 cedar Bearing Trees in place
 and well

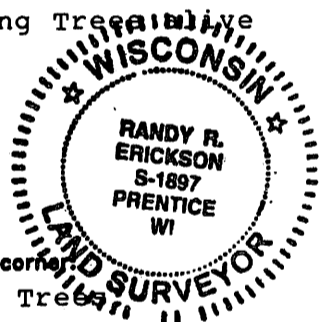

Description of monument and accessories I established to perpetuate the location of this corner:

Left 1936 iron post monument in place. Measured to Bearing Trees:
 Cedar 17" N 13 E 51.5 feet (GLO 1936)
 Cedar 9" N 60° W 11.2 feet (GLO 1936)
 Cedar 10" S 61° W 35.67 feet (new)
 steel Sign Post North 0.9 feet

Established Wisconsin North Zone State Plane Coordinates for Corner:
 N 250528.174 E 1957417.941 NAD 83 1991 u.s. foot

Section	24		
Town	39	North	
Range	03	East	

● - Corner monument restored

Resident witness _____
 Dated at Park Falls Wisconsin, this 29 day of Sept.
20 08.
 Signature [Signature] Title Reg. Land Surveyor
 Surveyors Registration No. 1897.
 Office of _____ County of _____
 I hereby certify that the within instrument was filed in this office for record
 on the _____ day of _____ 20____, and was filed in Book
 No. _____ Page No. _____ of County Records.
 Signature _____ Title _____

Township 39 North, Range 03 East, Section 24, Index No. _____, Page No. _____

N3822 E0300 2008 P-1