

U.S. PUBLIC LAND SURVEY MONUMENT RECORD

Note: This form is intended and designed to fulfill all requirements of Wisconsin Administrative Code, Chapter A-E 7.08 U.S. Public Land Survey Monument Record (3) (a) (b) (c) (d) (e) (f) (g) (h) (i). An additional sheet may be added if necessary to conform with said requirements.

(a) Corner location: Township 39 North

Range 4 East/West

Town/City/Village Minocqua

County Oneida

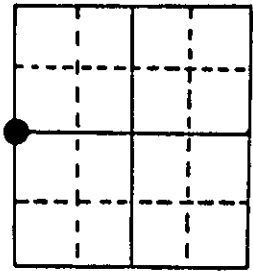

Section 13

(b) (f) (g) (h) Description of monument found at this corner and if it was accepted, state all evidence (material, testimonial, occupational, plats, records, other monuments) used as a basis for accepting. If not accepted or if nothing was found, state evidence used as basis for establishing location. If reestablished through lost corner proportionate methods, indicate all monuments, distances and directions used to establish.

The Original subdivision of the Township by Alex Anderson commenced May 9, 1865 and completed May 22, 1865.

Original BT's: 10" W. Pine N 31° E, 16 lks.

10" Birch N 26° W, 6 lks.

Found 1 1/2" diameter iron pipe in place. This pipe is shown on a 1966 Survey Map by Wm. Cameron indicating this as the Original 1/4 corner location.

Bearing trees found:	18" W. Birch (scribed)	S 85° W,	20.83 feet.
	Old scribed pine stump	N 6° E,	29.95 feet.
	6" & 3" diam. wood posts lying on ground		
	18" W. Pine	N 12° E,	50.45 feet.

(c) (d) (e) Plan view of corner with ties to at least 4 witness monuments. If in disagreement with previously established corner, show the distances between the two corners and also indicate the ties to the disputed corner.

Set Oneida County Survey monument in place of 1 1/2" diam. iron pipe. Made 3 new bearing trees, with measurements to nail in side of trees.

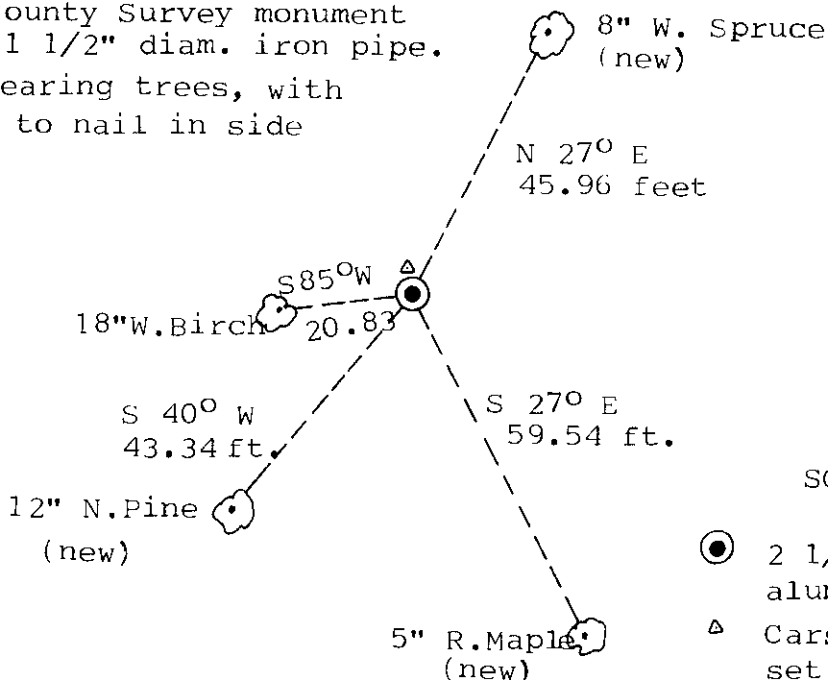

SCALE 1"=30 feet

- 2 1/2" diam. X 36" long alum. capped monument.
- △ Carsonite witness post set, N 10° W, 1.0 foot.

(i) I, Stephen J. Favorite, Reg. Land Surveyor#S-1616,
 (type or print name) certify that the corner location on this record was determined by me or under my direction and control and that this U.S. Public Land Survey Monument Record is correct and complete to the best of my knowledge and belief.

Stephen J. Favorite May 13, 1988
 Signature Date

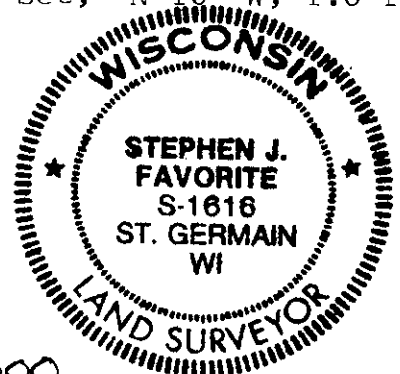

Index No. L-21