

U.S. PUBLIC LAND SURVEY MONUMENT RECORD

Note: This form is intended and designed to fulfill all requirements of Wisconsin Administrative Code, Chapter A-E 7.08 U.S. Public Land Survey Monument Record (3) (a) (b) (c) (d) (e) (f) (g) (h) (i). An additional sheet may be added if necessary to conform with said requirements.

(a) Corner location: Township 39 North
 Range 5 East/West

Town/City/Village Minocqua

County Oneida

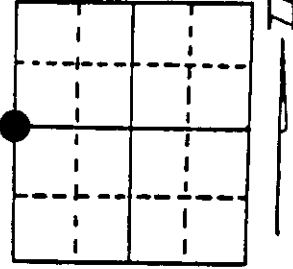

Section 25

(b) (f) (g) (h) Description of monument found at this corner and if it was accepted, state all evidence (material, testimonial, occupational, plats, records, other monuments) used as a basis for accepting. If not accepted or if nothing was found, state evidence used as basis for establishing location. If reestablished through lost corner proportionate methods, indicate all monuments, distances and directions used to establish. Indicate type of monument found or set and sign post.

Sept., 1863: Original surveyor, Alex Anderson, BT's:
 8" Tamarack, N1°W, 77 lks
 7" Tamarack, N7°E, 73 lks
 May, 1931: H.C. Hall - recovered and replaced original corner with 5"x5" conc. mon. and made following BT's:
 4" spruce N35 3/4°W, 23.3'
 5" spruce S10 3/4°W, 34.5'
 May, 1995: I recovered and replaced 5"x5" conc. mon. with a 7' long Oneida Co. alum. mon. See sketch below for witnesses.

(c) (d) (e) Plan view of corner with ties to at least 4 witness monuments. If in disagreement with previously established corner, show the distances between the two corners and also indicate the ties to the disputed corner.

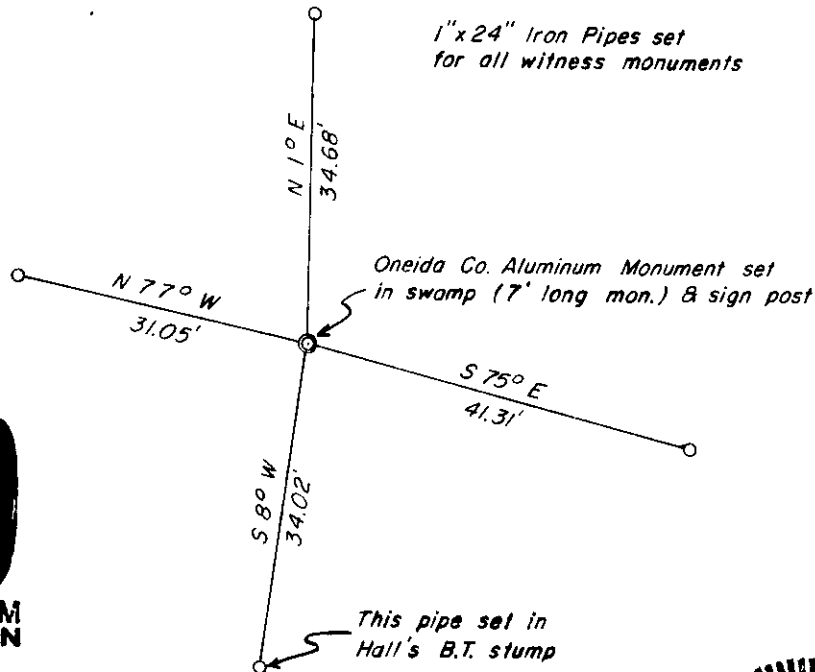

REGISTER OF DEEDS OFFICE
 ONEIDA COUNTY, WIS.
FILED
 NOV 15 1995
 At 10 O'Clock M
 THOMAS H. LEIGHTON
 REGISTER OF DEEDS

(i) I, Charles E. Winkler S-1431
 (type or print name) certify that the corner location on this record was determined by me or under my direction and control and that this U.S. Public Land Survey Monument Record is correct and complete to the best of my knowledge and belief.

Charles E. Winkler 10-24-95
 Signature Foltz and Associates, Inc. Date

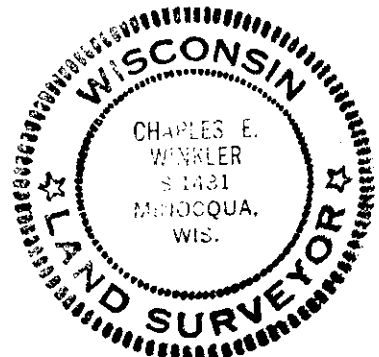

3905262000

Stamp

Index No. T 21