

U.S. PUBLIC LAND SURVEY MONUMENT RECORD

Note: This form is intended and designed to fulfill all requirements of Wisconsin Administrative Code, Chapter A-E 5.02, U.S. Public Land Survey Monument Record (3) (a) (b) (c) (d) (e) (f) (g) (h) (i). An additional sheet may be added if necessary to conform with said requirements.

(a) Corner location: Township 39 North
 Range 7 East ~~West~~
 Town/County ~~_____~~ of Woodruff
 County Oneida

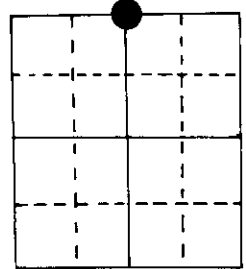

N 1/4 Section 27

2" iron pipe with W.C.D. brass cap

(b) (f) (g) (h) Description of monument found at this corner and if it was accepted, state all evidence (material, testimonial, occupational, plats, records, other monuments) used as a basis for accepting. If not accepted or if nothing was found, state evidence used as basis for establishing location. If reestablished through lost corner proportionate methods, indicate all monuments, distances and directions used to establish.

Original Alex Anderson Sept 1863. OBT's Sugar 5" S 54°E 8 lks, Maple 8" N 50°W 5 lks
 Dorr on 4/25/1897 found N~~W~~.
 Reinhart, Nelson & Mentz set N~~W~~ by proportion 1/2 way (1954-55).
 Made BT' MH 5" N 20°W .264 ch, PW 5" N 12°E 1.47 ch
 I found W.C.D. pipe on 11/24/82, no BT's. Made new BT's.

(c) (d) (e) Plan view of corner with ties to at least 4 witness monuments. If in disagreement with previously established corner, show the distances between the two corners and also indicate the ties to the disputed corner.

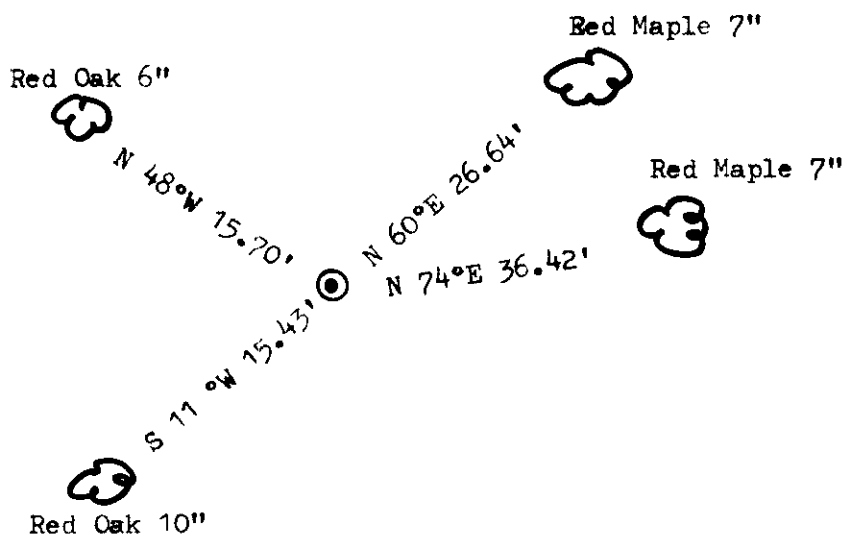
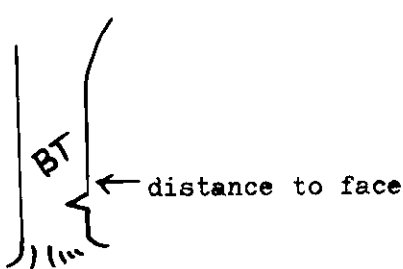

(i) I, Marvin E. Seymour
 (type or print name) certify that the corner location on this record was determined by me or under my direction and control and that this U.S. Public Land Survey Monument Record is correct and complete to the best of my knowledge and belief.

Affix seal here

Marvin E. Seymour April 23, 1984
 Signature Date

3907220020

R-15