

U.S. PUBLIC LAND SURVEY MONUMENT RECORD

Note: This form is intended and designed to fulfill all requirements of Wisconsin Administrative Code, Chapter A-E 5.02, U.S. Public Land Survey Monument Record (3) (a) (b) (c) (d) (e) (f) (g) (h) (i). An additional sheet may be added if necessary to conform with said requirements.

(a) Corner location: Township 39 North
 Range 7 East ~~East~~
 Town/ ~~County~~ of Woodruff
 County Oneida

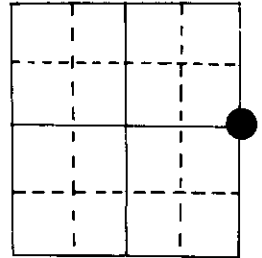

E 1/4 Section 25

2" iron pipe

(b) (f) (g) (h) Description of monument found at this corner and if it was accepted, state all evidence (material, testimonial, occupational, plats, records, other monuments) used as a basis for accepting. If not accepted or if nothing was found, state evidence used as basis for establishing location. If reestablished through lost corner proportionate methods, indicate all monuments, distances and directions used to establish.

Original Alex Anderson Sept 1860. OBT's Asp 9" N 64°W 21 lks, Asp 9" S 86°E 22 lks
 Vaughan in 12/19/01 was at this cor.

Wisc. Valley Imp. in 1938 found old post at 40.150 south of NW cor & set 2" iron pipe
 made BT's Oak 11" S 87°E 0.602 ch, PW 13" N 15°W 1.703 ch

I found on 11/18/80 a 2" i.p. & both BT's. Made new BT's BW 1/2 S 54°W 15.51'
 OR 9" N 84°E 22.20'

(c) (d) (e) Plan view of corner with ties to at least 4 witness monuments. If in disagreement with previously established corner, show the distances between the two corners and also indicate the ties to the disputed corner.

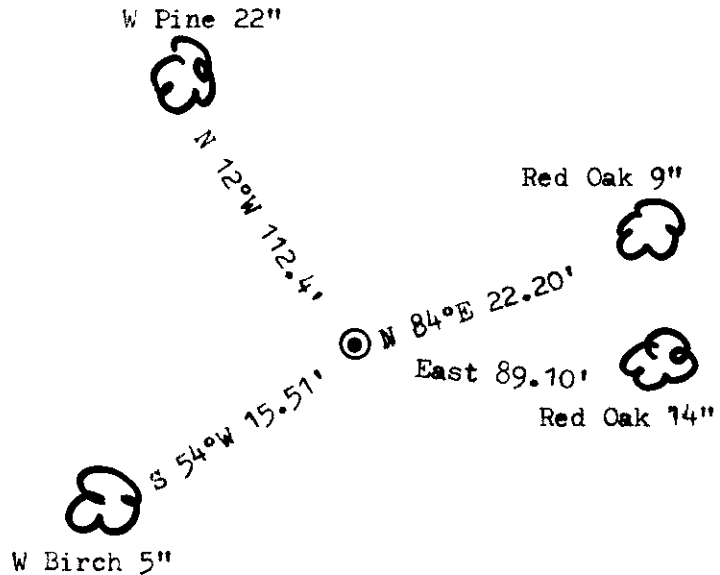
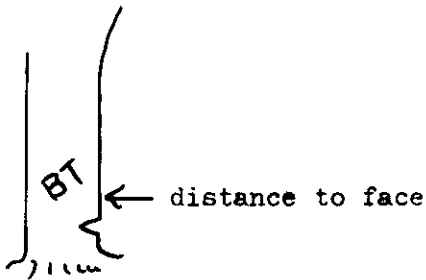

(i) I, Marvin E. Seymour
 (type or print name) certify that the corner location on this record was determined by me or under my direction and control and that this U.S. Public Land Survey Monument Record is correct and complete to the best of my knowledge and belief.



Marvin E. Seymour April 23, 1989
 Signature Date

Affix seal here

T-25

3907252000