

This form is intended to fulfill the requirements of Chapter A-E 7.08 (3)(a) thru (i) U.S. Public Land Survey Monument Location Record, Wisconsin Administrative Code. Use the reverse side of form for continuation.

U.S. PUBLIC LAND SURVEY MONUMENT LOCATION RECORD

Recorders Data

USPLS CORNER: NW SECTION SECTION: 9 TOWNSHIP: 39 NORTH RANGE: 8 EAST

NAME OF WATERWAY FOR M.C. CORNER : N/A SECTION LINE: N/A

(CITY)(VILLAGE)(TOWN) OF: NEWBOLD COUNTY OF: ONEIDA

Description of monument found or placed and all other evidence used as the basis for monument location; including monuments and related measurements required if the corner location was reestablished by lost corner proportionate methods. Also indicate name of original surveyor, original survey date and the corner monument, bearing trees, witness or other reference monuments established; including measured bearing and distance ties, from available records.

On October 7, 1998, an old 2" dia. WVIC iron pipe was found undisturbed and replaced with a standard 2" dia. by 60" long aluminum pipe monument, with a standard white poly 'T' marker post 1' North, by Foltz & Associates, Inc. of Minocqua, Wisconsin, and they measured new ties to BTs, all of which I found OK and used for completing this location record and in accord with field notes filed at Foltz & Associates, Inc. office

In July 1863, Alexander Anderson/GLO set a wood post as the original corner and marked OBTs: an 8" Sugar N62°W 33 links and a 15" Py N48°E 44 links, all of which are now obliterated.

In January 1978, Lee G. Andreas/Wisconsin Valley Improvement Corporation, notes 2" iron pipe at this corner location perpetuated from old BTs, one BT a rotted stump and other BT down, by R.W. Smith; and also noted found BTs: a 5" Pw South 32.7' and a 5" Tamarack N58°E 35.2', now both gone or obliterated beyond recovery usage; and he noted that the corner fell in a swampy beaver flowage area 30' from SE edge thereof, and that the corner should be witnessed with new BTs.

This recovery completed September 1, 1999; there were no direct witnesses.

Plan view map of monument location with bearing and distance ties to a minimum of four(4) described witness or reference monuments of concrete, natural stone, iron, live bearing trees or equivalent material. If applicable, also show a minimum of two(2) bearing and distance ties to any other monument found and not accepted; including the bearing and distance from the accepted monument.

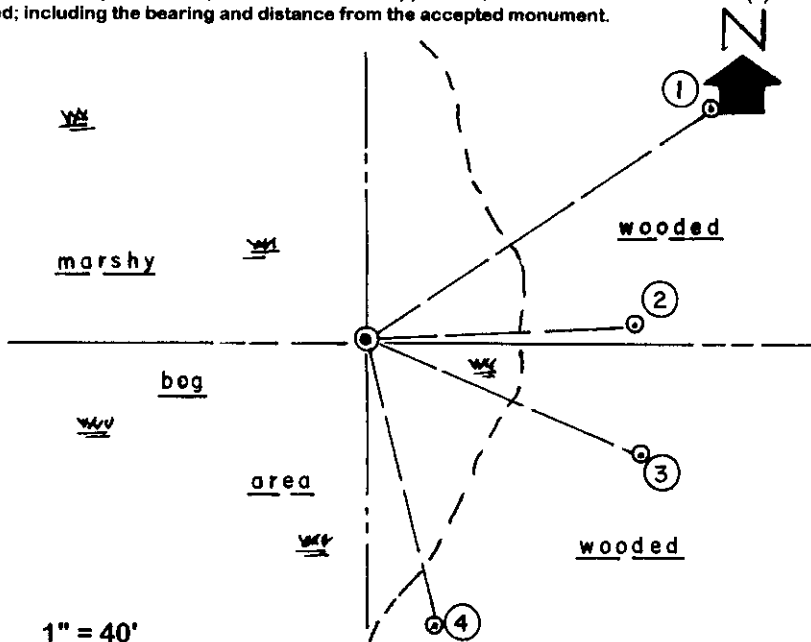

WITNESS MONUMENT TIES:

- ① Blazed 11" Sb BT by Foltz, Inc. at N56°E 86.56'.
- ② Old 22" Pw BT found by Foltz, Inc. N86°E 56.40'; std DND sign on face.
- ③ Blazed 8" Sb BT by Foltz, Inc. at S68°E 62.60'.
- ④ Blazed 11" Pw BT by Foltz, Inc. at S14°E 61.93'.

All ties measured to 40d aluminum nails set in side of each BT. Corner falls about 32' westerly of easterly edge of existing beaver dam pond marshy/bog area.

SCALE: 1" = 40'

Unless otherwise indicated, all bearing tree ties are to a .25" dia. by 2.5" long PK nail with a 1.25" dia. steel washer driven into unblazed right face and a .25" dia. by 2.5" long PK nail with a 2" dia. steel washer stamped BT is also driven into unblazed face of bearing tree at DBH; the basis for measured bearings is by compass to nearest degree and all tie distances are measured horizontal by steel tape corrected to nearest 1/100th feet at standard temperature of 68° F.

RLS SEAL:

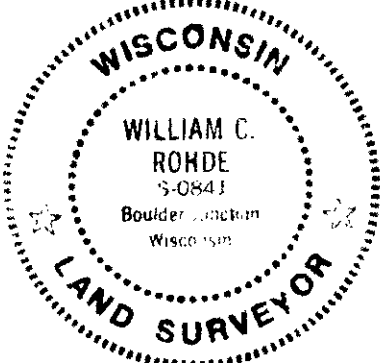

LAND SURVEYOR CERTIFICATE:

I, William C. Rohde, hereby certify that I am duly licensed as a Professional Land Surveyor in the State of Wisconsin; that this USPLS monument location was determined by me and/or under my direct supervision and control; and that this U.S. Public Land Survey Monument Location Record is true and correct to the best of my knowledge and belief.

Signed: *William C. Rohde*
 William C. Rohde RLS 841

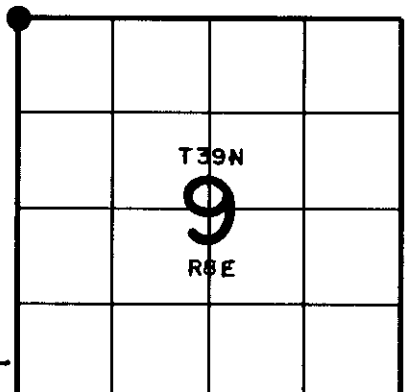

SECTION LOCATION MAP

INDEX NO. 29

3908050000

U.S. PUBLIC LAND SURVEY MONUMENT RECORD

Note: This form is intended and designed to fulfill all requirements of Wisconsin Administrative Code, Chapter A-E 7.08 U.S. Public Land Survey Monument Record (3) (a) (b) (c) (d) (e) (f) (g) (h) (i). An additional sheet may be added if necessary to conform with said requirements.

(a) CORNER LOCATION: WISCORS (Oneida County)
Cor. of Secs. 4, 5, 8 & 9 N: 256,672.07 USft
Township 39 North E: 239,263.51 USft
Range 8 East of the 4th P.M. Datum: NAD 1983(2011)
Town of Newbold County of Oneida

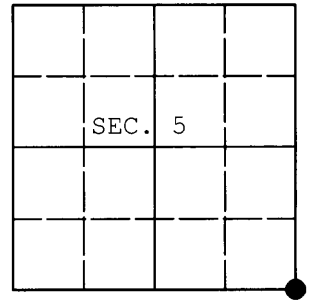

(b) HISTORY OF ORIGINAL CORNER ESTABLISHMENT
Original Surveyor: Original Accessories:
Date of Survey: Commenced:
Completed:

(b) (f) (g) (h) Description of monument found at this corner and if it was accepted, state all evidence (material, testimonial, occupational, plats, records, other monuments) used as a basis for accepting. If not accepted or if nothing was found, state evidence used as basis for establishing location. If re-established through lost corner proportionate methods, indicate all monuments, distances and directions used to establish. Indicate type of monument and sign post found or set.

NOTE: This is a perpetuation of a previous USPLS Monument Record by William C. Rohde, RLS dated February 3, 2000 and filed in the office of the Oneida County Register of Deeds. A complete history of the corner can be found on the previous monument record. I accept the previous location as a true and faithful perpetuation or reestablishment of the original corner location and further perpetuate it as follows.

May 6, 2014: I found and accepted Rohde's monument, a 2.5" diam. aluminum monument with Oneida Co. aluminum cap. Rohde's accessories were found in substantial agreement with his previous record and were not remeasured as the sole purpose of this work is to report the coordinates of the corner point.

The coordinates shown were derived from a direct RTN GPS observation referenced to the WISCORS network.

(c) (d) (e) Plan view of corner with ties to at least 4 witness monuments. If in disagreement with previously established corner, show the distances between the two corners and also indicate the ties to the disputed.

REGISTER OF DEEDS OFFICE
ONEIDA COUNTY
FILED

MAY 22 2014

AT _____ O'CLOCK _____ M
KYLE J. FRANSON
REGISTER OF DEEDS

(i) I, Jeffrey W. Austin, Registered Land Surveyor No. S-1885, hereby certify that the corner location on this record was determined by me or under my direction and control and that this U.S. Public Land Survey Monument Record is correct and complete to the best of my knowledge and belief.

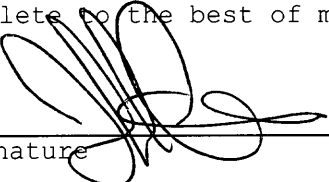

Signature 

May 9 2014
Date