

U.S. PUBLIC LAND SURVEY MONUMENT RECORD

Note: This form is intended and designed to fulfill all requirements of Wisconsin Administrative Code, Chapter A-E 7.08 U.S. Public Land Survey Monument Record (3) (a) (b) (c) (d) (e) (f) (g) (h) (i). An additional sheet may be added if necessary to conform with said requirements.

(a) Corner location: Township 39 North Corner: North Line of Section 17

Section 17 Range 8 East Original Surveyor: (See note below)

Town/City/Village Newbold

Original B.T.'s: No meander post set or BTs noted by GLO Surveyor Anderson

County Oneida

Original Survey Date: July 1863

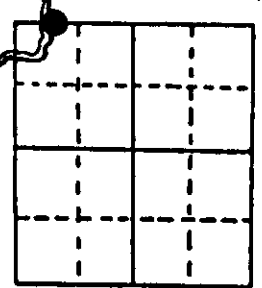

● Location

(b) (f) (g) (h) Description of monument found at this corner and if it was accepted, state all evidence (material, testimonial, occupational, plats, records, other monuments) used as a basis for accepting. If not accepted or if nothing was found, state evidence used as basis for establishing location. If reestablished through lost corner proportionate methods, indicate all monuments, distances and directions used to establish. Indicate type of monument found or set and sign post.

Old 2" dia. iron pipe monument found with uncapped top 16" above grade at this corner. I carefully removed the old 2" dia. iron pipe monument and replaced it with a standard 2" dia. Berntsen aluminum monument with a stamped Oneida County cap and cast aluminum point driven to 34" depth with cap flush with grade. I left the old iron pipe monument, 48" long, flat on grade next to new monument set. The corner is 6.5' West of a power pole and 16" SE of its guy wire anchor. I also set a standard white poly 'T' corner marker post 4" East of the new corner monument. No original GLO corner evidence exists, as Deputy Surveyor Anderson noted he had intersected a pond in 1863; however, this witness MC is now essential to extension of PLSS section line to the East shore of what is now Pickerel Lake by impoundment. In 1938, Wisconsin Valley Improvement Corporation set the older 2" iron pipe monument at this corner by section line resurvey at 8.444 chains East of the NW corner of Section 17 in Pickerel Lake, and noted new BTs, a 12" Pine N88°E 0.652 chains, now gone, and a 24" Pine stump at S36°E 0.621 chains, now a badly rotted stump at S34°E. This corner recovery completed on September 25, 1997; no witnesses.

(c) (d) (e) Plan view of corner with ties to at least 4 witness monuments. If in disagreement with previously established corner, show the distances between the two corners and also indicate the ties to the disputed corner.

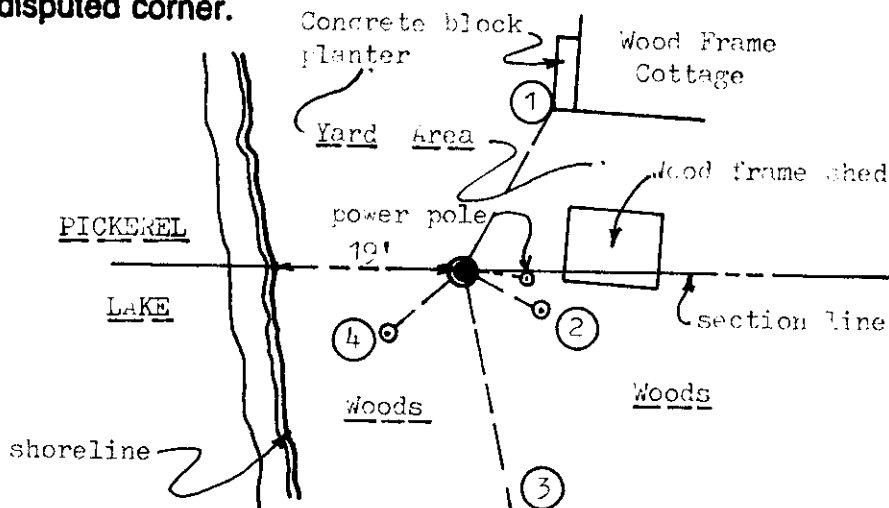

Witness Monument Ties:

- ① SW corner of concrete block planter at grade, N28°E at 19.60'.
- ② New BT 6" Pw S64°E 9.00'.
- ③ New BT 8" Bw S10°E 26.65'.
- ④ New BT 15" Pw S50°W 10.22'.

Unless otherwise indicated, all BT witness monument ties are to a 1/4" dia. by 2.5" long PK nail with 1.25" dia. steel washer set in unblazed right face bark; and a PK nail with 2" dia. steel washer stamped BT also set in unblazed front face bark of each BT at DBH. All previous corner recovery notes from Wisconsin DNR and/or Oneida County survey records.



Scale: 1" = 20'

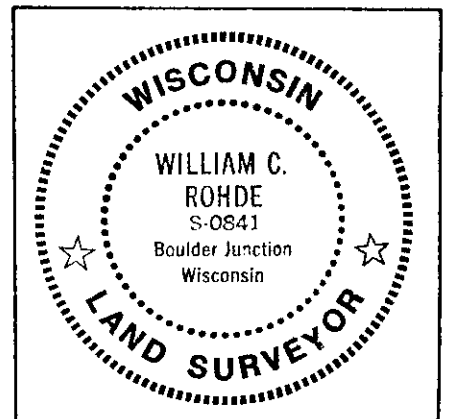

(i) I, William C. Rohde, RLS 841
 (type or print name) certify that the corner location on this record was determined by me or under my direction and control and that this U.S. Public Land Survey Monument Record is correct and complete to the best of my knowledge and belief.

William C. Rohde
 Signature

9-30-97
 Date

U.S. PUBLIC LAND SURVEY MONUMENT RECORD

Note: This form is intended and designed to fulfill all requirements of Wisconsin Administrative Code, Chapter A-E 7.08 U.S. Public Land Survey Monument Record (3) (a) (b) (c) (d) (e) (f) (g) (h) (i). An additional sheet may be added if necessary to conform with said requirements.

(a) CORNER LOCATION: WISCRS (Oneida County)
Meander Cor. of Secs. 8 & 17 N: 251,388.24 USft
Township 39 North E: 234,667.92 USft
Range 8 East of the 4th P.M. Datum: NAD 1983(2011)
Town of Newbold County of Oneida

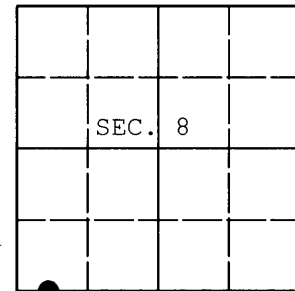

(b) HISTORY OF ORIGINAL CORNER ESTABLISHMENT

Original Surveyor: Original Accessories:
Date of Survey: Commenced:
Completed:

(b) (f) (g) (h) Description of monument found at this corner and if it was accepted, state all evidence (material, testimonial, occupational, plats, records, other monuments) used as a basis for accepting. If not accepted or if nothing was found, state evidence used as basis for establishing location. If re-established through lost corner proportionate methods, indicate all monuments, distances and directions used to establish. Indicate type of monument and sign post found or set.

NOTE: This is a perpetuation of a previous USPLS Monument Record by William C. Rohde, RLS dated September 30, 1997 and filed in the office of the Oneida County Register of Deeds. A complete history of the corner can be found on the previous monument record. I accept the previous location as a true and faithful perpetuation or reestablishment of the original corner location and further perpetuate it as follows.

March 19, 2014: I found and accepted Rohde's monument, a 2.5" diam. aluminum monument with Oneida Co. aluminum cap. Rohde's accessories were found in substantial agreement with his previous record and were not remeasured as the sole purpose of this work is to report the coordinates of the corner point.

The coordinates shown were derived from offset RTN GPS observations referenced to the WISCORS network.

(c) (d) (e) Plan view of corner with ties to at least 4 witness monuments. If in disagreement with previously established corner, show the distances between the two corners and also indicate the ties to the disputed.

REGISTER OF DEEDS OFFICE
ONEIDA COUNTY
FILED

MAY 22 2014

AT _____ O'CLOCK _____ M
KYLE J. FRANSON
REGISTER OF DEEDS

(i) I, Jeffrey W. Austin, Registered Land Surveyor No. S-1885, hereby certify that the corner location on this record was determined by me or under my direction and control and that this U.S. Public Land Survey Monument Record is correct and complete to the best of my knowledge and belief.



Signature

Date

3908080036 (INDEX NO. J-5,6)