

U.S. PUBLIC LAND SURVEY MONUMENT RECORD

Note: This form is intended and designed to fulfill all requirements of Wisconsin Administrative Code, Chapter A-E 7.08 U.S. Public Land Survey Monument Record (3) (a) (b) (c) (d) (e) (f) (g) (h) (i). An additional sheet may be added if necessary to conform with said requirements.

(a) Corner location: Township 39 North Corner: North 1/4

Section 24 Range 8 East Original Surveyor: A. Anderson

Town/City/Village Newbold Original B.T.'s: 8" dia S47°E 14 lks
10" dia N48°E 38 lks

County Oneida

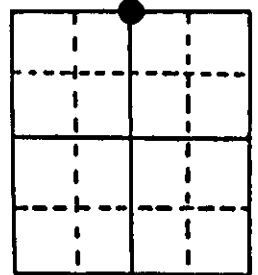

Original Survey Date: July 1863 ● Location

(b) (f) (g) (h) Description of monument found at this corner and if it was accepted, state all evidence (material, testimonial, occupational, plats, records, other monuments) used as a basis for accepting. If not accepted or if nothing was found, state evidence used as basis for establishing location. If reestablished through lost corner proportionate methods, indicate all monuments, distances and directions used to establish. Indicate type of monument found or set and sign post.

I found and accepted a very old 1 1/4" dia. iron pipe well point with uncapped top 14" above existing grade at this corner location. I left the old pipe in place and drove a standard 2" dia. by 30" long aluminum Bernsten monument with stamped Oneida County cap over it to 12" above grade. The corner falls about 2 feet west of an existing North/South barbed wire fence. I set a standard white poly 'T' corner marker post 10" East of the corner monument. All original GLO survey corner evidence is now obliterated. In 1968, Northwoods Surveyors of Minocqua, Wis. also found and accepted the iron pipe well point as the 1/4 corner per their record file preliminary plat for Pa-Ho-Tea Beach Colony Subdivision survey on the NW and North shore acreage along Clear Lake, now known as Paradise Lake. In 1977, Copp & Seymour of WCD, now DNR, also found and accepted the old iron pipe well point as the 1/4 corner location, and noted a new BT 24" Pw N18°W 20.8', per their Plat of Survey filed as B970 in Oneida County surveyor records. I found their NW Pw BT and used it for new ties below; a lower face blaze is shut on the face at root crown but with plain fissure over-mouth. This recovery completed November 7, 1997; there were no witnesses.

(c) (d) (e) Plan view of corner with ties to at least 4 witness monuments. If in disagreement with previously established corner, show the distances between the two corners and also indicate the ties to the disputed corner.

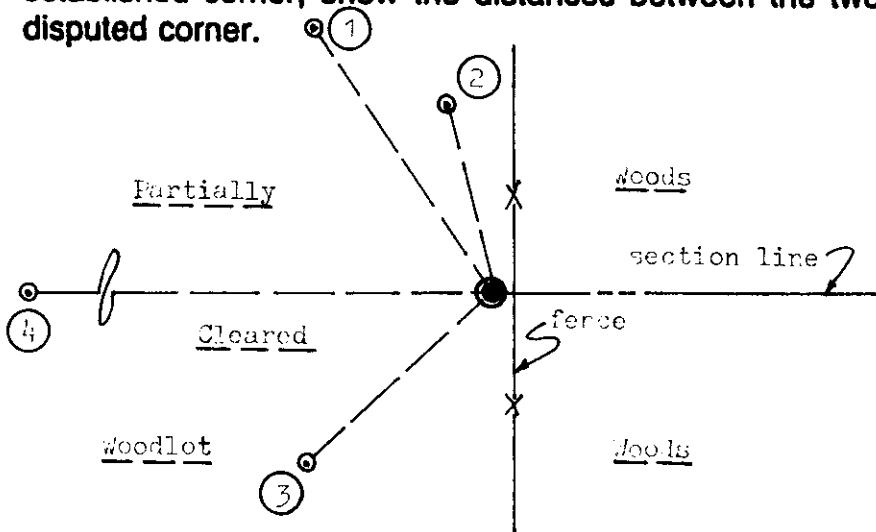

Witness Monument Ties:

- ① New BT 14" Pw N34°W 33.67'.
- ② Record BT 24" Pw N14°W 20.57'.
- ③ New BT 16" Pr S48°W 26.42'.
- ④ New BT East 15" Pw trunk of twin with 26" dia. base, at West 28.28'.

Unless otherwise indicated, all BT witness monument ties are to a 1/4" dia. by 2.5" long PK nail with 1.25" dia. steel washer set in unblazed right face bark; and a PK nail with 2" dia. steel washer stamped BT also set in unblazed front face bark of each BT at DBH. All previous corner recovery notes from Wisconsin DNR and/or Oneida County survey records.



Scale: 1" = 20'

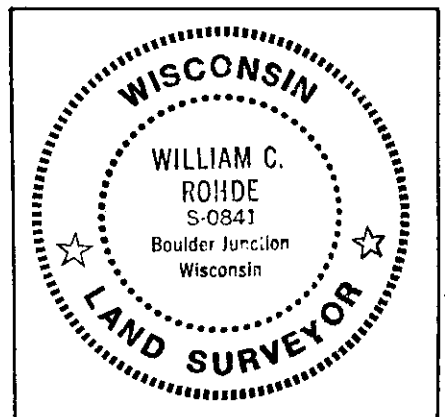

Index No. P-23

(i) I, William C. Rohde, RLS 841
(type or print name) certify that the corner location on this record was determined by me or under my direction and control and that this U.S. Public Land Survey Monument Record is correct and complete to the best of my knowledge and belief.

William C. Rohde
Signature

Nov. 09, 1997

Date