

CERTIFIED LAND CORNER RESTORATION

Index No. K-24

State of Wisconsin }  
 County of Oneida } ss.

History of original corner establishment:  
 No record of any previous survey.

I Daniel K. Plegger, do hereby certify that on the 21st day of July, 1980, I ~~found~~ established the NE 1/16 corner of Section 13 Township 39, North, Range 8 East, Fourth Principal Meridian, as described hereon; and that from this evidence I established a new monument and accessories as described hereon to perpetuate the original location of this corner.

Description of corner evidence found:  
 Corner established by subdivision of the NE 1/4 section 13.  
 Computed location of NE 1/16 corner is S1-52-03W ~ 1319.365 feet of E 1/16 corner between sections 12 and 13 and N1-52-03E 1319.199 feet of E.C. 1/16 section 13.

Resident witnesses:

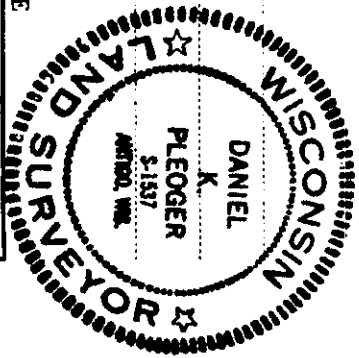

Description of monument and accessories I established to perpetuate the original location of this corner:  
 Set a 1" iron pipe with 2" brass cap - stamped:  
 Monument projects 18" above ground.

Marked N.B.T.'s -  
 Maple 8" S27°W 25.89 feet  
 White Pine 8" N8°W 38.60 feet  
 scribed 1/16 B.T.

T39N R8E  
 NE 1/16 S 13  
 S1537-1980

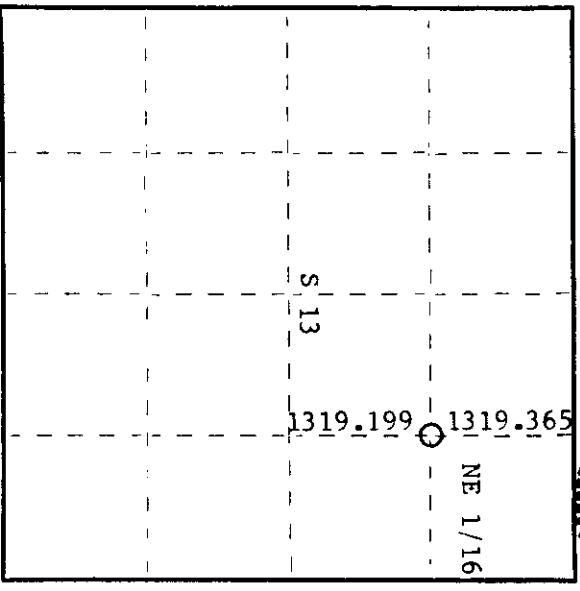

O = Corner monument restored.

Dated at Rhineland, Wis., this 16th day of October, 1980

Signature Daniel K. Plegger Title Registered Land Surveyor Registration No. 1537  
 (County Surveyor, Registered Land Surveyor, or other duly authorized official)

Office of Register of Deeds, County of Oneida  
 Instrument was filed in this office for record on the 20th day of October, 1980  
 at 10 o'clock P. M.

Dennis Savage Kuehn  
 (Register of Deeds)

By..... Deputy

3908133010