

# U.S. PUBLIC LAND SURVEY MONUMENT RECORD

**Note:** This form is intended and designed to fulfill all requirements of Wisconsin Administrative Code, Chapter A-E 7.08 U.S. Public Land Survey Monument Record (3) (a) (b) (c) (d) (e) (f) (g) (h) (i). An additional sheet may be added if necessary to conform with said requirements.

(a) Corner location: Township 39 North Corner: West 1/4 Corner

Section 25 Range 8 East Original Surveyor: A. Anderson

Town/City/Village Newbold

Original B.T.'s: 7" Bw N46°E 14 lks  
8" Mr S22°W 12 lks

County Oneida

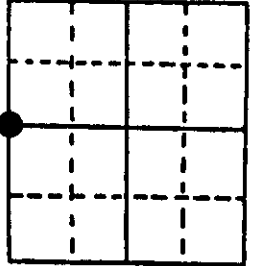

Original Survey Date: July 1863 ● Location

(b) (f) (g) (h) Description of monument found at this corner and if it was accepted, state all evidence (material, testimonial, occupational, plats, records, other monuments) used as a basis for accepting. If not accepted or if nothing was found, state evidence used as basis for establishing location. If reestablished through lost corner proportionate methods, indicate all monuments, distances and directions used to establish. Indicate type of monument found or set and sign post.

Found and accepted an undisturbed standard 2" dia. iron pipe monument with stamped WCD brass cap at this corner 2" below existing grade; corner falls at south edge of an unimproved dirt roadway access to storage/shallow sand pit area for nearby cranberry development. Corner is also in a clearing with suitable visibility for future GPS positioning purposes. In 1964, Ilg/WCD noted WCD capped iron pipe monument at this corner in a sand pit area and about 22' south of the centerline of a dirt roadway; his BT 18" Pn S32°W 1.562 chains is now a 22" Pn with lower face blaze fissure plain at root crown, which I used for new ties below, and his 4" Bw BT N52°E 1.754 chains is now gone or uncertain. In 1977, Seymour/DNR found the record WCD capped monument bent at the corner location from snow plowing and reset a new monument flush with grade from record BTs by Ilg in 1964. All original GLO survey corner evidence is now obliterated. I set a standard white poly 'T' corner marker post 6 feet south of the corner monument to aid future recovery. This recovery completed July 10, 1997; there were no witnesses.

(c) (d) (e) Plan view of corner with ties to at least 4 witness monuments. If in disagreement with previously established corner, show the distances between the two corners and also indicate the ties to the disputed corner.

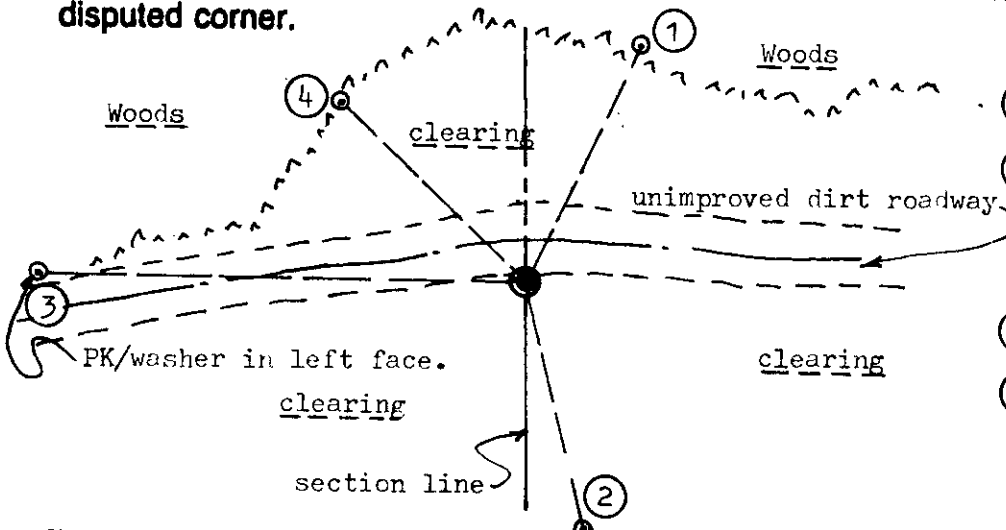

**Witness Monument Ties:**

- ① New BT 6" Bw N26°E 55.23'.
- ② New BT PK/washer in left face of 5" Mr in clump of several Aspen & Maple around old dead stump S12°E 57.24'.
- ③ Record BT 22" Pn N89°W 103.44'.
- ④ New BT 6" Aspen N45°W 53.57'.

Unless otherwise indicated, all BT witness monument ties are to a 1/4" dia. by 2.5" long PK nail with 1.25" dia. steel washer set in unblazed right face bark; and a PK nail with 2" dia. steel washer stamped BT also set in unblazed front face bark of each BT at DBH. All previous corner recovery notes from Wisconsin DNR and/or Oneida County survey records.



Scale: 1" = 40'

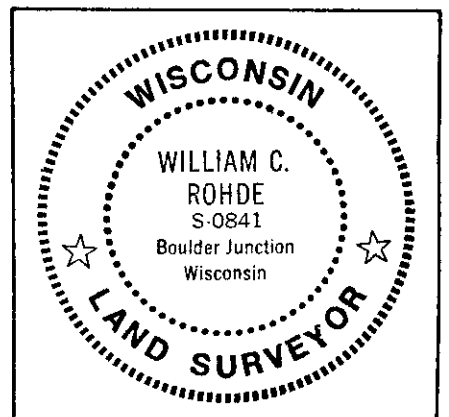

(i) I, William C. Rohde, RLS 841  
(type or print name) certify that the corner location on this record was determined by me or under my direction and control and that this U.S. Public Land Survey Monument Record is correct and complete to the best of my knowledge and belief.

William C. Rohde  
Signature

July 14, 1997  
Date