

CERTIFIED LAND CORNER RESTORATION

Index No. **E-18**

State of Wisconsin } ss.

County of Oneida

I, Philip T. Hansen, do hereby certify that on the 21st day of April, 1975, I found evidence of the W-1/16 corner of between Sections 2 and 11 Township 39 North, Range 9 East, Fourth Principal Meridian, as described hereon; and that from this evidence I established a new monument and accessories as described hereon to perpetuate the original location of this corner.

Resident witnesses:

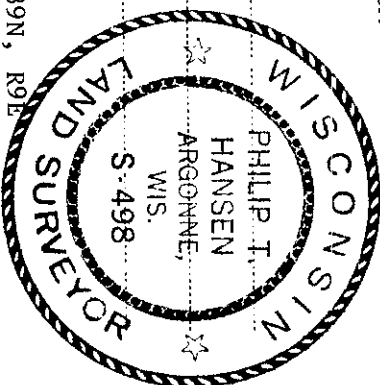

T39N, R9E

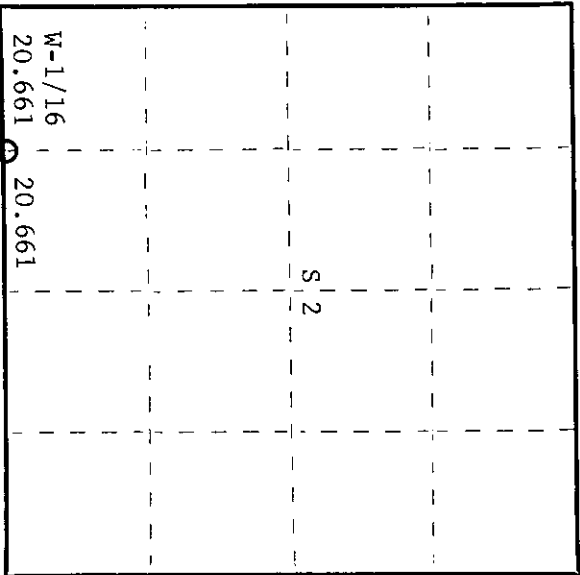

○ = Corner monument restored.

History of original corner establishment:  
Corner established by R. Ilg, State Surveyor, in 1971. He set the corner equidistant between the 1/4 corner between Sections 2 and 11 and the Section corner 2-3-34-35, at 20.67 chains from which white pine 22" bears N56°W 50.8 links, and red pine 14" bears S20°W 83.2 links. Set 2" iron pipe.

Description of corner evidence found:  
Recovered Ilg's 2" iron pipe.  
Recovered white pine 22" N56°W 50.8 links scribed "W" 1/8 BT.  
red pine 14" S20°W 83.2 links scribed "W" 1/8 BT.

Description of monument and accessories I established to perpetuate the original location of this corner.  
Replaced iron pipe with 1-1/2" O.D. iron pipe with 2" brass cap stamped -  
No additional accessories established.

S498  
T39N R9E

W-1/16 S | 2  
S | 11

CPI-1975

Dated at Rhinelander, Wis., this 19th day of June, 1975

Signature: *Philip T. Hansen* Title: Registered Land Surveyor Registration No. S-498  
County Surveyor, Registered Land Surveyor, or other duly authorized official

Office of Register of Deeds, County of Oneida  
Instrument was filed in this office for record on the 1st day of October, 1975  
at 3:00 o'clock P.M.

*Dennis Vernege Kuehn*  
(Register of Deeds)

By: Deputy

3909020030