

CERTIFIED LAND CORNER RESTORATION

Index No. **D-17**

State of Wisconsin }
 County of Oneida } ss.

I Philip T. Hansen, do hereby certify that on the 6th day of May, 1975, I found evidence of the S-1/16 between corner of Sections 2 and 3 Township 39 North, Range 9 East, Fourth Principal Meridian, as described hereon; and that from this evidence I established a new monument and accessories as described hereon to perpetuate the original location of this corner.

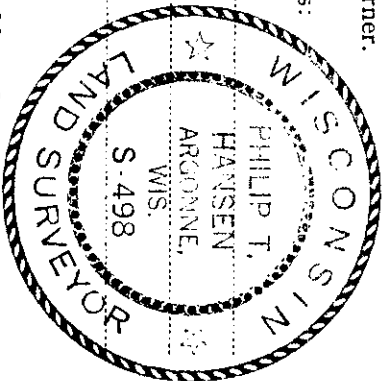

Resident witnesses:

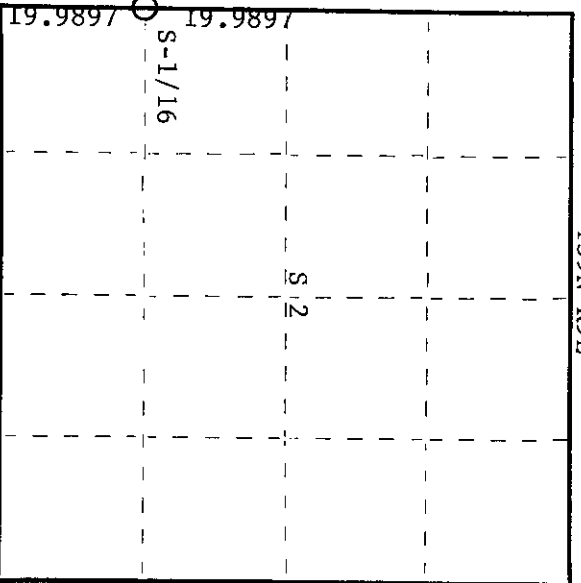

○ = Corner monument restored.

History of original corner establishment:

Original corner established by R. Ilg, State Surveyor, in 1971. Corner was set equidistant, 19.9897 chains between 1/4 corner between Sections 2 and 3, and the Section Corner S2, S3, S10, and S11. Set 1-1/2" iron pipe, painted red, from which red oak 18" bears S57°W, 0.355 chains and white pine 12" bears N12°W, 0.566 chains.

Description of corner evidence found:

Recovered 1-1/2" iron pipe, without brass cap, projecting 4" above the ground.

Recovered: Red oak 18" S57°W 35.5 links scribed "W"-1/8 BT
 White pine 12" S12°W 56.6 links scribed "W"-1/8 BT.

Description of monument and accessories I established to perpetuate the original location of this corner.

Replaced iron pipe with 1-1/2" iron pipe w/2" brass cap stamped -

S498
 T39N R9E

S-1/16 S | S
 3 | 2

CPT-1975

Dated at Rhineland, Wis., this 30th day of June, 1975.

Signature *Philip T. Hansen* Title Registered Land Surveyor Registration No. S-498
 (County Surveyor, Registered Land Surveyor, or other duly authorized official)

Office of Register of Deeds, County of Oneida
 Instrument was filed in this office for record on the 1st day of October, 1975, at 3:00 o'clock P.M.

Donna Terage Kuehn
 (Register of Deeds)

By: Deputy

390903100