

CERTIFIED LAND CORNER RESTORATION

Index No. **B-17**

State of Wisconsin

County of Oneida } ss.

I Philip T. Hansen, do hereby certify that on the 24th day of April, 1975, I found evidence of the N-1/16 between corner of S2 and S3 Township 39, North, Range 9 East, Fourth Principal Meridian, as described hereon; and that from this evidence I established a new monument and accessories as described hereon to perpetuate the original location of this corner.

Resident witnesses:

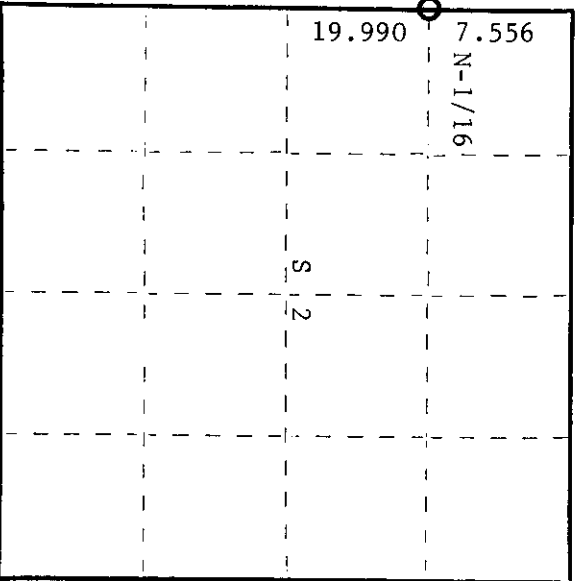
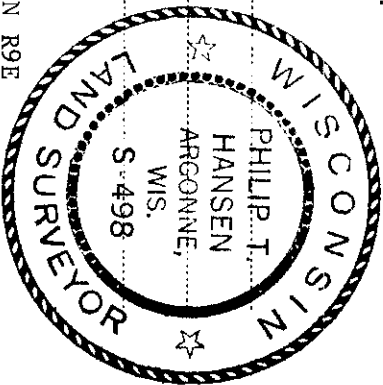

History of original corner establishment:
 Corner established by R. Ilg, State Surveyor, in 1972. Set 1" iron pipe 7.556 chains south 6° 38-1/2' west of the concrete post marking the section corner between Sections 2 and 3, and 19.990 chains north 6°38-1/2' east of the 1/4 corner, from which a red oak 12" bears N53°0E 0.303 chains and white pine 14" bears S26°0E 0.753 chains.

Description of corner evidence found:
 Recovered 1" iron pipe set by R. Ilg in good condition, painted red, projecting 4" above the ground.

Recovered - red oak BT 12" N58°0E 31.1 links, scribed "W" 1/8 BT.
 White pine 14" S23°0E 75.7 links, scribed "W" 1/8 BT.
 Also, beaver blazes witnessing the corner.

Description of monument and accessories I established to perpetuate the original location of this corner.
 Replaced 1" iron pipe with 1-1/2" O.D. iron pipe with 2" brass cap stamped -
 S498
 T39N R9E
 No additional accessories established.

3909033000

S2 | S3
 N-1/16 |
 CPL-1975

Dated at Rhineland Wis. this 19th day of June, 1975.

Signature Philip T. Hansen Title Registered Land Surveyor Registration No. S-498
 (County Surveyor, Registered Land Surveyor, or other duly authorized official)

Office of Register of Deeds, County of Oneida
 Instrument was filed in this office for record on the 1st day of October I hereby certify that the within
 at 3:00 o'clock P. M. 1975

Donna Therese Kuchta
 (Register of Deeds)

By: _____ Deputy

○ = Corner monument restored.