

CERTIFIED LAND CORNER RESTORATION

Index No. **S-25**

State of Wisconsin }
County of **Oneida** } ss.

I, **Phillip T. Hansen**, do hereby certify that on the **1st** day of **February**, 19 **78**, I found evidence of the **N 1/16** corner of **Section 25 & 30**

Township **39**, North, Range **9 East**, Fourth Principal Meridian,

as described hereon; and that from this evidence I established a new monument and accessories as described hereon to perpetuate the original location of this corner.

Resident witnesses:

Jim Claflin

Herb Wagoner

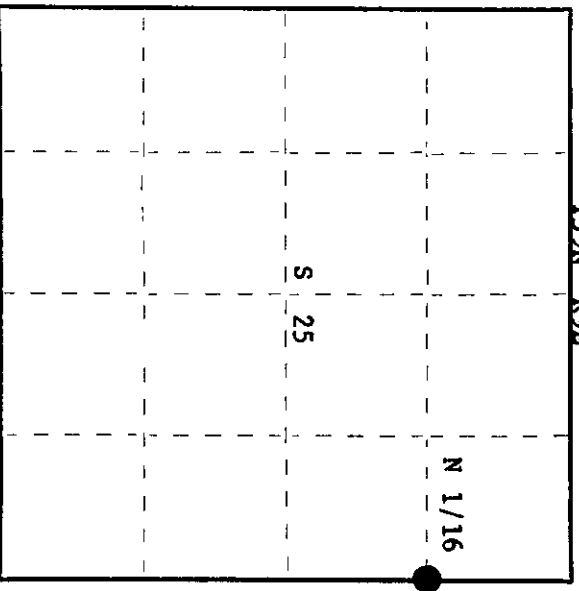
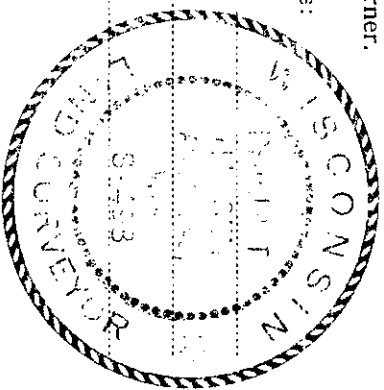

○ = Corner monument restored.

History of original corner establishment:

Corner recovered by N. Loftus, Ripco Surveyor. Found old corner at 20.32 chains, 69 links north of his random line. No record of any BT's recorded. Corner is in a cedar swamp.

Description of corner evidence found:

Recovered 3/4" iron pipe with 2" square brass cap and a 1 1/4" iron pipe beside it. Monument recovered in good condition. Monument projects 12" above ground. Cap stamped: No BT's recovered.

N 1/16
S25 1 530
39-97 39-10
RIPCO

Description of monument and accessories I established to perpetuate the original location of this corner.

Monument left in place as recovered.
Marked NBT's - White Birch 5" S65°W, 3.4 links.
Twin Maple 7" N44°W, 44.5 links, scribed 1/16 BT.

Dated at **Rhinelander**, Wis., this **3rd** day of **February**, 19 **78**

Signature *Phillip T. Hansen* Title **Registered Land Surveyor** Registration No. **S-498**
(County Surveyor, Registered Land Surveyor, or other duly authorized official)

Office of Register of Deeds, County of **Oneida**
I hereby certify that the within instrument was filed in this office for record on the **7th** day of **February**, 19 **78** at **2:00** o'clock **P.** M.

Dave George Tucker
(Register of Deeds)

By: _____ Deputy

3909253000