

U.S. PUBLIC LAND SURVEY MONUMENT LOCATION RECORD

Recorders Data

CORNER: West 1/4 SECTION: 27 TOWNSHIP 39 NORTH RANGE 9 EAST/WEST

FOR M.C. CORNER INDICATE: NAME OF WATERWAY N/A SECTION LINE N/A

(CITY)(VILLAGE)(TOWN) OF: Sugar Camp COUNTY OF: Oneida

This recovery completed May 20, 1998; there were no witnesses.

Description of monument found or placed and all other evidence used as a basis for monument location; including all monuments and related measurements required if the corner location is reestablished by lost corner proportionate methods. Also indicate name of original surveyor, survey date, corner monument set and established bearing trees, witness or reference monuments with ties from available records.

Found and accepted a standard 2" aluminum pipe monument with stamped Oneida County cap 8" above existing bog/marsh surface and undisturbed at this corner location. In 1863, GLO Deputy Surveyor Daugherty did not note setting a post or marking BTs for a quarter corner on the section line; however, in 1944, Maine single proportioned a 1/4 corner on the west line of Section 27 from the SW section corner north to the West 1/4 corner of Section 22 per his Plat of Survey, L-1046, Oneida County survey records. Consequently his proportioned 1/4 corner has since been accepted by common report as a quarter corner for land surveying purposes of public record, and should therefore be perpetuated accordingly. In 1952, Ilg of Wisconsin Conservation Department found Maines corner at 35.31 chains North of the SW corner of Section 27 and 3.69 chains South of the South MC corner on Chain Lake. In 1987, a Plat of Survey by Romportl/Genisot was filed in Oneida County records as B-1560, indicating that a 1" iron pipe found at Maines 1944 corner was replaced by a standard 2" dia. by 48" long aluminum pipe monument with stamped Oneida County aluminum cap; upon recent query Genisot provided field ties to the corner monument from BTs, a 5" Spruce N02°E 21.22', now gone; a 6" Pw S83°E 21.22', now a 9" Pw found and used for new ties below; a 4" Pw N80°E 14.91', is now a 10" Pw found and used for new ties below; and a previous older BT of unnoted species S40°E 7.6', which I found as a low rotting pine stump with lower face at root crown open and plain with scribing, S40°E 7.75'. In 1991, Weber/Eagle Landmark also found and accepted the existing monument per his Plat of Survey, B-2381, filed in Oneida Co. survey records.

Plan view map of monument location with bearing and distance ties to a minimum of four(4) described witness or reference monuments of concrete, natural stone, iron, live bearing trees or equivalent material. If applicable, also show a minimum of two(2) bearing and distance ties to any other monument found and not accepted; including the bearing and distance from the accepted monument. Indicate the basis for bearings of reference ties if not referenced to magnetic north.

NORTH

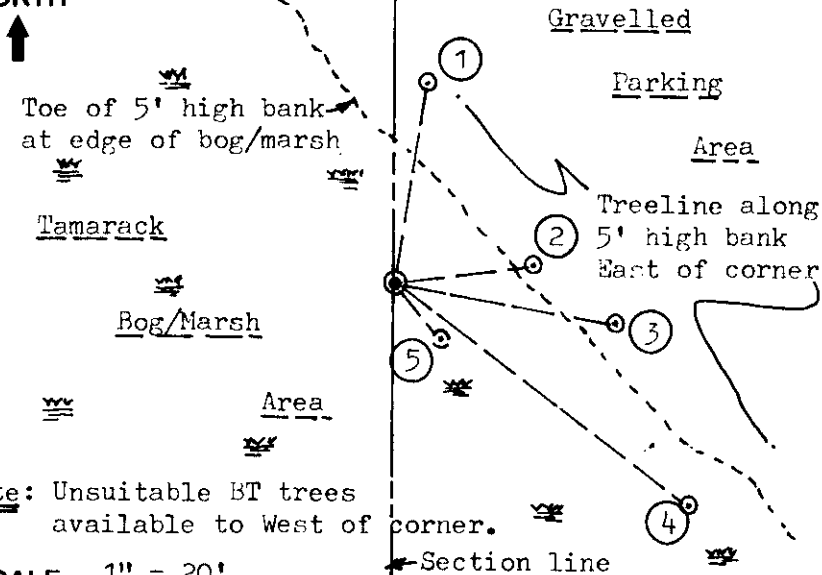

WITNESS MONUMENT TIES:

- ① New BT 5 1/2" Tamarack N09°E 21.08'
- ② Older BT 10" Pw N83°E 14.86'; 60 penny spike found overgrown in right face. BT sign on East face.
- ③ Older BT 9" Pw S80°E 23.47; 60 penny spike found overgrown in right face. BT sign on East face.
- ④ New BT 9" Tamarack S53°E 38.61'
- ⑤ Old rotted BT stump noted above.

Note: Corner is 66' South of black top roadway centerline. Standard white poly 'T' marker post set 8" West of the corner monument.

Note: Unsuitable BT trees available to West of corner.

SCALE: 1" = 20'

Unless otherwise indicated, all bearing tree ties are to a .25" dia. by 2.5" long PK nail with a 1.25" dia. steel washer driven into unblazed right face and a .25" dia. by 2.5" long PK nail with a 2" dia. steel washer stamped 'BT' is also driven into unblazed face of bearing tree at DBH; the basis for measured bearings is magnetic to nearest degree and all tie distances are horizontal measure to nearest 1/100th feet.

LAND SURVEYOR CERTIFICATION:

I, William C. Rohde, hereby certify that I am a duly licensed Professional Land Surveyor in Wisconsin, that this USPLS monument location was determined by me or under my direction and control, and that this U.S. Public Land Survey Monument Location Record is true and correct to the best of my knowledge and belief.

William C. Rohde Date: 5-21-98
Signature

	27		

SECTION LOCATION MAP

INDEX NO. T-13
3909 28 2000

INDEX NO. T-13

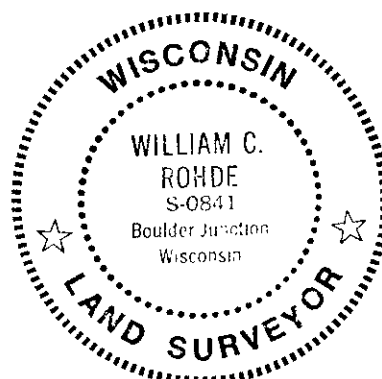

RLS SEAL

SHEET NO. 1 OF 1

This form is intended to fulfill requirements of Chapter A-E 7.08 (3)(a)(b)(c)(d)(e)(f)(g)(h)(i) U.S. Public Land Survey Monument Location Record, Wisconsin Administrative Code. Use reverse side for geodetic location data and/or continuation purposes.