

U.S. PUBLIC LAND SURVEY MONUMENT RECORD

Note: This form is intended and designed to fulfill all requirements of Wisconsin Administrative Code, Chapter A-E 7.08 U.S. Public Land Survey Monument Record (3) (a) (b) (c) (d) (e) (f) (g) (h) (i). An additional sheet may be added if necessary to conform with said requirements.

(a) Corner location: Township 38 North

Range 9 East/West

Town/City/Village SUGAR CAMP

County ONEIDA

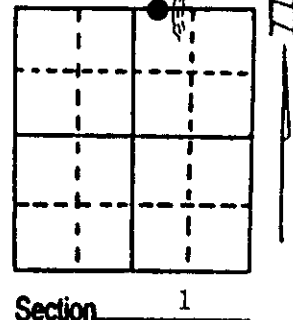

(b) (f) (g) (h) Description of monument found at this corner and if it was accepted, state all evidence (material, testimonial, occupational, plats, records, other monuments) used as a basis for accepting. If not accepted or if nothing was found, state evidence used as basis for establishing location. If reestablished through lost corner proportionate methods, indicate all monuments, distances and directions used to establish. Indicate type of monument found or set and sign post.

1859- WOOD POST SET BY DAUGHERTY.
 ORIGINAL B.T.'s 10" BIRCH N 55° W 18LKS.
 7" TAMARACK S 82° W 37LKS.

1941- MAINE FOUND AND PERPETUATED M.C. SET AT POSITION BY VAUGHN.

REPLACED WOOD HUB IN ROCK CAIRN AT M.C. POSITION WITH ONEIDA COUNTY ALUMINUM CAP MONUMENT STAMPED TO IDENTIFY CORNER.

SET PLASTIC SIGN POST 3.0 FEET NORTH OF CORNER.

(c) (d) (e) Plan view of corner with ties to at least 4 witness monuments. If in disagreement with previously established corner, show the distances between the two corners and also indicate the ties to the disputed corner.

BEARING TREE MEASUREMENTS ARE TO ALUMINUM NAIL IN SIDE OF TREE.

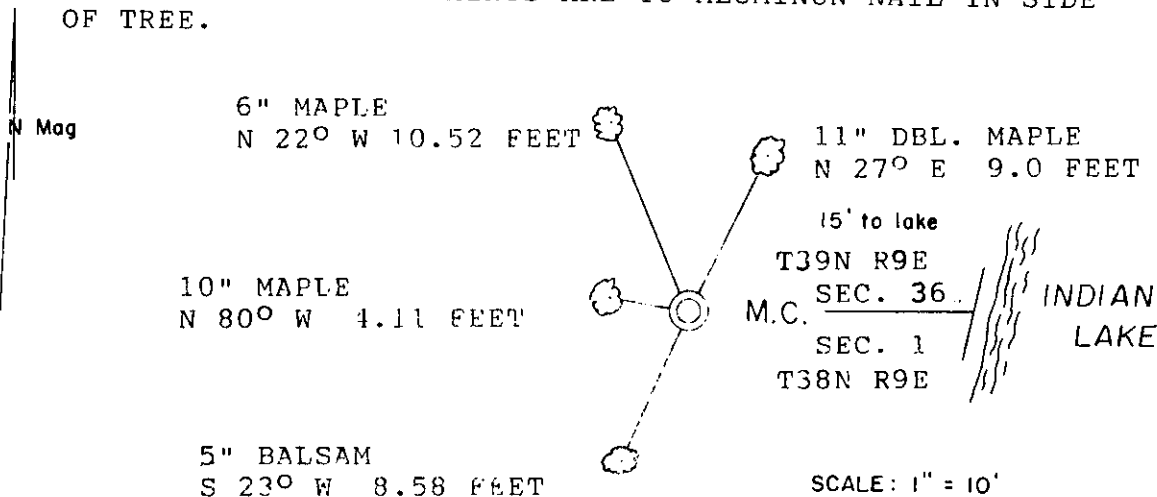

(i) I, KIP W. SODER S-1731
 (type or print name) certify that the corner location on this record was determined by me or under my direction and control and that this U.S. Public Land Survey Monument Record is correct and complete to the best of my knowledge and belief.

Kip W. Soder 5/11/98
 Signature Date



Index No. A 23-24
 38991

3909360017