

COPY from Vilas Cty.

U. S. PUBLIC LAND SURVEY MONUMENT RECORD

Note: This form is intended and designed to fulfill all requirements of Wisconsin Administrative Code, Chapter A-E 7.08 U.S. Public Land Survey Monument Record (3)(a)(b)(c)(d)(e)(f)(g)(h)(i). An additional sheet may be added if necessary to conform with said requirements.

(a) CORNER LOCATION: State Plane Coordinates
 South 1/4 corner of Sec. 15 X N/A
 Township 39 North Y N/A
 Range 10 East Datum Base None
 Town/City Lincoln County of Vilas

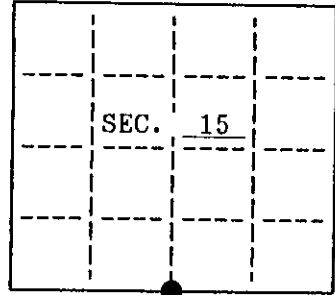

(b) HISTORY OF ORIGINAL CORNER ESTABLISHMENT
 Original Surveyor: William E. Daugherty Original B.T.'S
 Date of Survey: Commenced Sept. 30, 1863 18" Y. Pine S 66° W 20 Lks.
 15" Y. Pine N 73° E 7 Lks.
 Completed Oct. 7, 1863

(b)(f)(g)(h) Description of monument found at this corner and if it was accepted, state all evidence (material, testimonial, occupational, plats, records, other monuments) used as a basis for accepting. If not accepted or if nothing was found, state evidence used as basis for establishing location. If reestablished through lost corner proportionate methods, indicate all monuments, distances and directions used to establish. Indicate type of monument and sign post found or set.

April 1, 1994: I, Thomas A. Boettcher found a 6" x 6" concrete monument extending 1.0 feet above the ground in good condition. Blazed line rund East to a small pond and a ribboned line runs West from this corner. Found one bearing tree and possibly the two original bearing tree stumps as shown below. I cemented an Aluminum cap stamped to identify the corner into the top of said concrete monument. I made three new bearing trees as shown below and set a plastic sign post 1.0 feet Northeast of this corner.

(c)(d)(e) Plan view of corner with ties to at least 4 witness monuments. If in disagreement with previously established corner, show the distances between the two corners and also indicate the ties to the disputed.

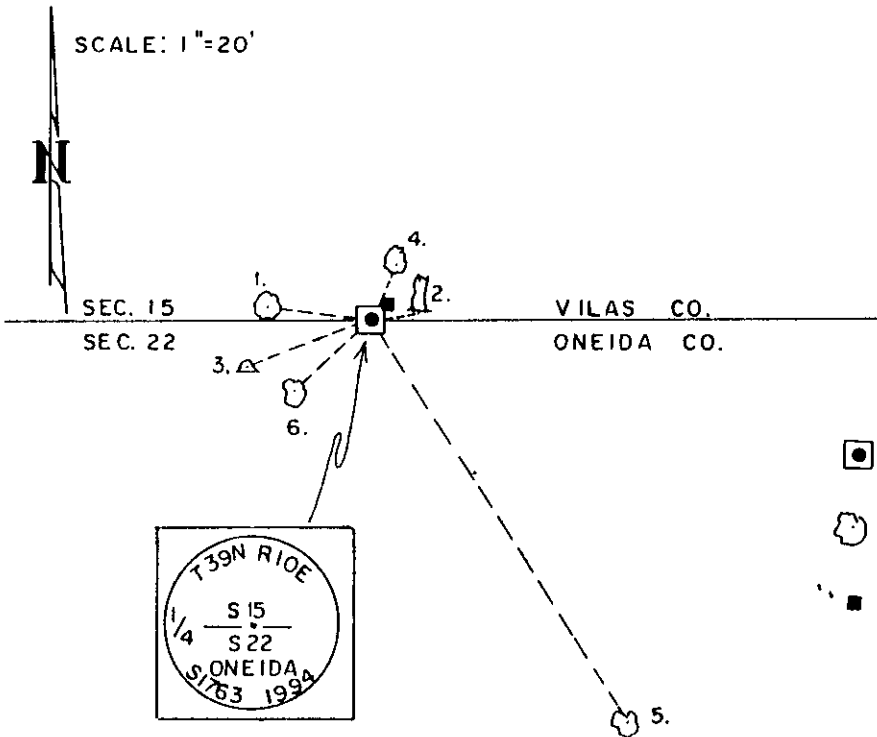

- Bearing Tree found measured to a nail in the side:
- 1) 5" W. Birch N 82° W 10.56'
- Possible Original bearing tree stumps found measured to center
- 2) 4' high pine stump with paint N 80° E 4.75'
 - 3) Old rotted pine stump S 70° W 13.5'
- Bearing trees made measured to a nail in the side:
- 4) 10" W. Birch N 23° E 6.33'
 - 5) 9" Maple S 32° E 49.73'
 - 6) 5" Maple S 48° W 10.91'

- Aluminum Cap Set in 6" x 6" concrete monument found in place
- Bearing Tree Measured to a Nail in the side
- Plastic witness sign post set

(i) I, Thomas A. Boettcher hereby certify that the corner location on this record was determined by me or under my direction and control and that this U.S. Public Land Survey Monument Record is correct and complete to the best of my knowledge and belief.

Thomas A. Boettcher Signature 4-10-94 Date

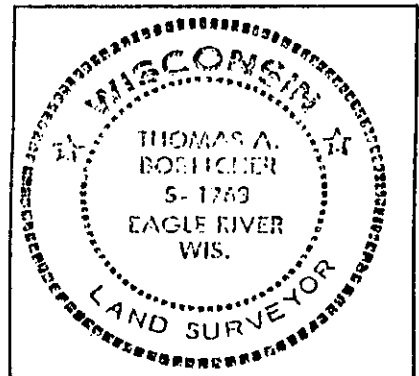

INDEX NO. N-15