

U.S. PUBLIC LAND SURVEY MONUMENT RECORD

Note: This form is intended and designed to fulfill all requirements of Wisconsin Administrative Code, Chapter A-E 7.08 U.S. Public Land Survey Monument Record (3) (a) (b) (c) (d) (e) (f) (g) (h) (i). An additional sheet may be added if necessary to conform with said requirements.

(a) Corner location: Township 39 North

Range 10 East/West

Town/City/Village Sugar Camp

County Oneida

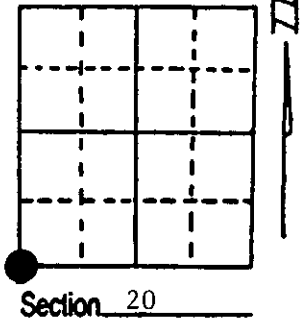

(b) (f) (g) (h) Description of monument found at this corner and if it was accepted, state all evidence (material, testimonial, occupational, plats, records, other monuments) used as a basis for accepting. If not accepted or if nothing was found, state evidence used as basis for establishing location. If reestablished through lost corner proportionate methods, indicate all monuments, distances and directions used to establish. Indicate type of monument found or set and sign post.

1863 - Wm. Daugherty established this corner at 80.00 chains, set a wood post with two BTs:

12" Sugar, S27°E, 13 Links (8.58') 16" Birch, N47°W, 9 Links (5.94')

12/12/1958 - Norm Loftus restored corner for Ripco and set 1 1/4" x 30" high iron pipe with 4" x 4" brass plate. No record of BTs available.

5/23/1995 - Milo E. Stefan found Ripco's monument, set plastic sign post and made new BTs.

(c) (d) (e) Plan view of corner with ties to at least 4 witness monuments. If in disagreement with previously established corner, show the distances between the two corners and also indicate the ties to the disputed corner.

- 1) 1 1/4" x 30" iron pipe/brass plate
- 2) 6" Black Ash, N63°E, 37.12'
- 3) 8" White Ash, S36°E, 44.95'
- 4) 4" White Ash, N89°W, 35.68'
- 5) 4" Sugar Maple, N5°W, 36.67'
- 6) Plastic Sign Post, West, 1.0'
- 7) Location Poster on 16" Basswood, SW, 3.2'

Distances to nail in side of BTs.
Stump face scribed "BT".
BT tags to face of each BT.

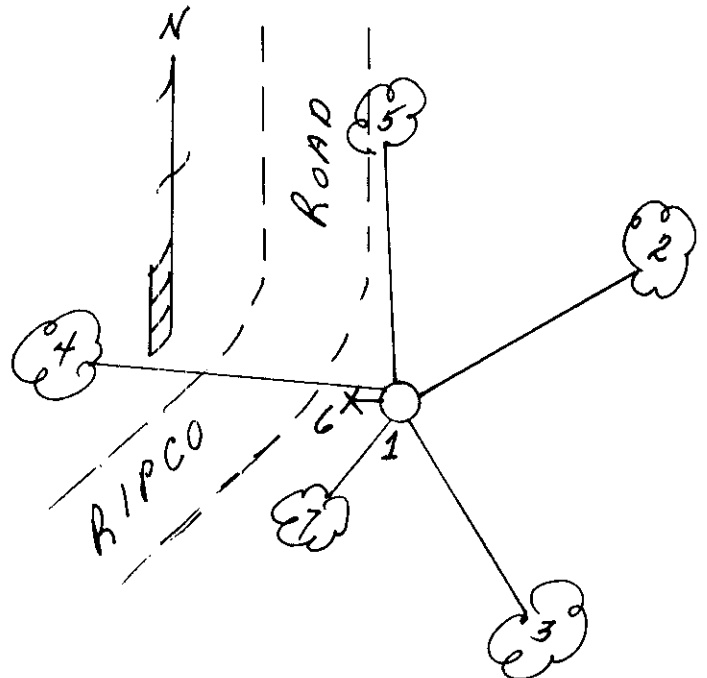

REGISTER OF DEEDS OFFICE
ONEIDA COUNTY WIS
FILED
JUL 11 1995
At _____ O'Clock _____ M
THOMAS H. LEIGHTON
REGISTER OF DEEDS

(i) I, Milo E. Stefan
(type or print name) certify that the corner location on this record was determined by me or under my direction and control and that this U.S. Public Land Survey Monument Record is correct and complete to the best of my knowledge and belief.

Milo E. Stefan
Signature

July 10, 1995
Date



Index No. R-5

3910190000

U.S. PUBLIC LAND SURVEY MONUMENT RECORD

Note: This form is intended and designed to fulfill all requirements of the Wisconsin Administrative Code, Chapter A-E 7.08 U.S. Public Land Monument Record (3)(a)(b)(c)(d)(e)(f)(g)(h)(i). An additional sheet may be added if necessary to conform with said requirements.

(a) CORNER LOCATION: Oneida County Corner I.D. No.:
 South East Section Corner 3910190000
 Township 39 North
 Range 10 East
 Town of Sugar Camp
 County of Oneida

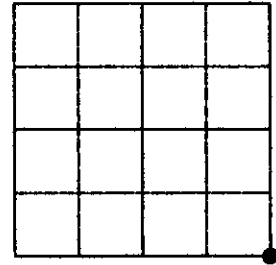

SECTION 19

(b) HISTORY OF ORIGINAL CORNER ESTABLISHMENT

| | |
|----------------------------------|--------------------------------|
| Original Surveyor: Wm. Daugherty | Original B.T.'S |
| Date of Survey: 1863 | Sugar, 12" dia., S27°E, 13 lks |
| Corner Marker Set: Wood Post | Birch, 16" dia., N47°W, 9 lks |

(f)(g)(h) DESCRIPTION OF MONUMENT FOUND AT THIS CORNER AND IF IT WAS ACCEPTED, STATE ALL EVIDENCE (MATERIAL, TESTIMONIAL, OCCUPATIONS, PLATS, RECORDS, OTHER MONUMENTS) USED AS A BASIS FOR ESTABLISHING LOCATION. IF NOT ACCEPTED OF IF NOTHING WAS FOUND, STATE EVIDENCE USED AS BASIS FOR ESTABLISHING LOCATION. IF REESTABLISHED THROUGH LOST CORNER PROPORTIONATE METHODS, INDICATE ALL MONUMENTS, DISTANCES AND DIRECTIONS USED TO ESTABLISH. INDICATE TYPE OF MONUMENT AND SIGN POST FOUND OR SET.

1863 - Original Surveyor: Wm. Daugherty, at 80.00 chains set wood post.

12/12/1958 - Norm Loftus restored corner for Ripco and set 1 1/4" x 30" high iron pipe with 4" x 4" brass plate. No record of BTs available.

5/23/1995 - Milo E. Stefan found Ripco monument, set plastic signpost and made new ties.

5/13/2010 - Anthony R. Jones found Ripco monument by Loftus and ties as set by Stefan in 1995 and re-measured ties as shown in the plan below. This mark is not in danger of road resurfacing at the time of this survey.

(c)(d)(e) PLAN VIEW OF CORNER WITH TIES TO AT LEAST 4 WITNESS MONUMENTS. IF IN DISAGREEMENT WITH PREVIOUSLY ESTABLISHED CORNER, SHOW THE DISTANCE BETWEEN THE TWO CORNERS AND ALSO INDICATE THE TIES TO THE DISPUTED CORNER.

BEARINGS BASED ON THE SOUTH LINE OF THE SE 1/4 OF SECTION 19-39-10 AND ONEIDA COUNTY GPS INFORMATION ACCEPTED AS: S88°59'53" E.

- 1: FD 1 1/4" IP WITH SQ. BRASS PLATE
- 2: 9" BLACK ASH, N 56°26'34" E, 37.12'
- 3: 11" WHITE ASH, S 45°02'11"E, 44.95'
- 4: 7" WHITE ASH, S 84°27'53" W, 35.68'
- 5: 6" SUGAR MAPLE, N 15°56'54" W, 36.67'
- 6: LOCATION POSTER SIGN ON 20" BASSWOOD, S 11°05'08" W, 3.20'

Found plastic post 1' west
 Measurement to trees taken to 8d aluminum nail in the side of tree.
 Bearing taken to center of trees.

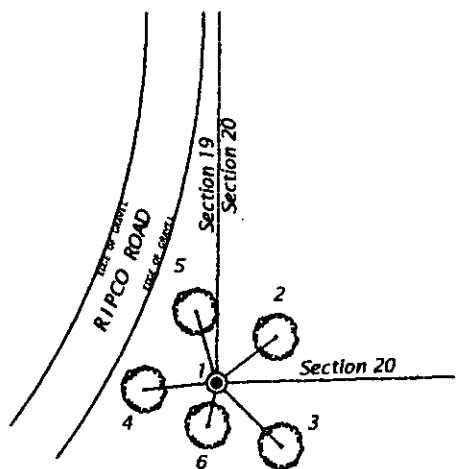
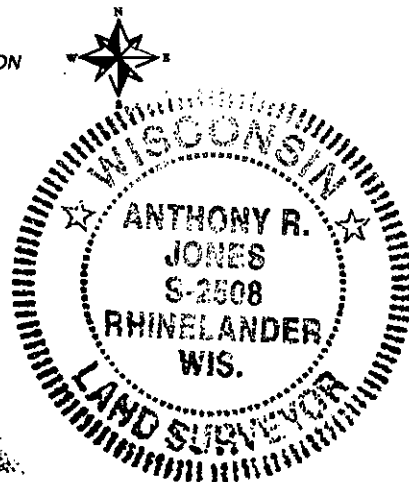

(i) I, ANTHONY R. JONES, REGISTERED LAND SURVEYOR NO. S-2508 HEREBY CERTIFY THAT THE CORNER LOCATION ON THIS RECORD WAS DETERMINED BY ME OR UNDER MY DIRECTION AND CONTROL AND THAT THIS U.S. PUBLIC LAND SURVEY MONUMENT RECORD IS CORRECT AND COMPLETE TO THE BEST OF MY KNOWLEDGE AND BELIEF.

[Signature]
 SIGNATURE _____ DATE 5/20/10

REGISTER OF DEEDS OFFICE
 ONEIDA COUNTY, WIS.

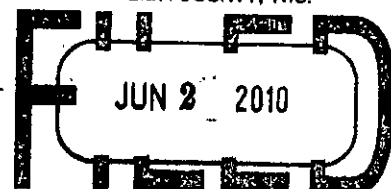

At _____ O'Clock _____ M
THOMAS H. LEIGHTON
 REGISTER OF DEEDS

1 of 2
3910190000

INDEX NO. R-5

