

This form is intended to fulfill the requirements of Chapter A-E7.08 (3)(a) thru (j) U.S. Public Land Survey Monument Location Record, Wisconsin Administrative Code. Use the reverse side of form for continuation.

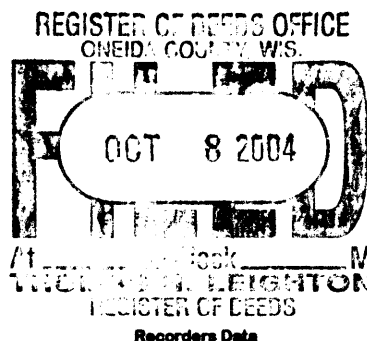

U.S. PUBLIC LAND SURVEY MONUMENT LOCATION RECORD

USPLS CORNER: NORTH 1/4 SECTION: 29 TOWNSHIP: 39 NORTH RANGE: 10 EAST
 NAME OF WATERWAY FOR M.C. CORNER : N/A SECTION LINE: N/A
 (CITY)(VILLAGE)(TOWN) OF: SUGAR CAMP COUNTY OF: ONEIDA

Description of monument found or placed and all other evidence used as the basis for monument location; including monuments and measurements required if the corner location was reestablished by lost corner proportionate methods. Also indicate name of the original surveyor, original survey date and the corner monument, bearing trees, witness or other reference monuments established, including measured bearing and distance ties, from available survey records.

Found and accepted an old 1.5" dia. iron pipe with a 3" square by 1/4" thick steel plate cap as stamped and set by Ripco in 1953/54; the pipe was very loose and tipped in an old cairn of rocks at grade, so I replumbed the iron pipe with cap 27" above grade and secured by replacing rock cairn around the monument. I could not pull out the old iron pipe, without extensive digging, due to usual soil anchor at bottom end. I also found an older 1.25" dia. by 68" long probable marker post lying flat on grade nearby, which I left flat onto rock cairn.

In October 1863, William E. Daugherty/GLO set a wood post as the original corner and noted OBTs: a 16" Cedar S38°W 5 links and a 7" Sugar N34°E 26 links; all are now obliterated.

Corner also previously located by GPS control survey per Oneida County survey records at: 323798 dE/5079463 dN.

This corner is located in a wooded area about 48' North of an East/West unimproved woods roadway.

This recovery completed August 5, 2004; there were no direct witnesses.

Plan view map of monument location with bearing and distance ties to a minimum of four(4) described witness or reference monuments of concrete, natural stone, iron, live bearing trees or equivalent material. If applicable, also show a minimum of two(2) bearing and distance ties to any other monument found and not accepted; including the bearing and distance from the accepted monument.

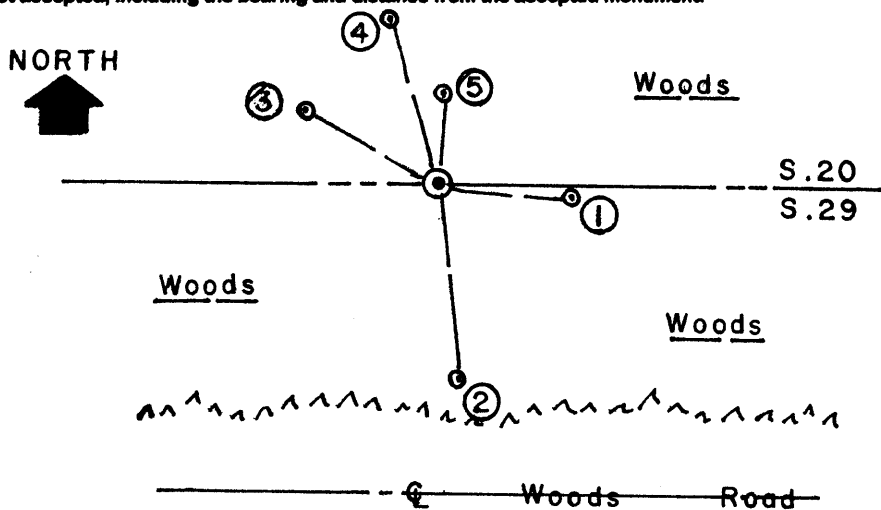

SCALE: 1" = 30'

Unless otherwise indicated, all bearing tree ties are to a .25" dia. by 2.5" long PK nail with a 1.25" dia. steel washer driven into unblazed right face and a .25" dia. by 2.5" long PK nail with a 2" dia. steel washer stamped BT is also driven into unblazed face of bearing tree at DBH; the basis for measured bearings is by compass to nearest degree and all tie distances are measured horizontal by steel tape corrected to nearest 1/100th feet at standard temperature of 68° F.

WITNESS MONUMENT TIES:

- ① New 4" Aspen BT S85°E 20.70'.
- ② New 6.5" Aspen BT S07°E 30.49' on North edge of woods roadway clearing; I nailed an older WCD section location tag on South face to aid future recovery.
- ③ New 7" Fir BT N60°W 23.46'.
- ④ New 9" Fir BT N17°W 27.62'.
- ⑤ New 6" Fir BT N02°E 14.52'.

I found a standard white poly 'T' marker post 10" East of corner monument. I flagged all blaze orange.

RLS SEAL:



LAND SURVEYOR CERTIFICATE:

I, William C. Rohde, hereby certify that I am duly licensed as a Professional Land Surveyor in the State of Wisconsin; that this USPLS monument location was determined by me and/or under my direct supervision and control; and that this U.S. Public Land Survey Monument Location Record is true and correct to the best of my knowledge and belief.

Signed: *William C. Rohde*
 William C. Rohde RLS 841

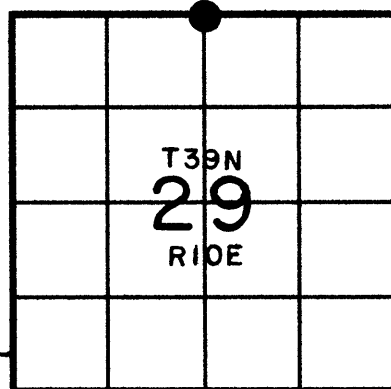

SECTION LOCATION MAP
 INDEX NO. R 7

Date Signed: September 4, 2004

3916200020