

# U.S. PUBLIC LAND SURVEY MONUMENT RECORD

REGISTERED PROFESSIONAL LAND SURVEYOR  
ONEIDA COUNTY, WISCONSIN

Note: This form is intended and designed to fulfill all requirements of the Wisconsin Administrative Code, Chapter A-E 7.08 U.S. Public Land Monument Record (3)(a)(b)(c)(d)(e)(f)(g)(h)(i). An additional sheet may be added if necessary to conform with said requirements.

MAY 25 2017

(a) CORNER LOCATION:  
East Quarter Corner of Section 22  
Township 39 North  
Range 10 East  
Town of Three Lakes  
County of Oneida

WISCRS - Oneida County  
North: 243305.816 USft  
East: 313927.128 USft  
Latitude: 45° 51' 10.21433" N  
Longitude: 89° 12' 54.37795" W  
Datum: NAD 83(2011)  
GNSS Method: RTK - Offset  
GNSS Control: WISCORS VRS  
Record North: 243305.923 USft  
Record East: 313927.098 USft  
GNSS Method: NAD 83(1991)

AT \_\_\_\_\_ O'CLOCK \_\_\_\_\_ M  
KYLE J. FRANSON  
REGISTER OF DEEDS

(RECORDING AREA)

SECTION 22

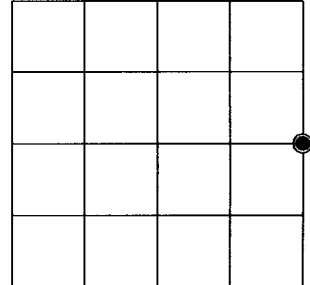

(b) HISTORY OF ORIGINAL CORNER ESTABLISHMENT

Original Surveyor: William E. Dougherty  
Date of Survey: Commenced September 30th, 1863  
Completed October 7th, 1863  
Original B.T.'S: Yellow Pine 10" N 37°W 16 lks.  
Birch 8" S 73°E 14 lks.

(f)(g)(h) DESCRIPTION OF MONUMENT FOUND AT THIS CORNER AND IF IT WAS ACCEPTED, STATE ALL EVIDENCE (MATERIAL, TESTIMONIAL, OCCUPATIONAL, PLATS, RECORDS, OTHER MONUMENTS) USED AS A BASIS FOR ESTABLISHING LOCATION. IF NOT ACCEPTED OR IF NOTHING WAS FOUND, STATE EVIDENCE USED AS BASIS FOR ESTABLISHING LOCATION. IF REESTABLISHED THROUGH LOST CORNER PROPORTIONATE METHODS, INDICATE ALL MONUMENTS, DISTANCES AND DIRECTIONS USED TO ESTABLISH. INDICATE TYPE OF MONUMENT AND SIGN POST FOUND OR SET.

January 3, 1955 - RIPCO, Loftus, Alexander & Mescher, RIPCO Book 1, page 98, set 1/4 corner by single proportionate measurement 40.885 chains (2698.41 feet) each half, which is also shown on RIPCO map for Section 22, filed as A420 in the county surveyor's office.

December 11, 2006 - Jeffery D. Anderson, RLS No. 2697, Favorite, Anderson & Maines Surveying, Inc., Map No. 2006068GPS, filed as L2312 in the county surveyor's office, provides a GPS Summary for this corner position relative to the opposing section corners.

March 3, 2017 - James D. Rein, PLS No. 1234, we recovered the RIPCO brass capped iron pipe, which I accept as faithful re-establishment of the lost quarter corner, by single proportionate measurement, and made reference ties to new bearing trees as shown in plan.

The coordinate value shown has been verified by at least one of the following methods: 1) comparison to a previously GPS determined published value; 2) the value is the average of two or more GPS observations at a markedly different time; 3) one or more distances were measured back to the GPS observed corner from temporary GPS observed offset locations.

(c)(d)(e) PLAN VIEW OF CORNER WITH TIES TO AT LEAST 4 WITNESS MONUMENTS. IF IN DISAGREEMENT WITH PREVIOUSLY ESTABLISHED CORNER, SHOW THE DISTANCE BETWEEN THE TWO CORNERS AND ALSO INDICATE THE TIES TO THE DISPUTED CORNER.

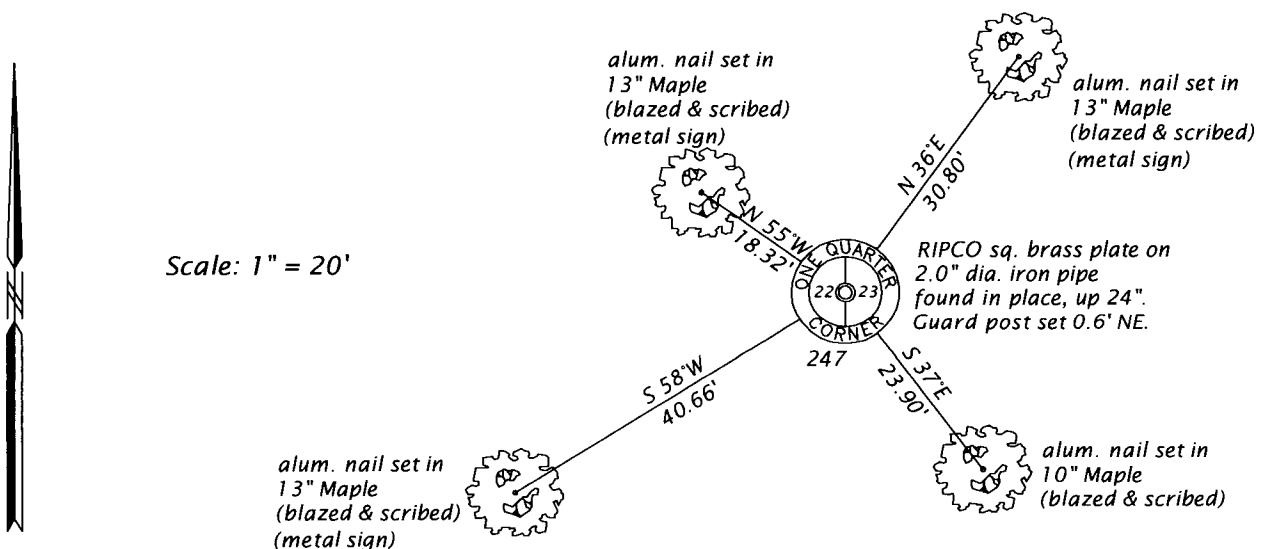

(i) I, JAMES D. REIN, PROFESSIONAL LAND SURVEYOR NO. S-1234 HEREBY CERTIFY THAT THE CORNER LOCATION ON THIS RECORD WAS DETERMINED BY ME OR UNDER MY DIRECTION AND CONTROL AND THAT THIS U.S. PUBLIC LAND SURVEY MONUMENT RECORD IS CORRECT AND COMPLETE TO THE BEST OF MY KNOWLEDGE AND BELIEF.

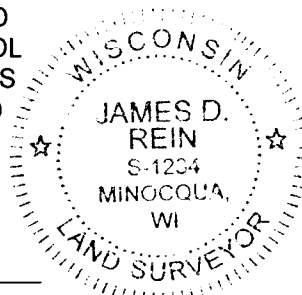

*[Handwritten Signature]*  
SIGNATURE

5-12-17  
DATE

INDEX NO. P-17  
3910222000